



**CENTRAL  
LIBRARY  
FACULTY OF SCIENCE**

# WHERE IS IT?

- 267/2 Kotlářská St.
- Veverčí district
- 611 37 Brno
- Building 12
- City centre – 15 mins by foot



# HOW DO I GET THERE?

- „Konečného náměstí“ stop
- TRAM **3, 11, 12**
- BUS **25, 26**
- NIGHT BUS **N92, N93, N99**
  
- „Sušilova“ stop
- Bus **32, 34, 36**





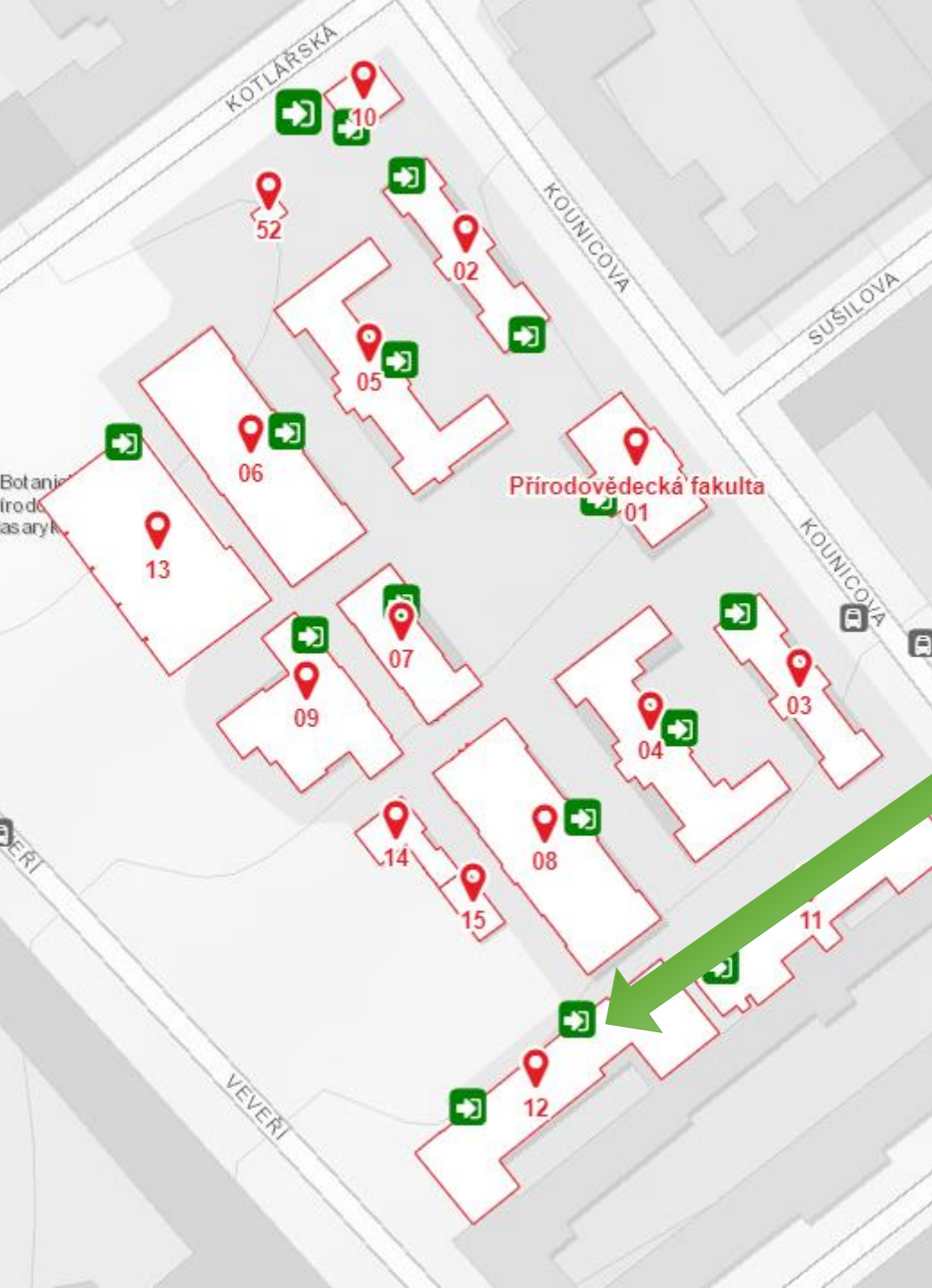

# BUILDING 12

two entrances

→ Central Library

→ Assembly Hall



# OPENING HOURS

- Mon 8 – 18
- Tue 8 – 18
- Wed 8 – 18
- Thu 8 – 18
- Fri 8 – 15
- Sat, Sun CLOSED

When  
we're  
closed...





<http://knihovna.sci.muni.cz>

**Registration:** ground floor desk

**Agreement on MU Library Services Policy:**

<https://inet.muni.cz/app/knihovny/prihlaska>



WHAT DO WE  
OFFER?



# PROFESSIONAL RESOURCES

---

- Books
  - Professional journals
  - Popular science journals
  - Electronic information resources
  - Up-to-date information
- 
- Visit **<https://katalog.muni.cz>**



# PROFESSIONAL RESOURCES

---

- Loan types:
  - **Library Use Only** – **red** mark
  - **Regular Loan** – no mark, one month
  - **Long-term loan** – **green** mark, three months
- Visit <https://katalog.muni.cz>

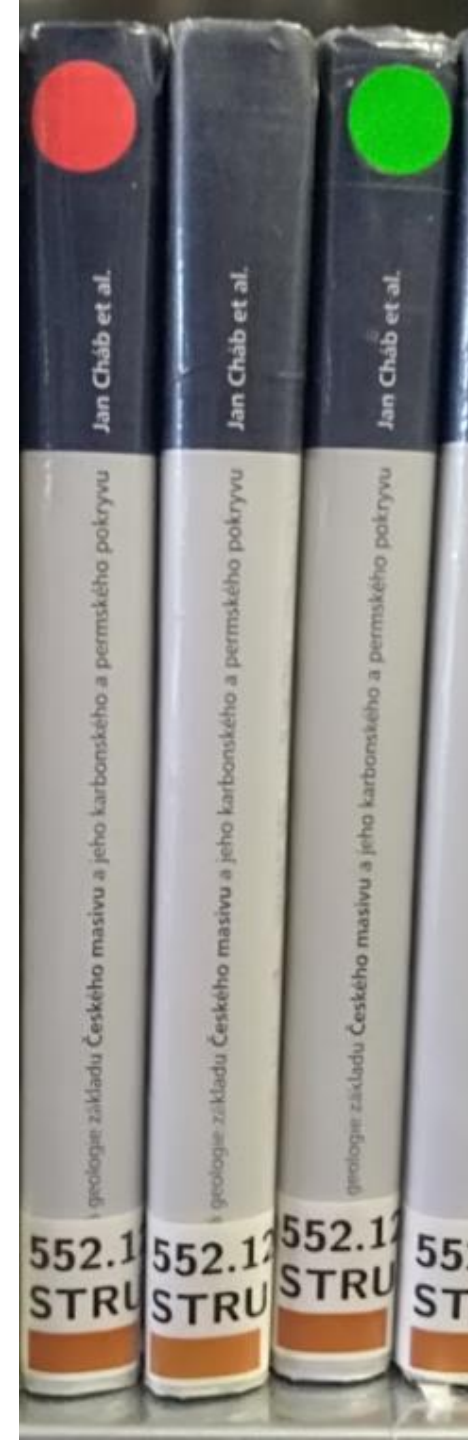

# ELECTRONIC INFORMATION RESOURCES

---

<http://ezdroje.muni.cz>

- Professional licensed resources for science, research and education
- **Free** access exclusively for MU students and staff





# INTER-LIBRARY SERVICES

---

[mvs@sci.muni.cz](mailto:mvs@sci.muni.cz)

- For documents not contained in the library collections (books, articles, serials)
- Works internationally



# MODERN TECHNOLOGIES

- OS Windows
- High-speed internet
- Printers
- Scanners
- Copy machines
- Self-check machine
- Software:  
<https://it.muni.cz/prehledy/software-ve-studovnach>
- More info:  
<https://it.muni.cz/en/services>





Fast, easy,  
self-service...





# STUDY ROOMS

- Ideal for team work
- Projector
- White board
- Flipchart



# KITCHENETTE

- Dishes
- Microwave oven
- Kettle
- Cutlery





# FOR IN-HOUSE USE WE ALSO LEND:

- Stationery (white board markers, calculators...)
- Headphones
- Rechargers
- Tablets
- Board games, card games





# EDUCATION

- E-learning course  
„Informační výchova“  
(in Czech only)
- Practical course  
„Multimedia ve výuce“  
(in Czech only)
- Webinars
- Seminars





# Information literacy

## Informace pro vědeckou práci

- Free on-line seminars
- Weekly
- Led by professionals

<http://knihovna.sci.muni.cz/edu/akce>





- **Pokročilé řešeršní strategie** (Advanced research strategies)
- **EIZ vs. Google** (Electronic information resources vs. Google)
- **Kreativní a kritické myšlení ve vědě** (Creative and critical thinking in science)
- **Open access, repozitáře a creative commons** (Open access, repositories and creative commons)
- **Normy a patenty** (Standards and patents)
- **Vykazování publikační činnosti (RIV)** (Publication reporting)
- **Citační databáze a citační analýza** (Citation databases and citation analyses)
- **Sociální sítě pro vědce** (Social websites for scientists)
- **Jak na kvalitní konferenční příspěvek** (HOW TO: High-quality conference)
- **Grafika konferenčního posteru** (Conference poster graphics)
- **Pedagogické minimum pro učící doktorandy** (Basic teaching skills for PhD students)
- **Predátorské časopisy** (Predatory journals)

Register here: <https://muni.cz/go/02c909>



# RETRIEVAL TOOLS

- <http://katalog.muni.cz> – MU catalogue
- <http://ezdroje.muni.cz> – licensed electronic resources
- <https://vufind.mzk.cz/> – Moravian Library catalogue
- <https://aleph.nkp.cz/> – Union catalogue of the Czech Republic

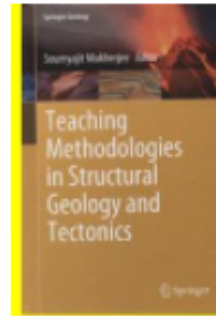

## [Teaching methodologies in structural geology and tectonics /](#)

Vydáno 2019

**Témata:** ' "...structural geology educational aspects..."

**Umístění:**

✓ [Přírodovědecká fakulta](#)

**Kniha** **Dostupné**

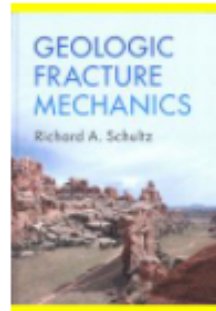

## [Geologic fracture mechanics /](#)

Autor [Schultz, Richard A.](#)

Vydáno 2019

**Umístění:**

✓ [Přírodovědecká fakulta](#)

**Kniha** **Dostupné**

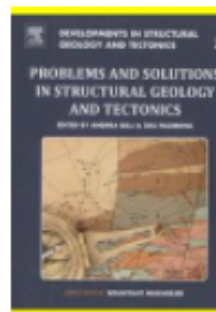

## [Problems and solutions in structural geology and tectonics /](#)

Vydáno 2019

**Témata:** ' "...structural geology..."

**Umístění:**

✓ [Přírodovědecká fakulta](#)

**Kniha** **Dostupné**



GET IN  
TOUCH!

Electronic Information Resources

**Mgr. Marie Šípková, DiS.**

[sipkova@sci.muni.cz](mailto:sipkova@sci.muni.cz)

Interlibrary services

**Bc. Nad'a Trenčanská**

[nadatre@sci.muni.cz](mailto:nadatre@sci.muni.cz)

[pujcovnauk@sci.muni.cz](mailto:pujcovnauk@sci.muni.cz)

[knihovna@sci.muni.cz](mailto:knihovna@sci.muni.cz)



**F O L L O W   U S !**



**[facebook.com/ukprif](https://facebook.com/ukprif)**





**FOLLOW US!**

**[instagram.com/knihovna\\_scimuni](https://www.instagram.com/knihovna_scimuni)**



Looking forward to seeing you in the Central Library!