

Na přelomu Quattrocenta a Cinquecenta

Jednota z mnohosti







Praha, Hrad, vstupní portál na tzv. jízdecké schodiště; do r. 1502



8. Praha, kostel sv. Jiří, jižní portál; z doby kolem r. 1520

Krakov, Wawel, královský palác, 1507-1536





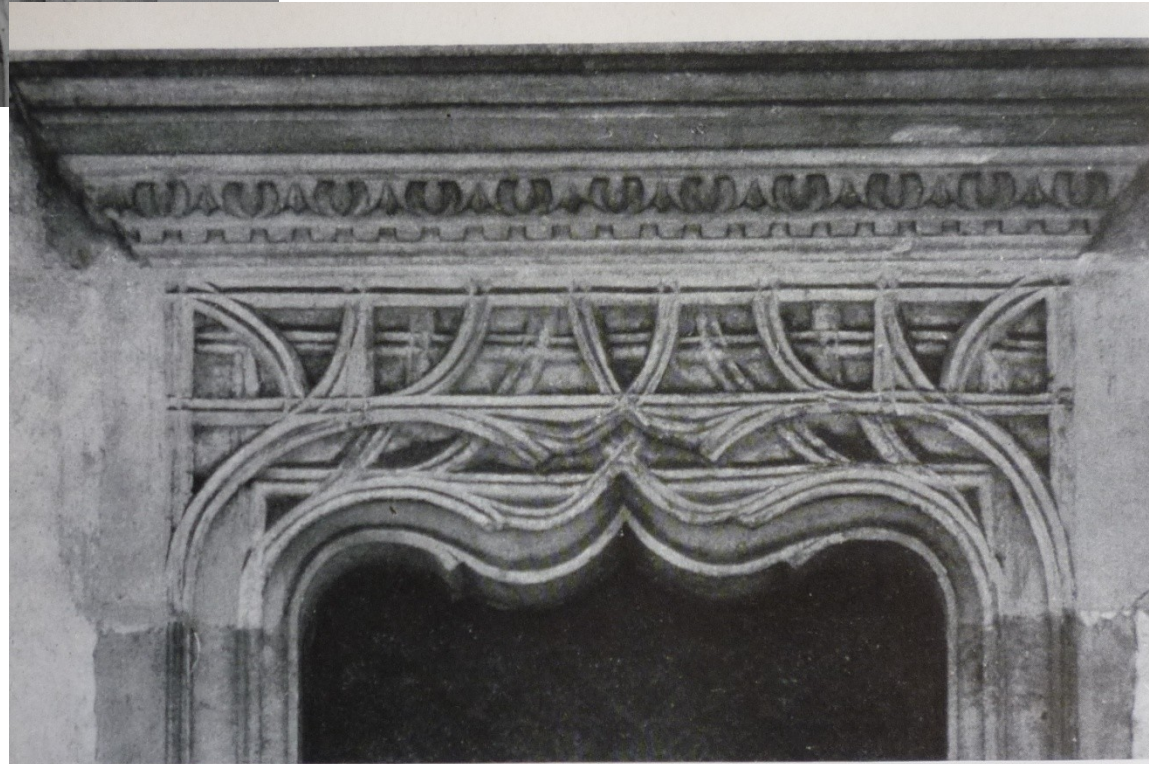

60 'Wawel-type' portal, earlier group, 1507-16. Cracow, Wawel Castle

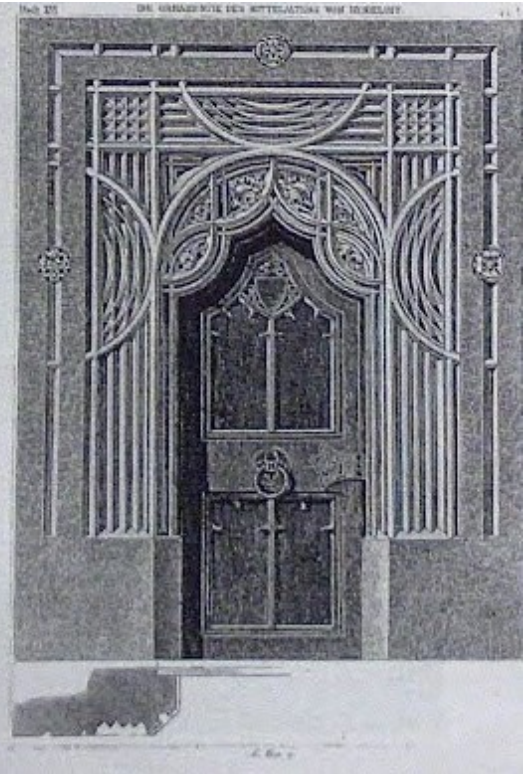
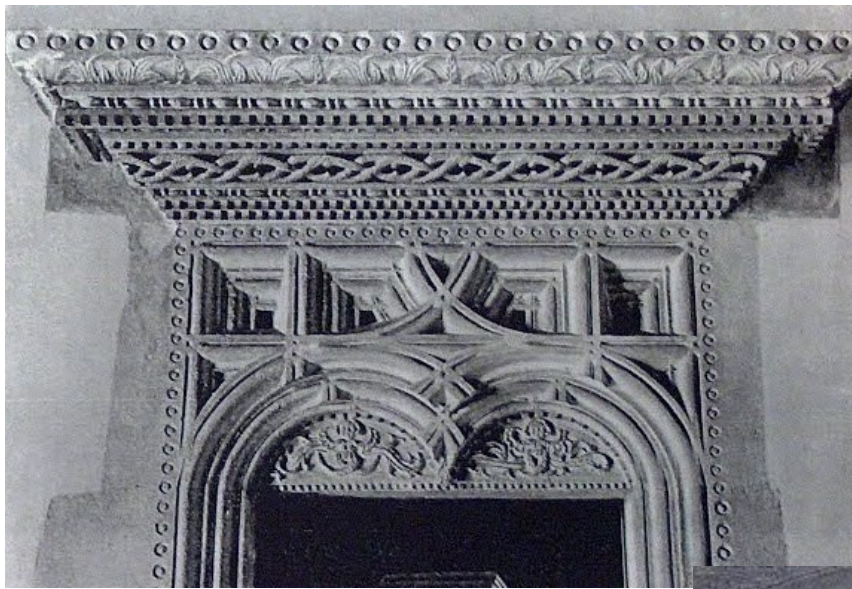





Pardubice, sv. Bartoloměj,
portál, 1519



Krakov, Wawel, Zikmundova kapele, Bartolomeo Berecci,
1517-1533



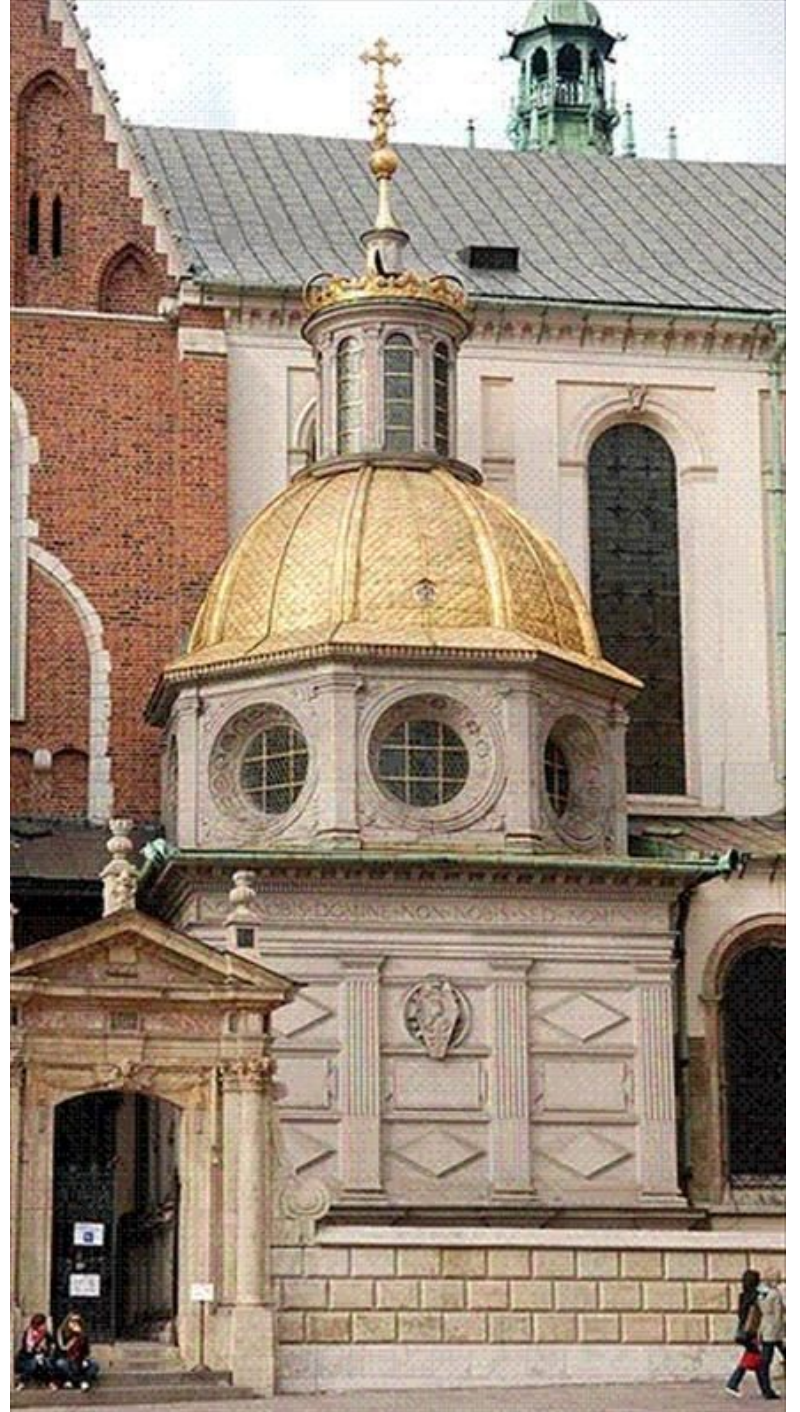

Alvise Lamberti, chrám Archanděla Michaela, Kreml, po 1504



3 Alevis Novyi (Alvise Lamberti da Montagnana?): Cathedral of St Michael the Archangel, after 1504. Moscow, Kremlin

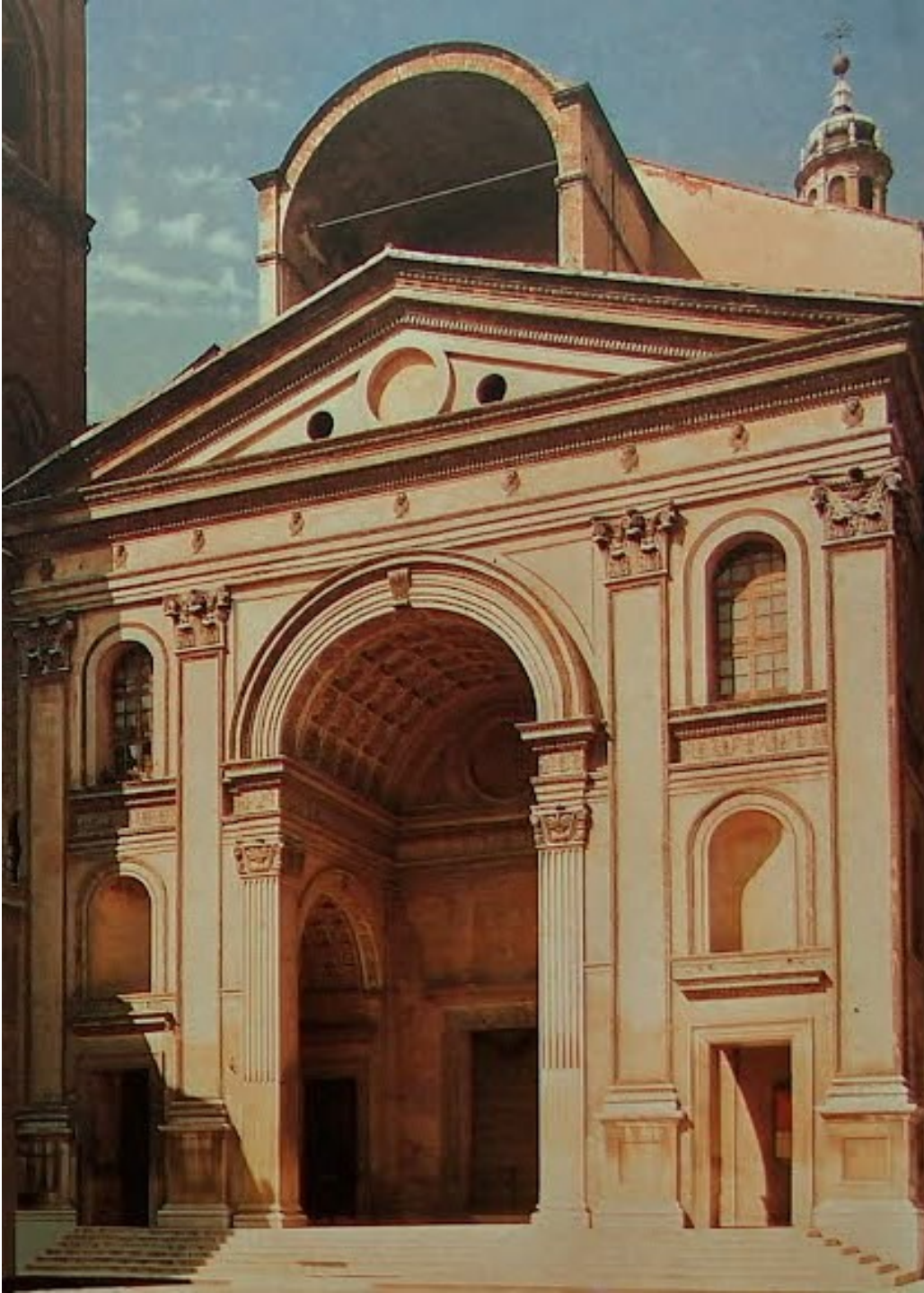

Mantova,
S. Andrea,
od 1470
(L. B. Alberti)

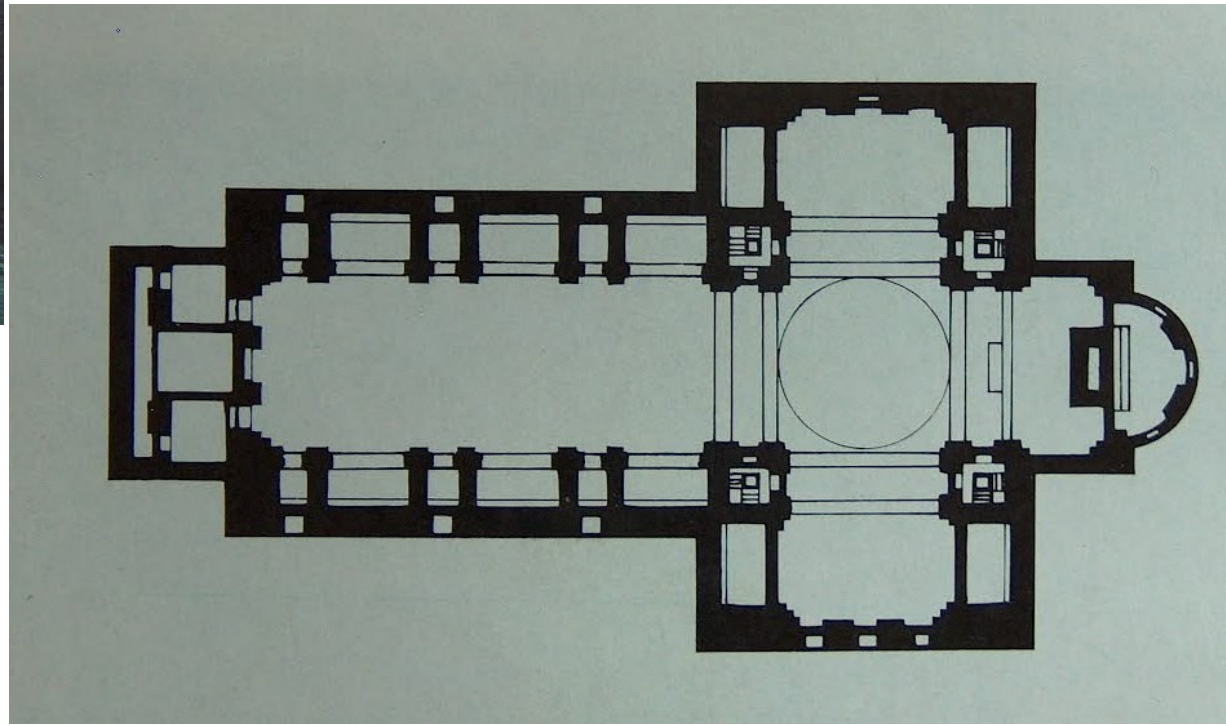

S. Pietro in Montorio,
1480–1500
(Baccio Pontelli)

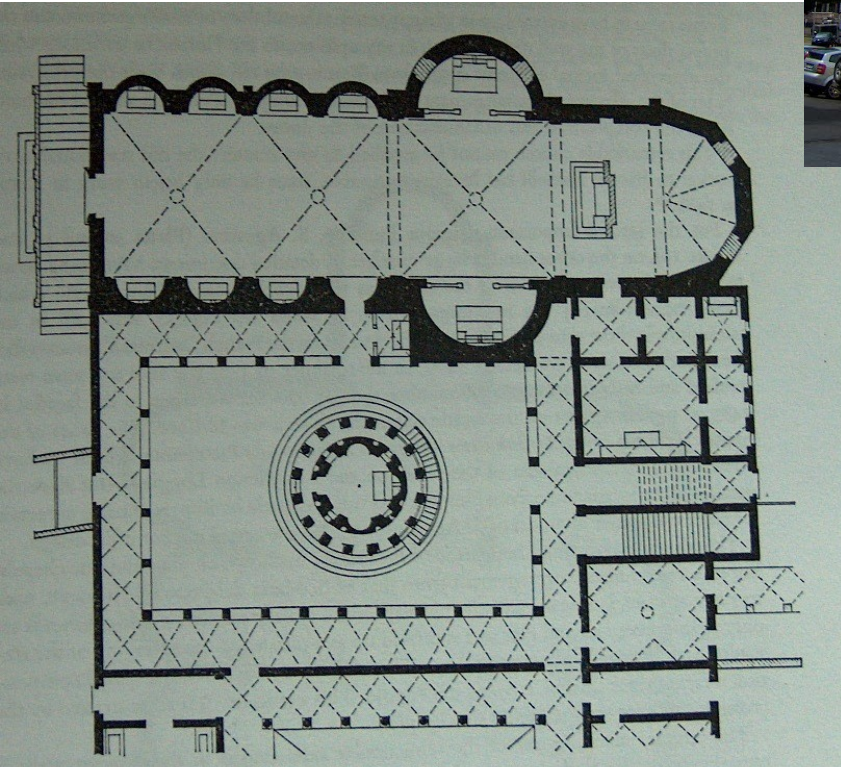

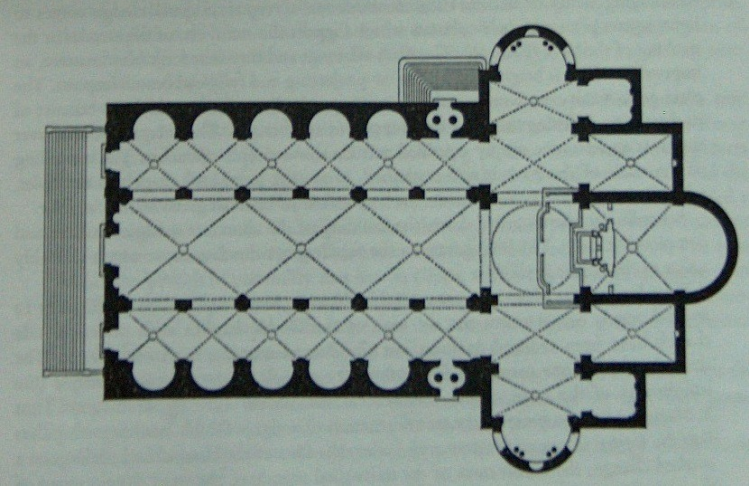

S. Agostino, 1479-1483



S. Maria dei Miracoli,
1481-1489:
Pietro Lombardo (1435-1515)

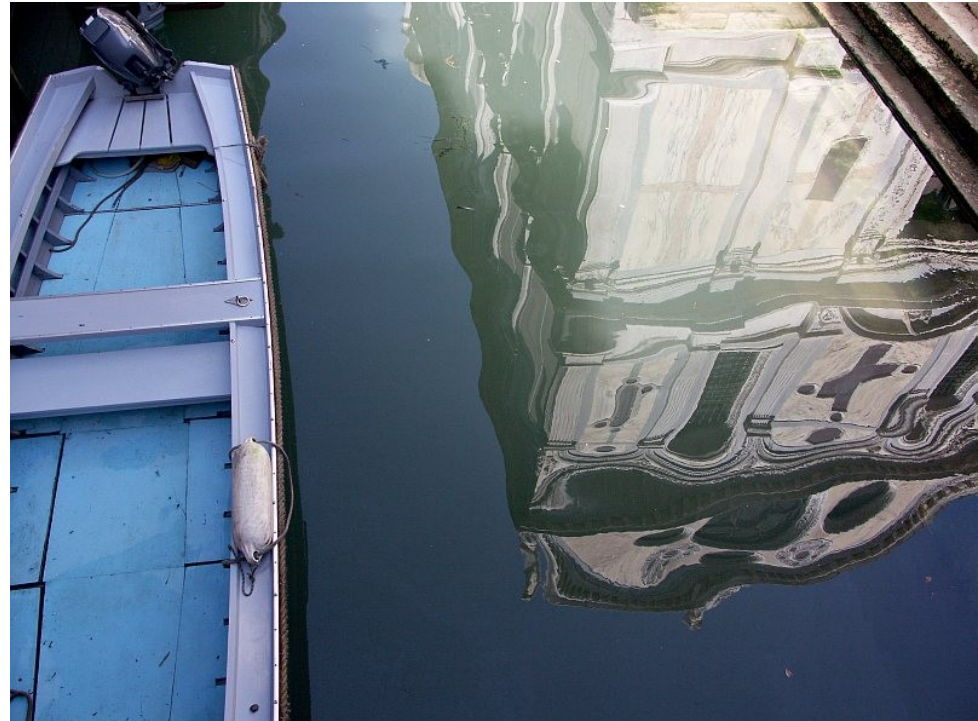



S. Zaccaria, kol. 1458-1489
(fundace abatyše Luccie
Dony): Antonio di Marco
Gambello; 1480-1500
(Mauro Codussi)



Ferrara, S. Francesco,
1494: Biagio Rossetti



Pavia, katedrála před 1490

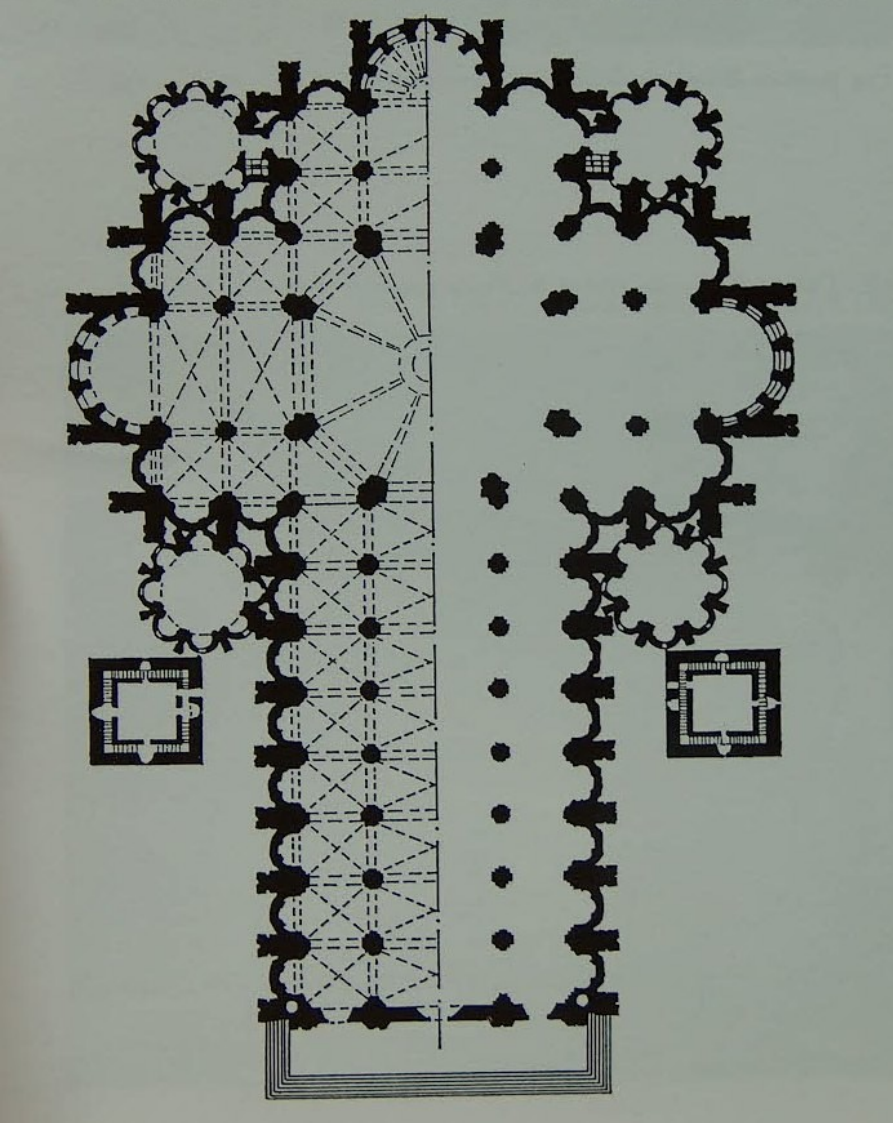



Florence,
Palazzo
Rucellai,
po 1455-1470



Milán, Castello Sforzesco:
zahájil Galeazzo II.
Visconti (1320-1378),
obnova za Francesca
Sforzy od 50. let 15. století





Cancelleria (kardinál Raffael Riario), od cca 1485

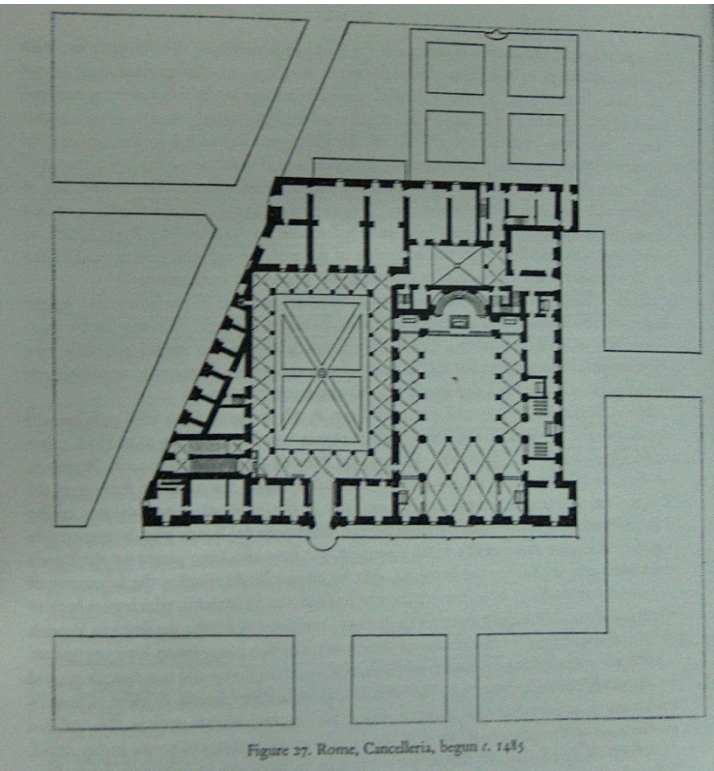



Michelozzo di
Bartolomeo, Palazzo
Medici-Riccardi, po
1444



Urbino: Palazzo Ducale



Figure 28. Urbino, plan

- | | |
|------------------------|------------------|
| 1 Palazzo del Conte | A Palazzo Ducale |
| 2-4 Medieval buildings | B La Data |
| 5 Old Castellare | C Il Mercantile |
| 6 Cathedral | |
| 7 S. Domenico | |
| 8 Ospedale S. Chiara | |



Lucino Laurano, Urbino, nádvoří, kolem 1470, atika z 16. století



Mantova, Palazzo Ducale, Nova Domus, Luca Fancelli, 1480



Ferrara, Palazzo dei Diamanti, 1504





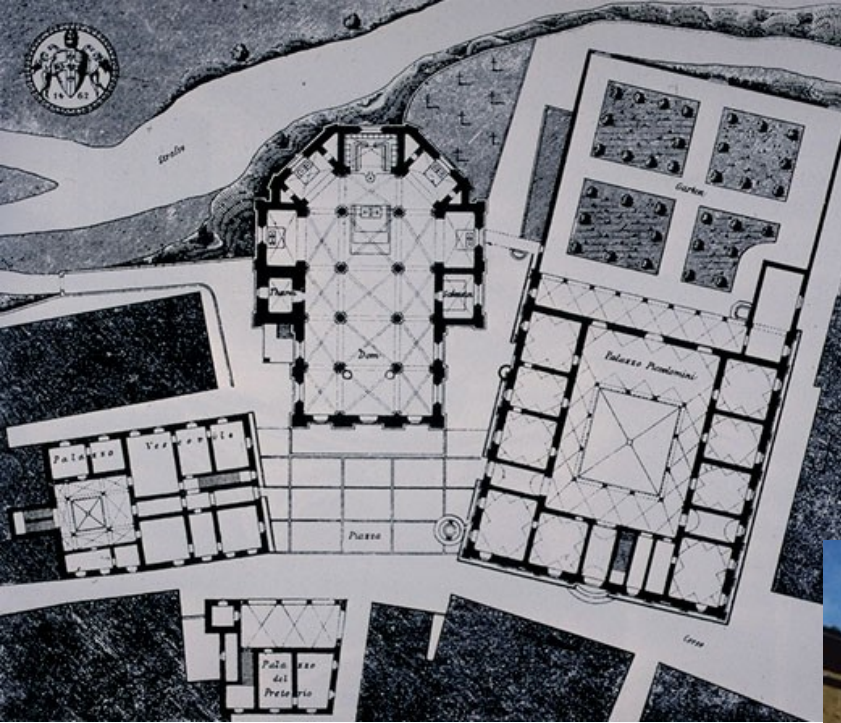

Palazzo Comunale (P. del Pretorio)



PIANTA DI FERRARA

NELLO STATO
1807

INDICE

1	2	3	4	5	6	7	8	9	10	11	12	13	14	15	16	17	18	19	20	21	22	23	24	25	26	27	28	29	30	31	32	33	34	35	36	37	38	39	40	41	42	43	44	45	46	47	48	49	50	51	52	53	54	55	56	57	58	59	60	61	62	63	64	65	66	67	68	69	70	71	72	73	74	75	76	77	78	79	80	81	82	83	84	85	86	87	88	89	90	91	92	93	94	95	96	97	98	99	100
---	---	---	---	---	---	---	---	---	----	----	----	----	----	----	----	----	----	----	----	----	----	----	----	----	----	----	----	----	----	----	----	----	----	----	----	----	----	----	----	----	----	----	----	----	----	----	----	----	----	----	----	----	----	----	----	----	----	----	----	----	----	----	----	----	----	----	----	----	----	----	----	----	----	----	----	----	----	----	----	----	----	----	----	----	----	----	----	----	----	----	----	----	----	----	----	----	----	----	-----

- A *Pal. vescovile al n. 10*
- B *Chiesa di S. Maria in V. S. S.*
- C *Chiesa di S. Maria in V. S. S.*
- D *Chiesa di S. Maria in V. S. S.*
- Spazio vacante di un'abitazione*

INDICE

1	2	3	4	5	6	7	8	9	10	11	12	13	14	15	16	17	18	19	20	21	22	23	24	25	26	27	28	29	30	31	32	33	34	35	36	37	38	39	40	41	42	43	44	45	46	47	48	49	50	51	52	53	54	55	56	57	58	59	60	61	62	63	64	65	66	67	68	69	70	71	72	73	74	75	76	77	78	79	80	81	82	83	84	85	86	87	88	89	90	91	92	93	94	95	96	97	98	99	100
---	---	---	---	---	---	---	---	---	----	----	----	----	----	----	----	----	----	----	----	----	----	----	----	----	----	----	----	----	----	----	----	----	----	----	----	----	----	----	----	----	----	----	----	----	----	----	----	----	----	----	----	----	----	----	----	----	----	----	----	----	----	----	----	----	----	----	----	----	----	----	----	----	----	----	----	----	----	----	----	----	----	----	----	----	----	----	----	----	----	----	----	----	----	----	----	----	----	----	-----

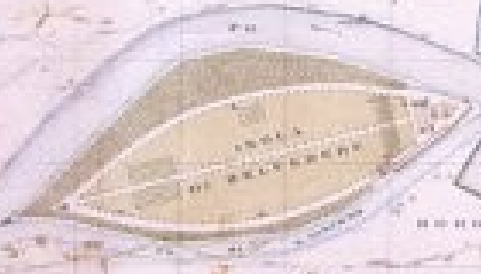

DELL' UNIVERSITA' FERRARESE
CIVIL PIANO BORGATTI

CON MAREMMA DEL REGNO

Florence, Santissima Annunziata, od 1444

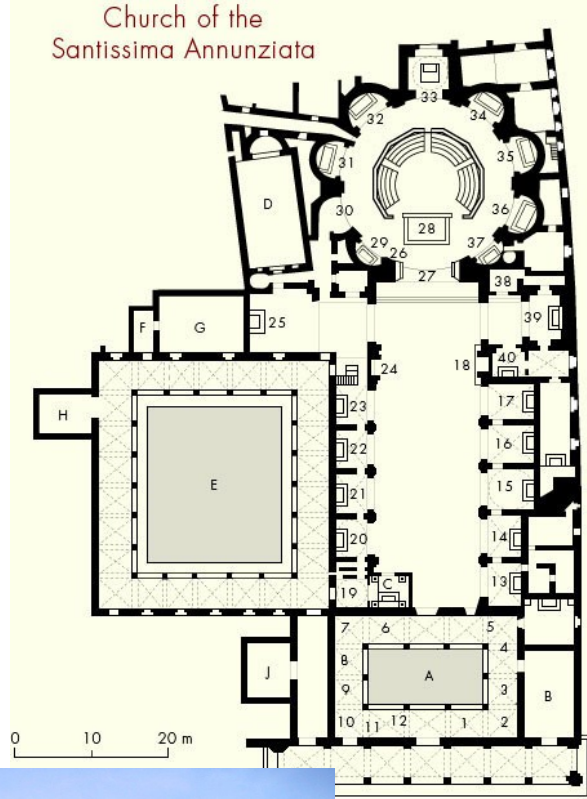

Chrám Minervy Medica v Římě, 4. století



Mantova, S. Sebastiano, od 1460
votivní kostel Ludovica Gonzagy

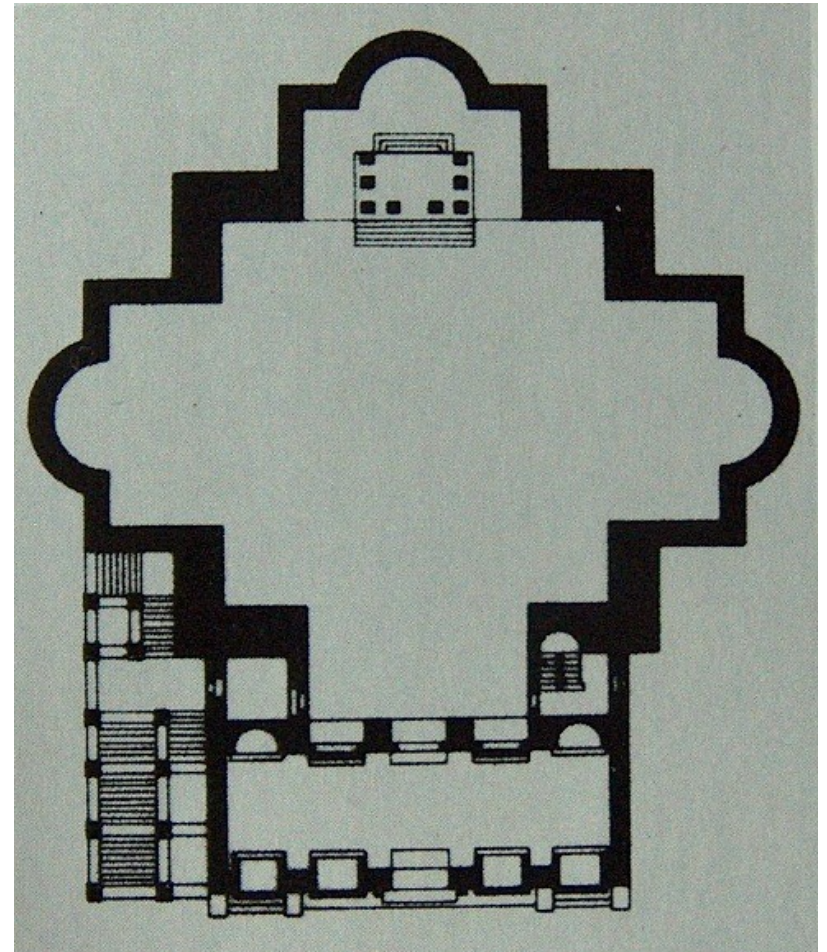

S. Francesco v Rimini, po 1450



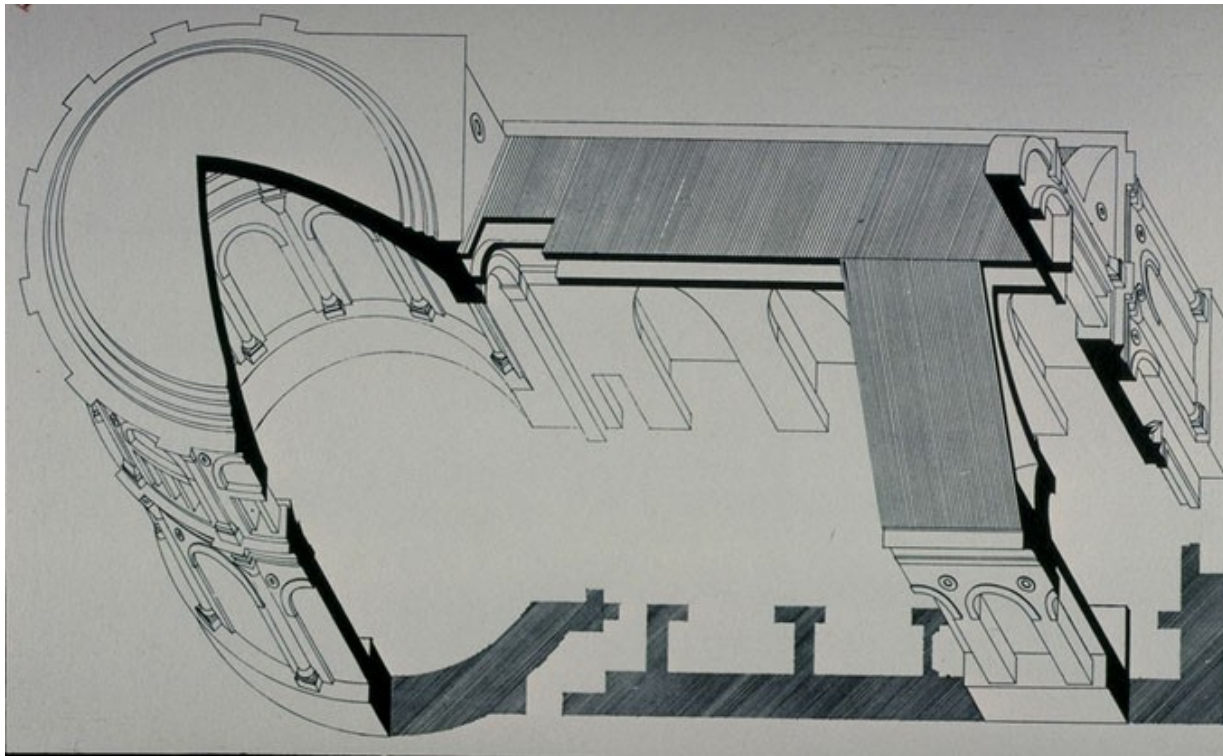
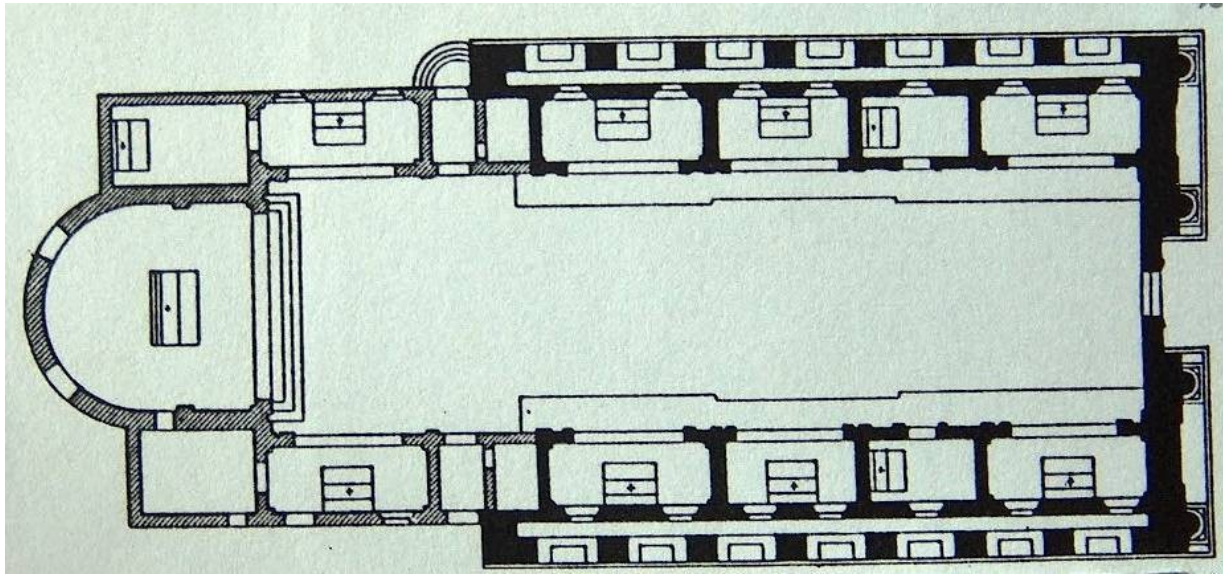

Donato Bramante (1443/4–1514)

nar. v Urbinu, v Miláně činný cca od 1480

Milán, S. Maria presso
S. Satiro, 1478- 1482

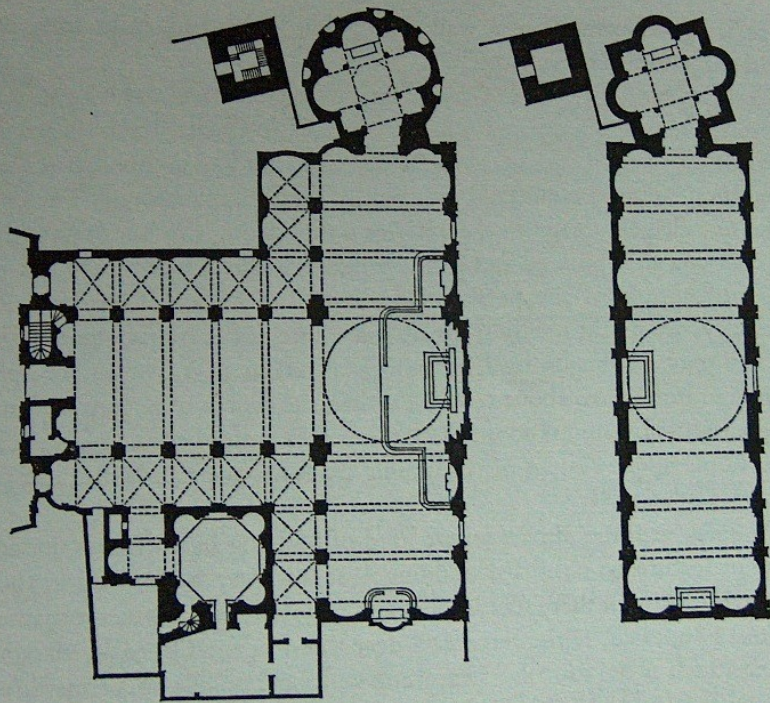
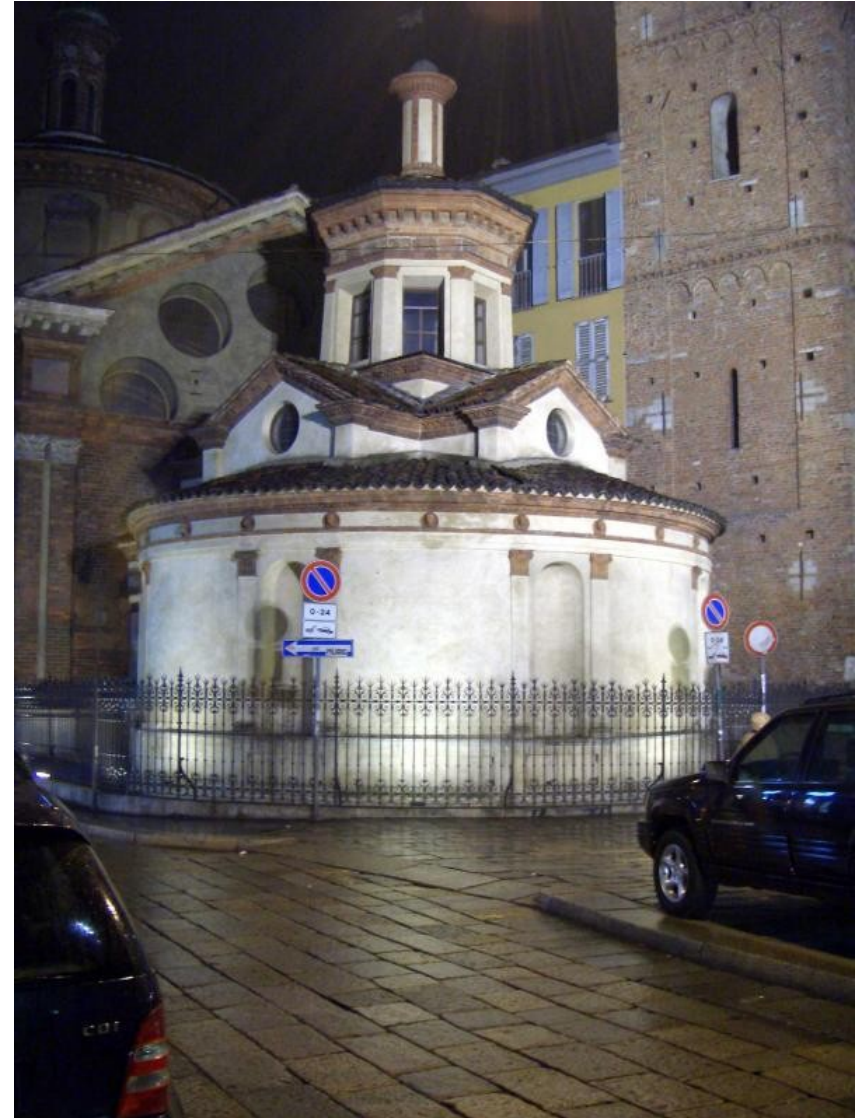
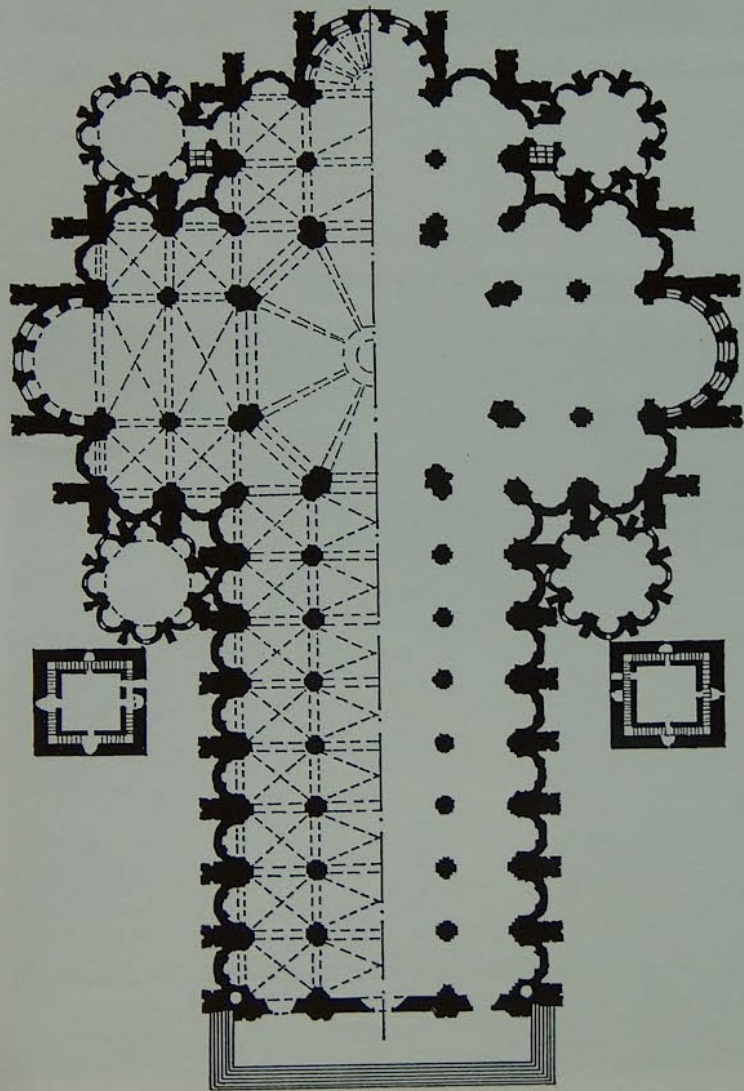

Figure 16 Donato Bramante: Milan, S. Maria presso S. Satiro, begun 1478, plan





Pavia, katedrála před 1490



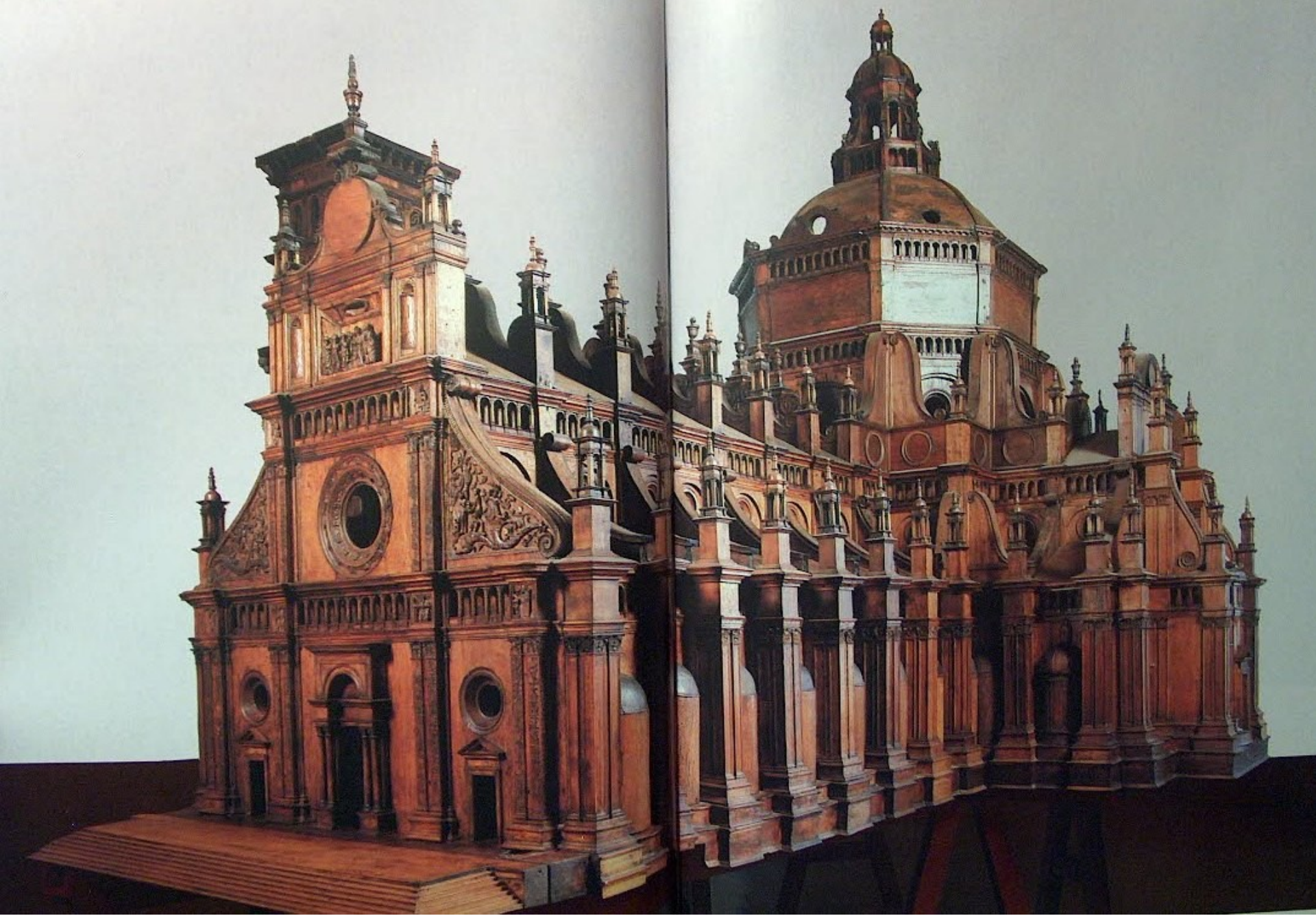



Milano, S. Maria delle Grazie, po 1497



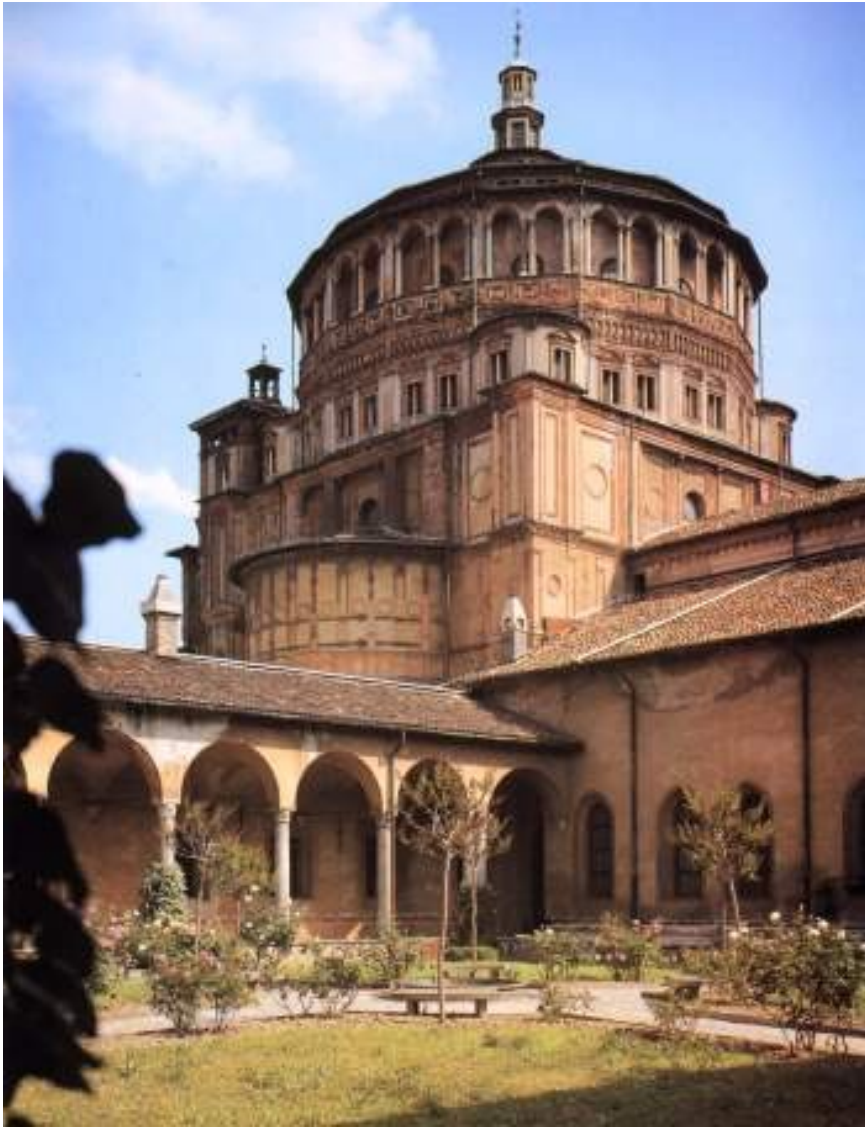



Milano, S. Maria delle Grazie, po
1497



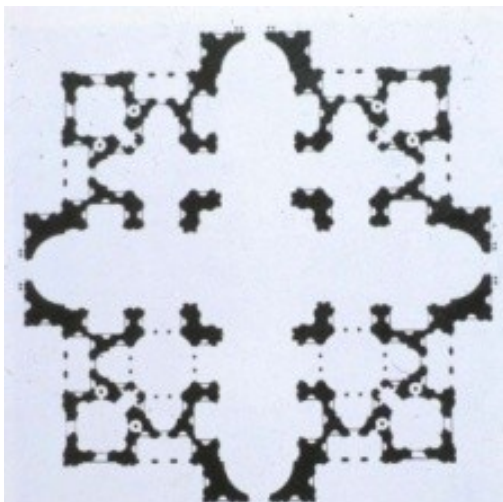
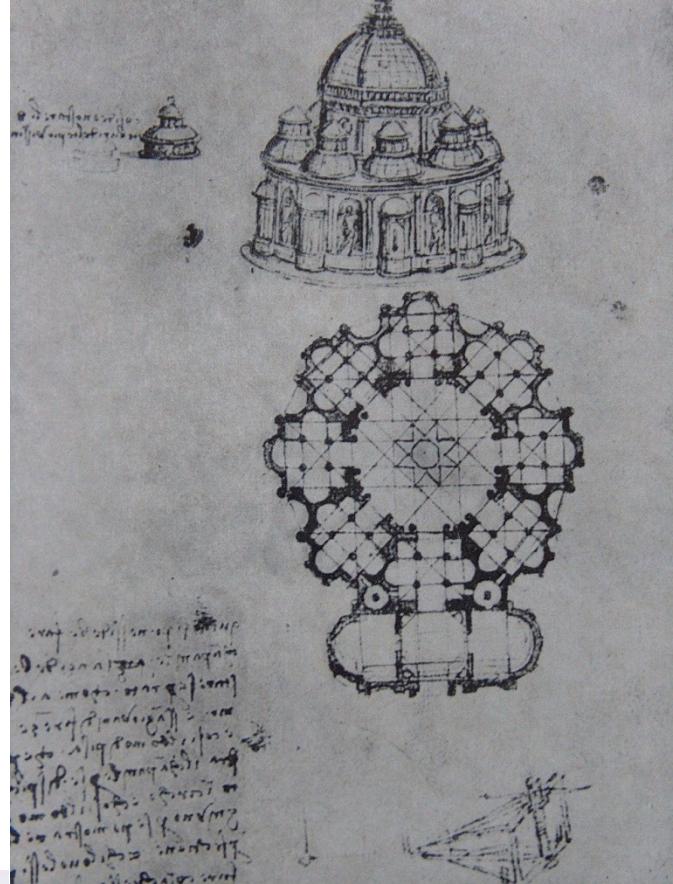

100. DESIGN BY B. B. B. Original Plan for

- Francesco di Giorgio Martini
(1439–1501/2)
- Giuliano da Sangallo
(Giuliano di Francesco Giamberti)
(1443 /1445/ – 1516)
- Simone del Pollaiuolo, zvaný Cronaca
(1457–1508)

Francesco di Giorgio Martini (1439–1501/2)

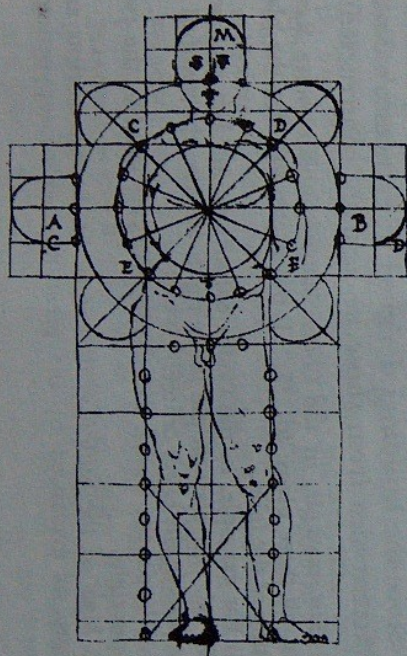

19. Proportions of a Temple Plan Derived from the Human Body, Francesco di Giorgio. Florence, Biblioteca Nazionale

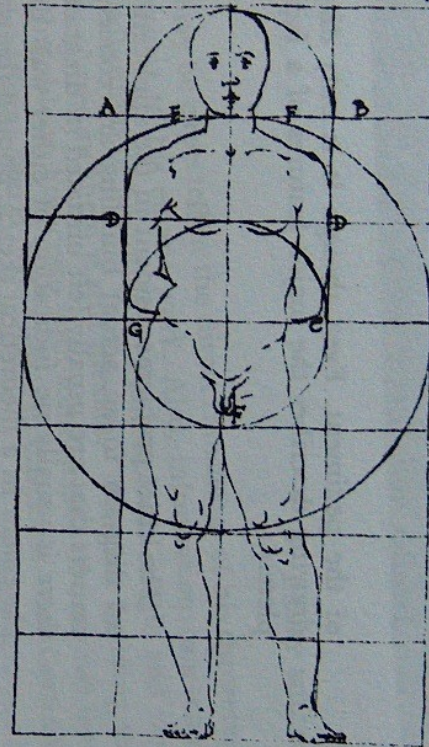

20. Proportions of a Temple Plan Derived from the Human Body, second type, Francesco di Giorgio. Florence, Biblioteca Nazionale

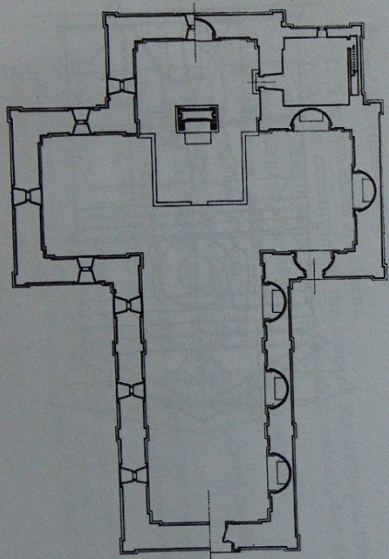

21. Proportions of a Temple Façade Derived from the Human Body, Francesco di Giorgio. Florence, Biblioteca Nazionale

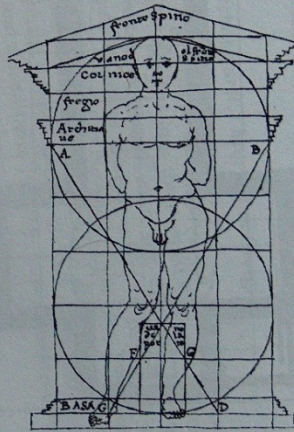

22. S. Maria del Calcinaio, Cortona, plan, Francesco di Giorgio. From Papini, Francesco di Giorgio Architetto, III, pl. 56

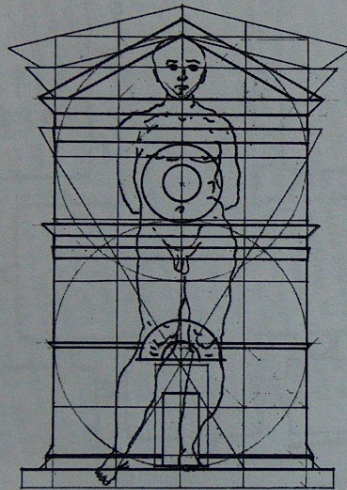

23. Fig. 20 superimposed on fig. 22, author's drawing.

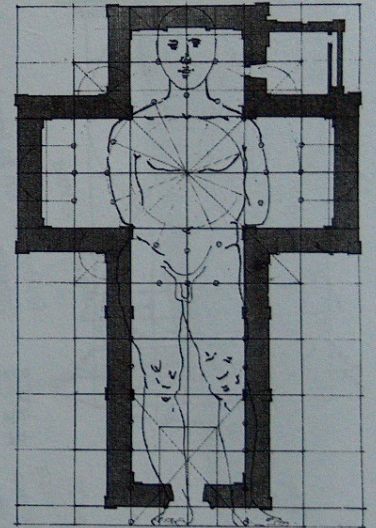

24. Fig. 21 superimposed on façade elevation of S. Maria del Calcinaio, author's drawing.

S. Maria v Calcinaio
u Cortony, 1484-1485



S. Maria v Calcinaio
u Cortony, 1484-1485

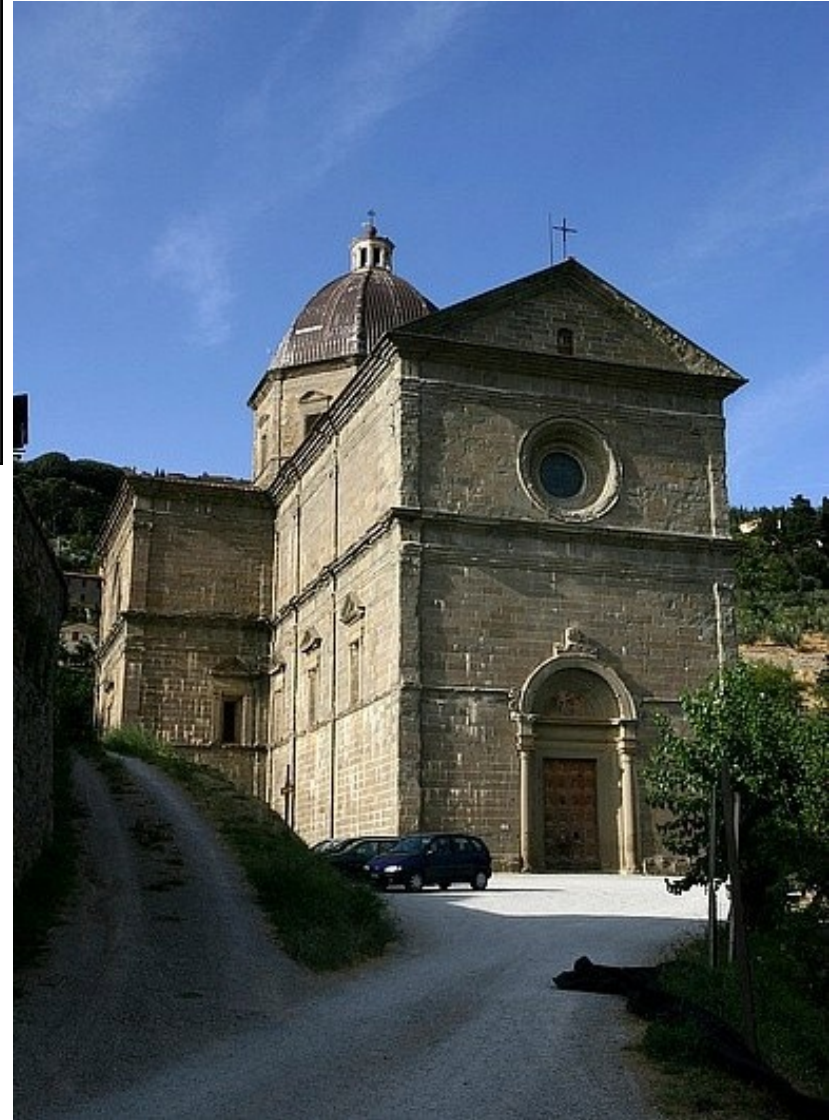
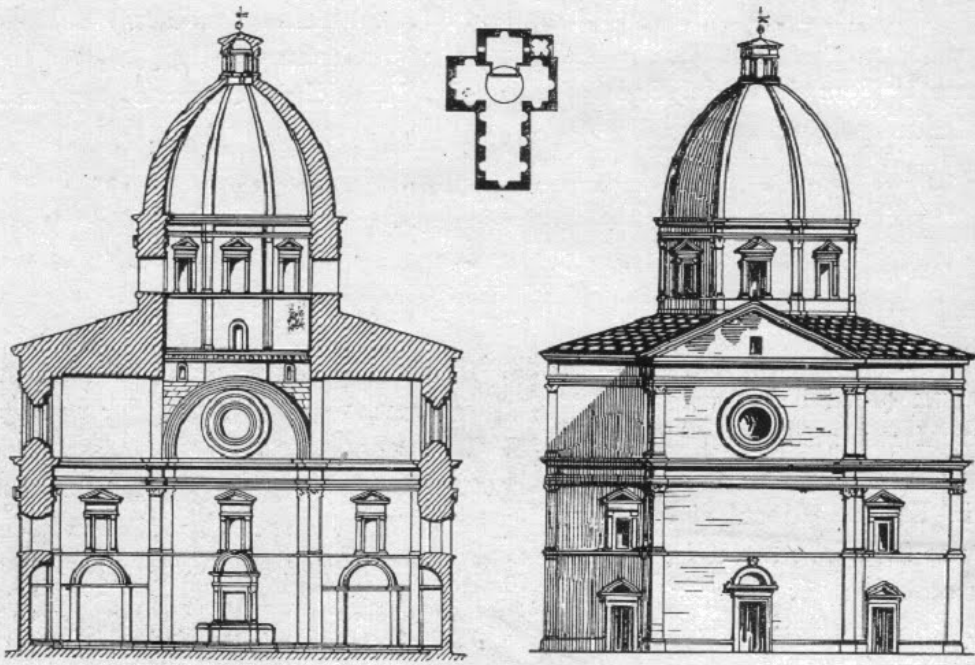

S. Maria v Calcinaio
u Cortony, 1484-1485



S. Maria v
Calcinaio
u Cortony, 1484-
1485









Francesco di Giorgio Martini, Urbino, S. Bernardino,
1482-1490





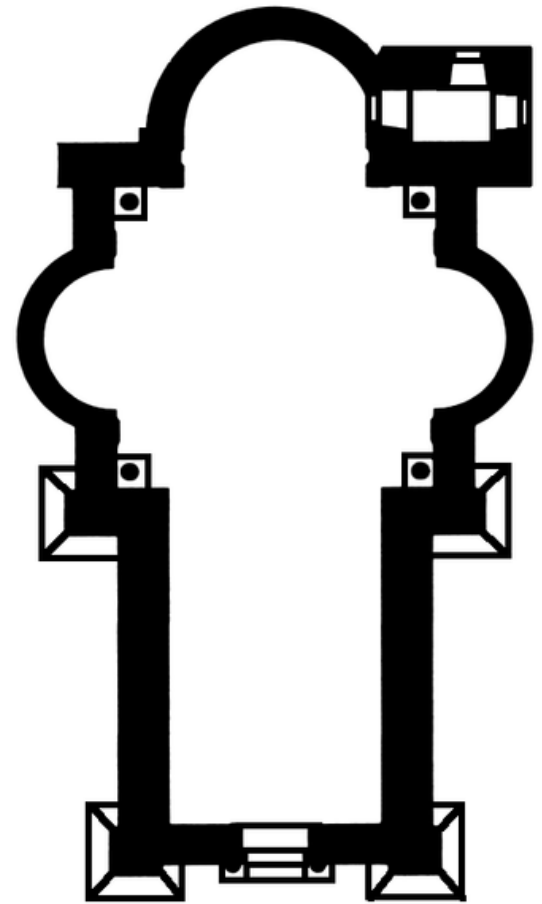





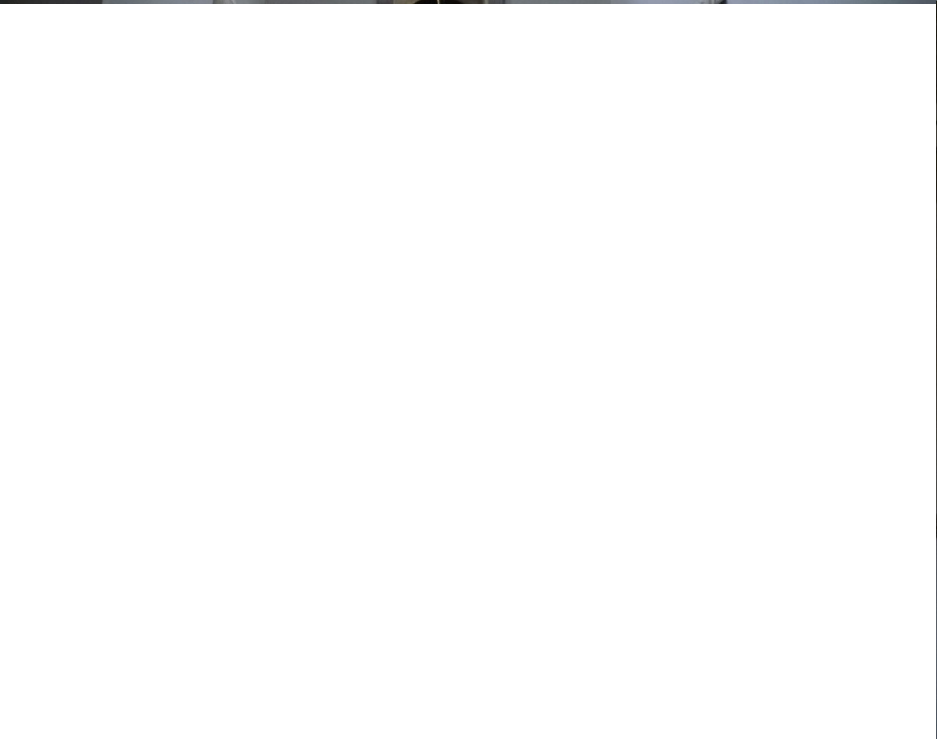

R-VERITATIS ANTE THRONVM

ADIENTIA PROTECTOR

EVIGIDIM AETERNAE











Francesco di Giorgio Martini,
Rocca S. Leo, po 1479

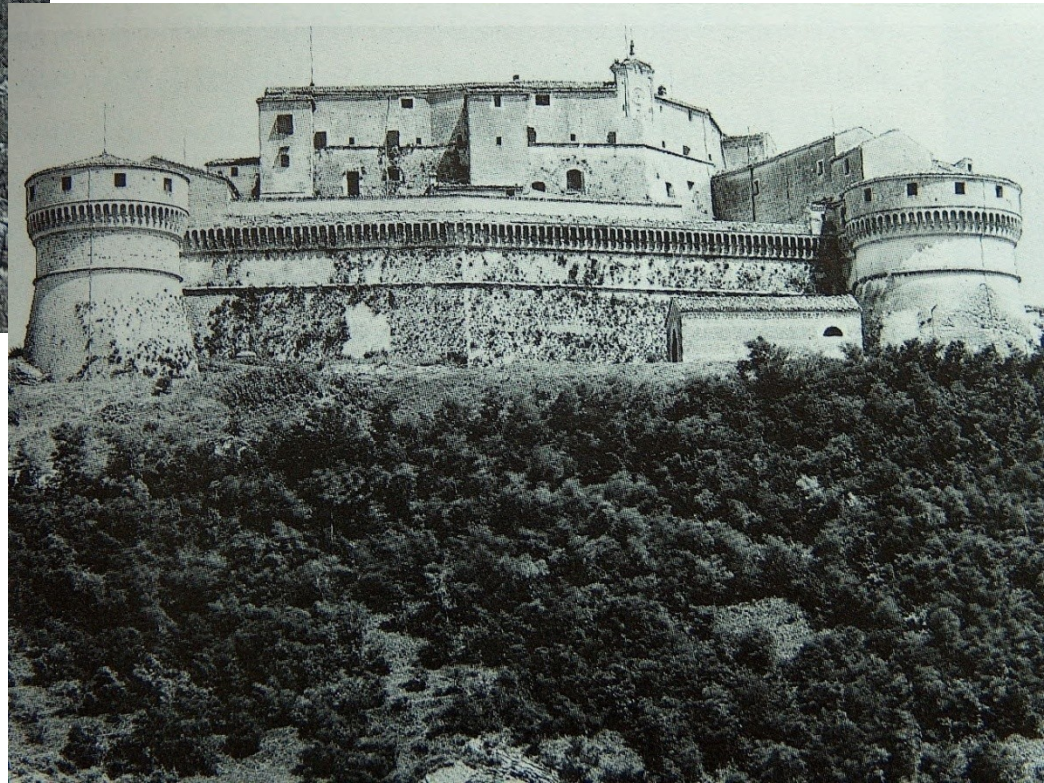

Giuliano da Sangallo
(Giuliano di Francesco Giamberti)
(1443 /1445/ – 1516)

S. Biagio, Montepulciano (Antonio da Sangallo st.)



Giuliano da Sangallo, zakreslení římského Kolosea

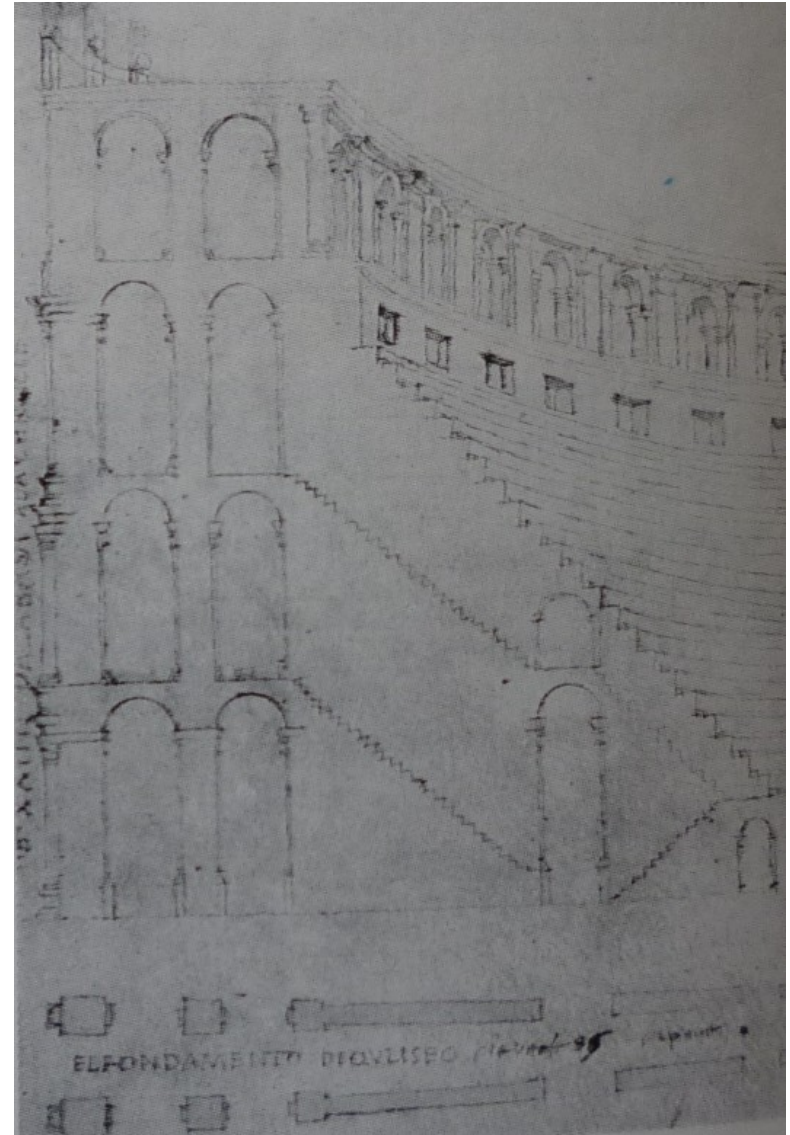
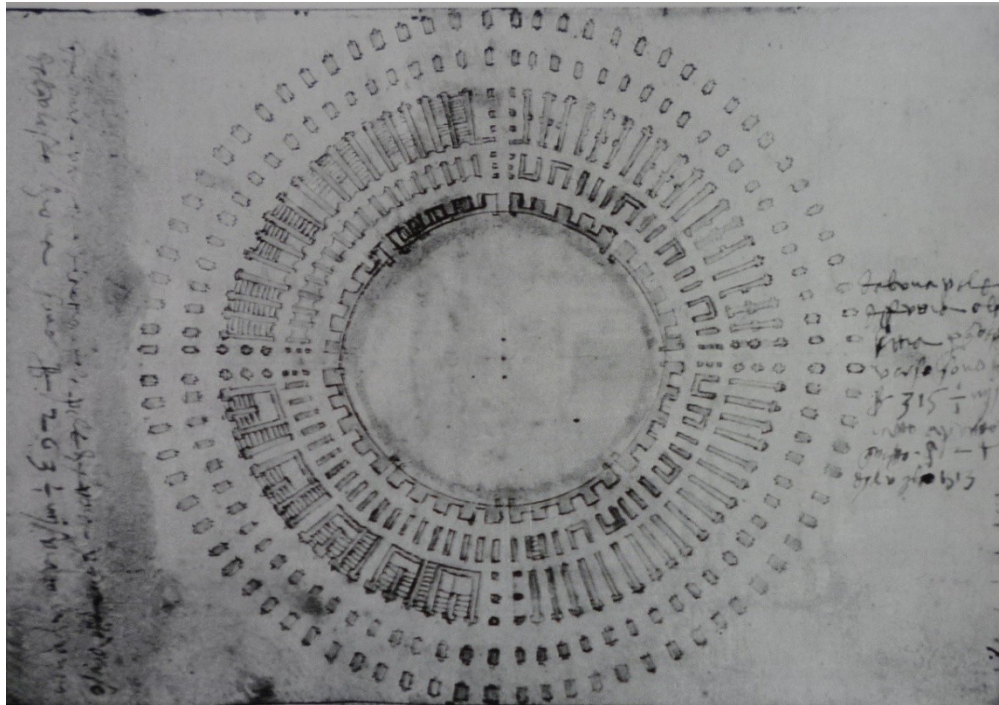



Florence, Palazzo Scala, 1472-1480 (Palazzo della Gherarda)





Villa del Poggio a Caiano (1485-1497)



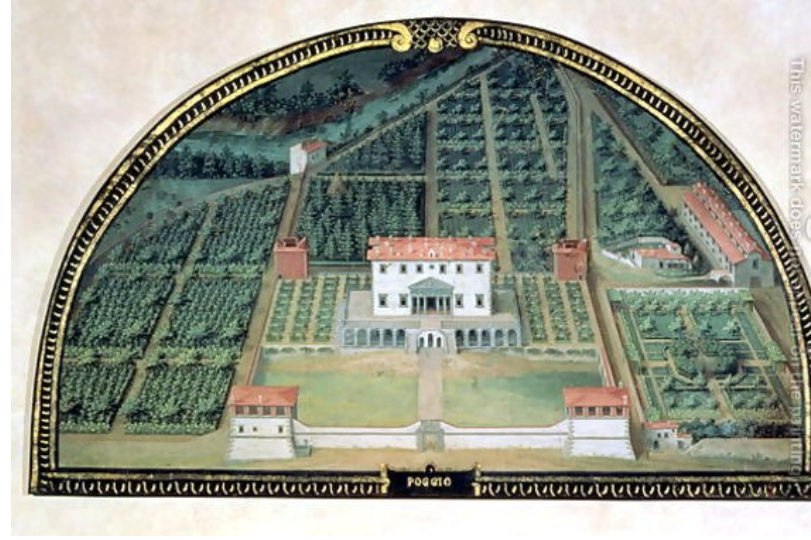

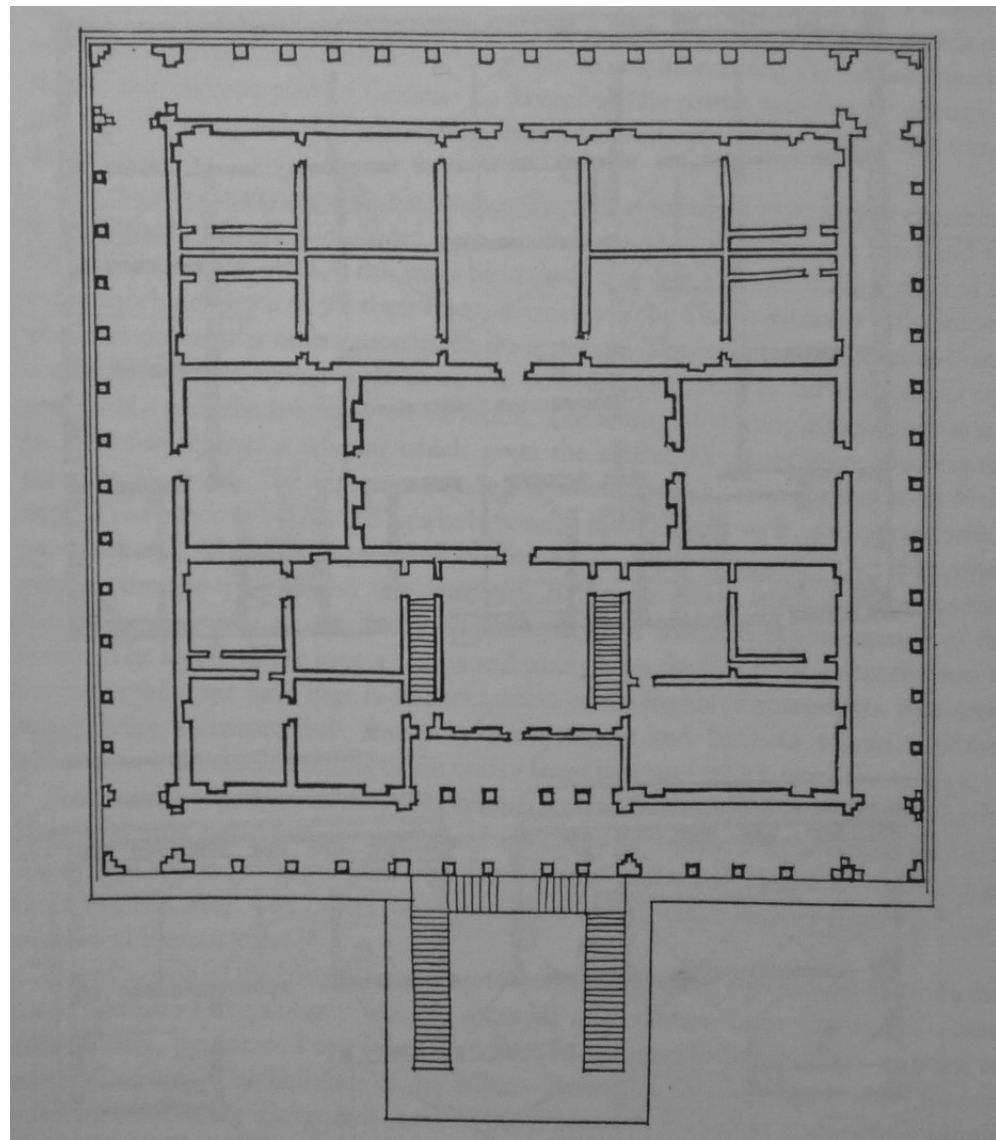
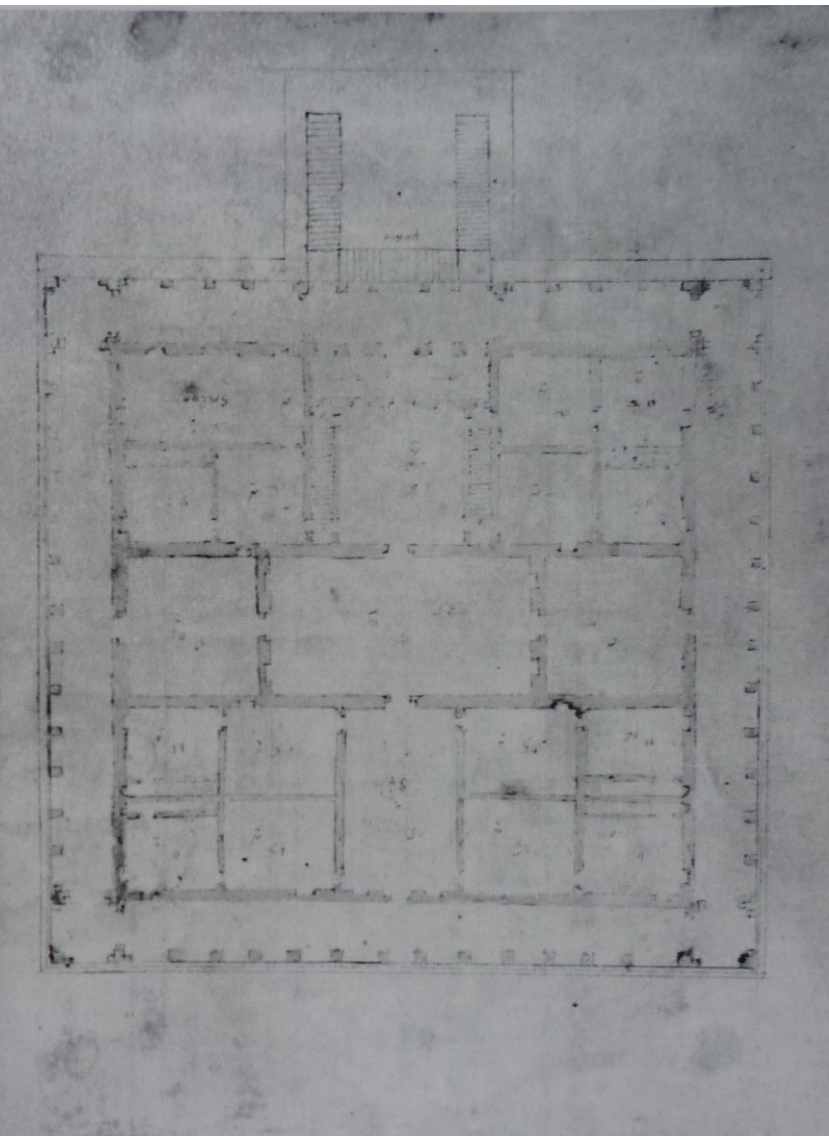







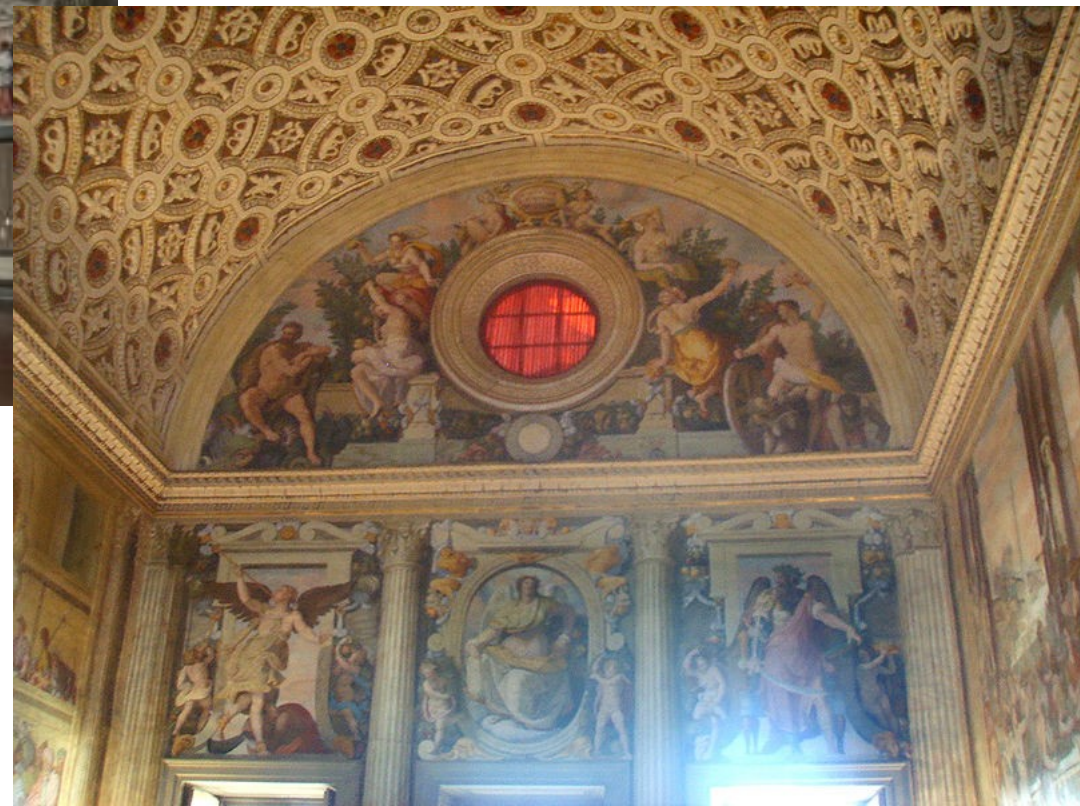

S. Maria delle Carceri v Pratu, 1484-1491

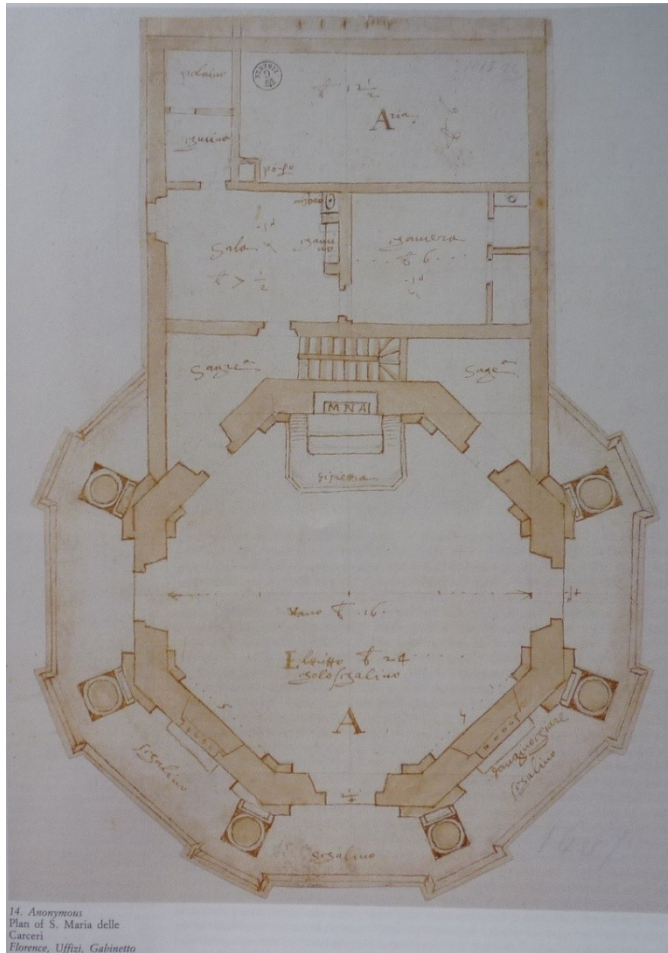

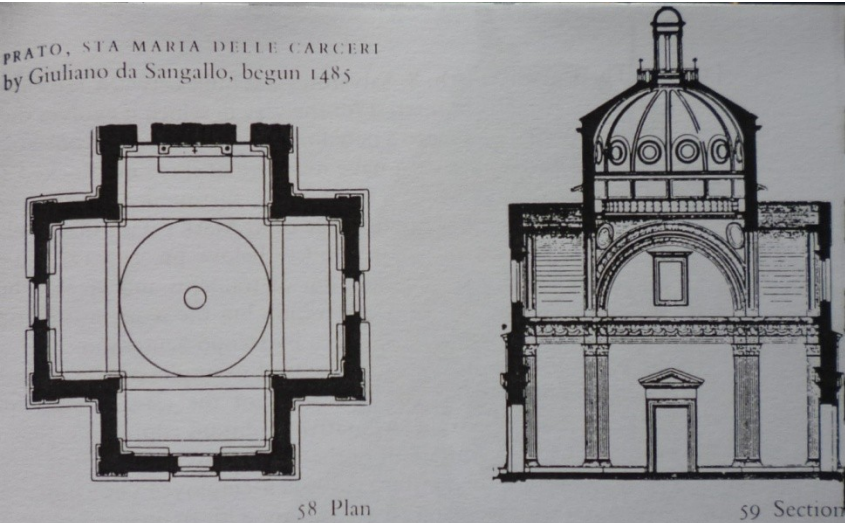



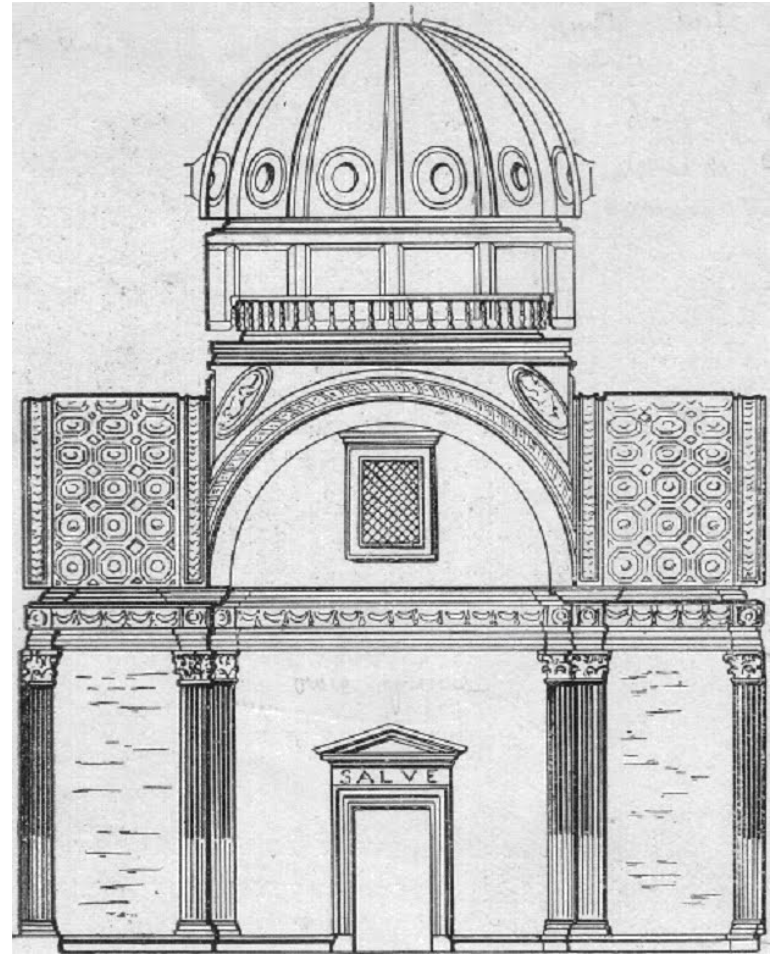
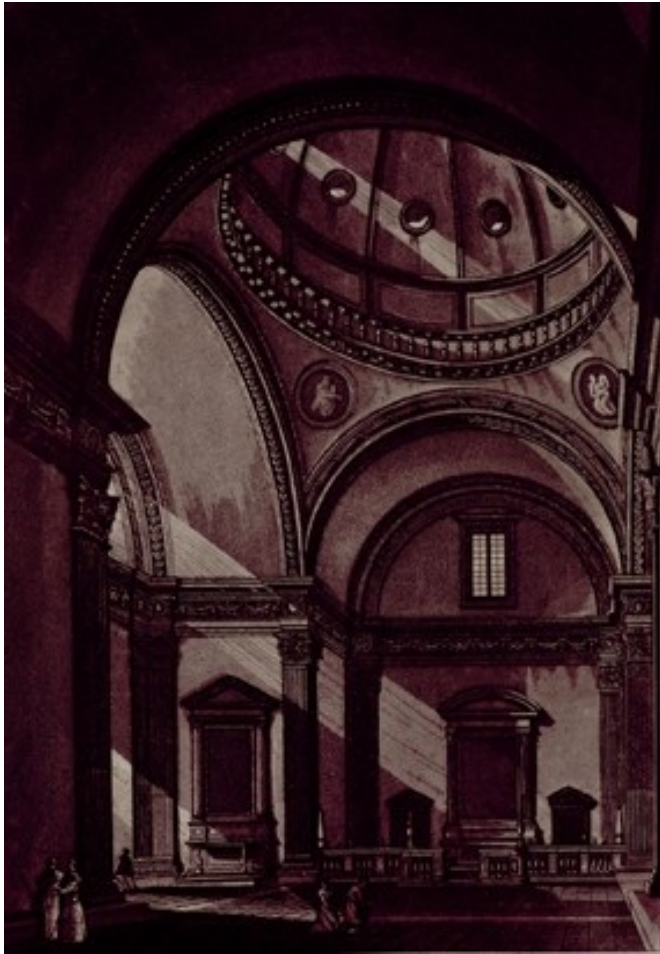

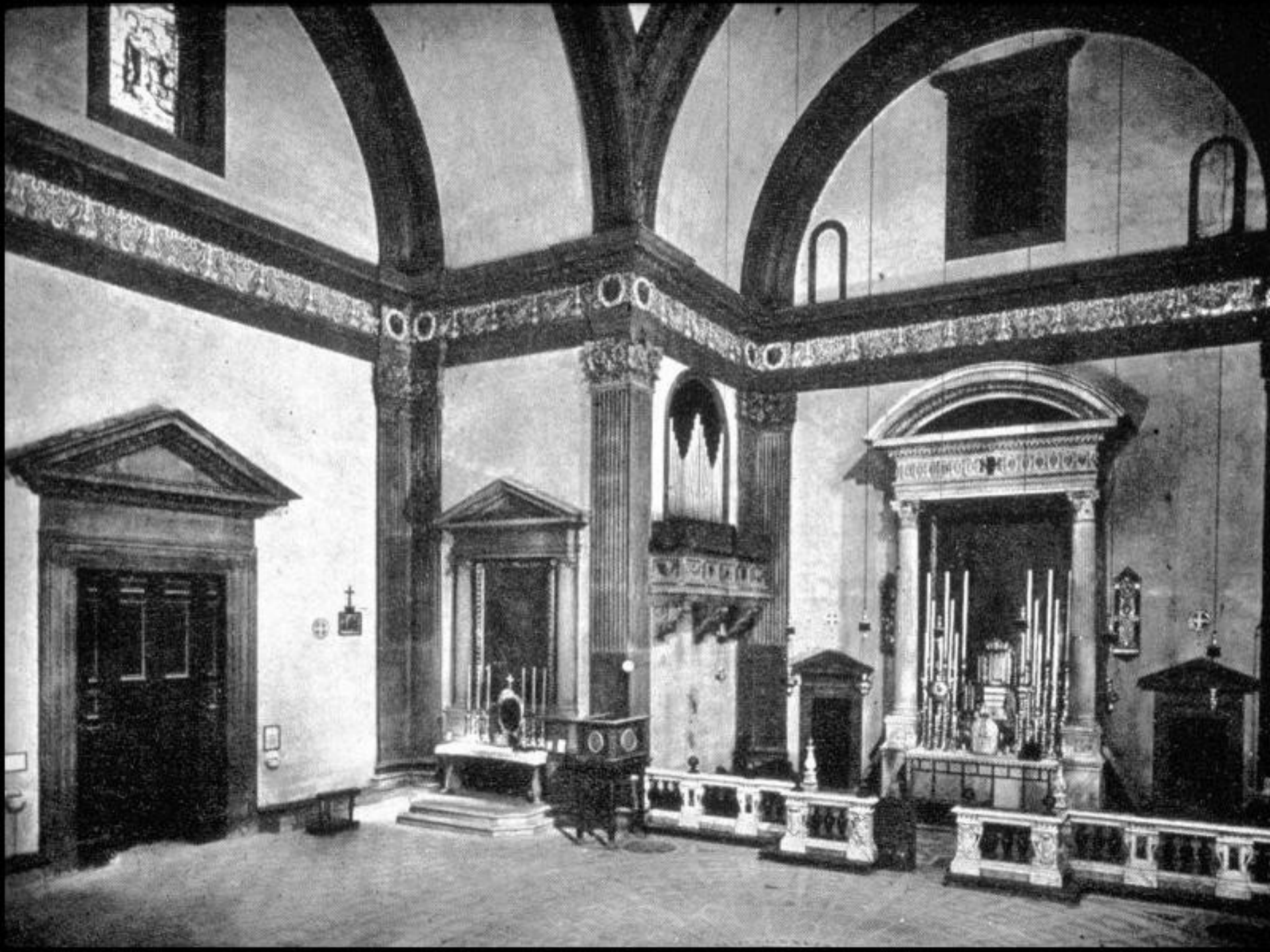

Atrium S. Maria Maddalena
de'Pazzi ve Florencii,
kol. 1490-1495



Palazzo Gondi, Florencie,
1490-1494





Palazzo Gondi, Florencie, 1490-1494

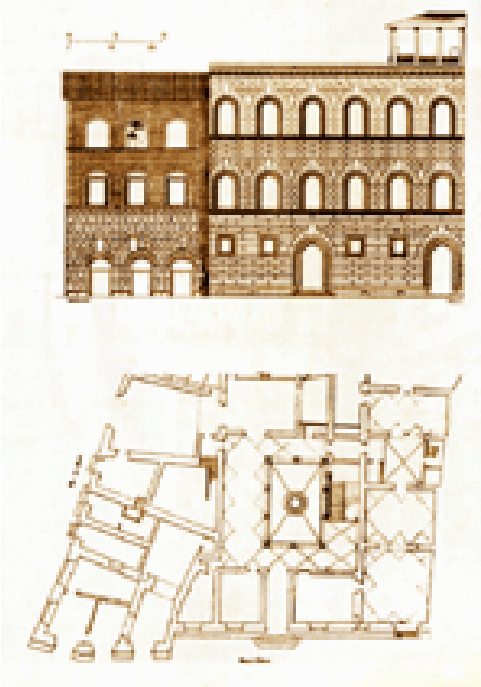





B&B

CAFFE - LUNCH BAR





Florence, Palazzo Strozzi,
1489-1490









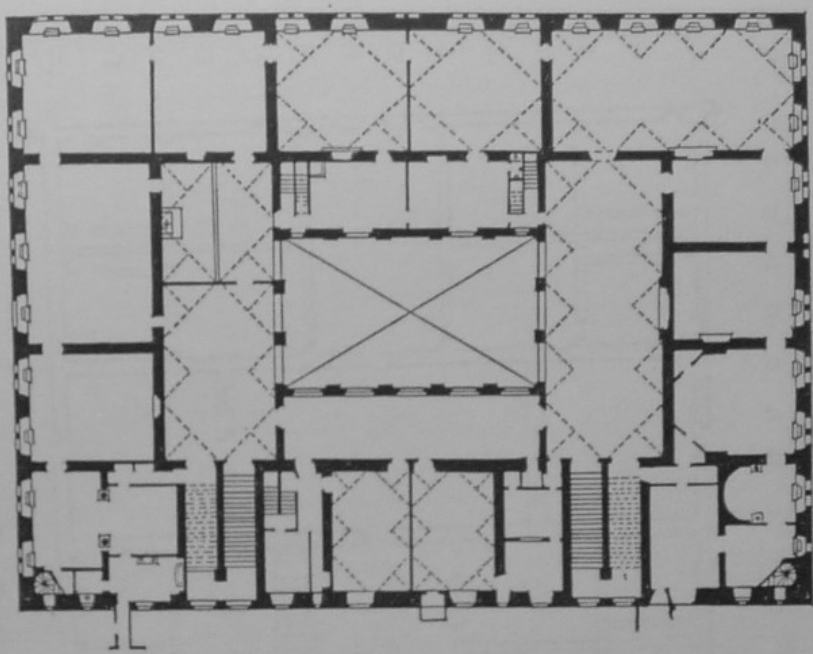

0 15m

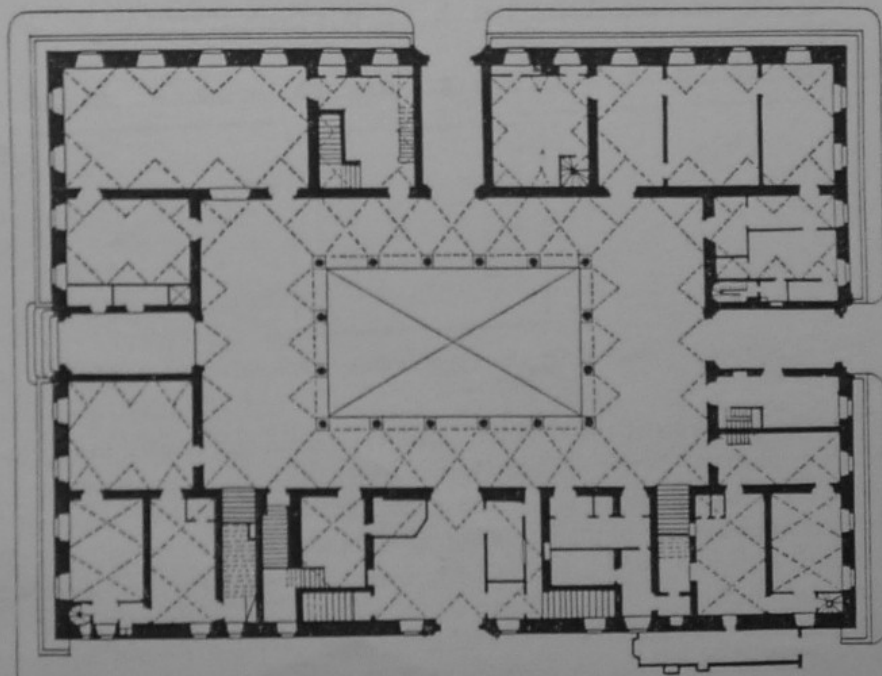

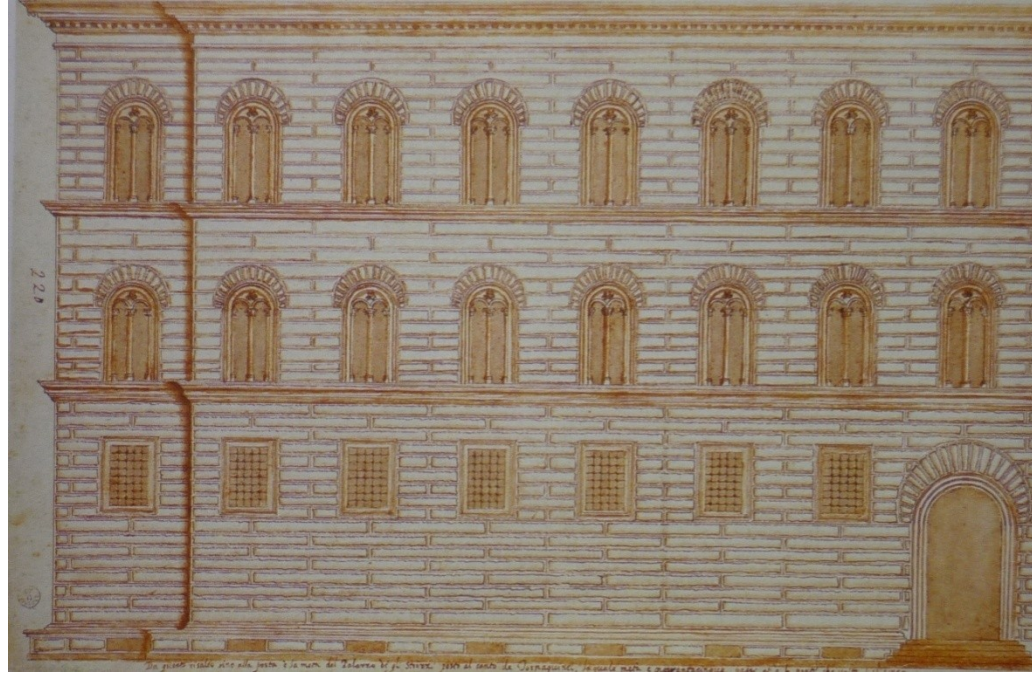













Neapol, Poggio Reale, 1487-1488 (Giuliano da Maiano)

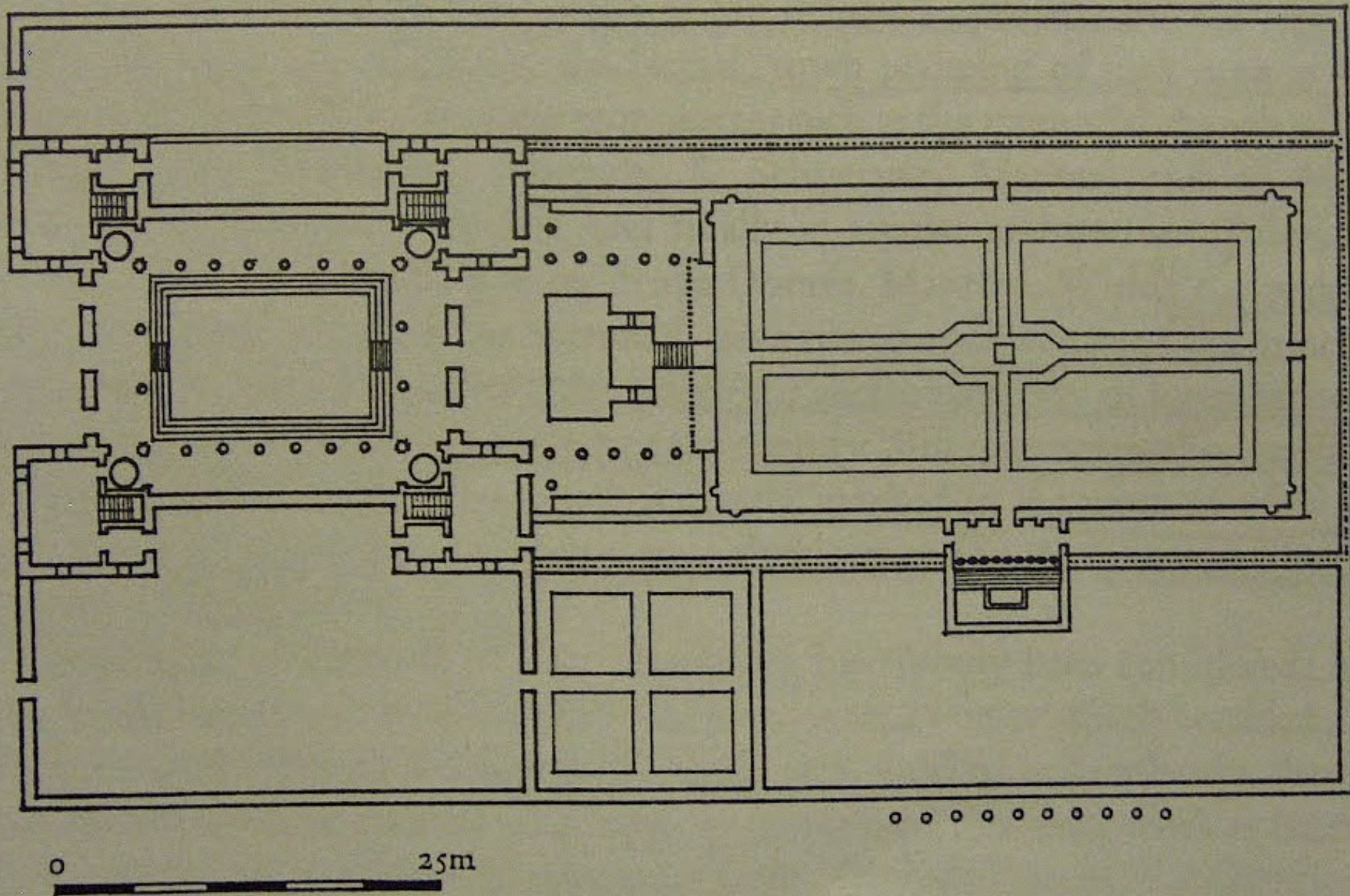

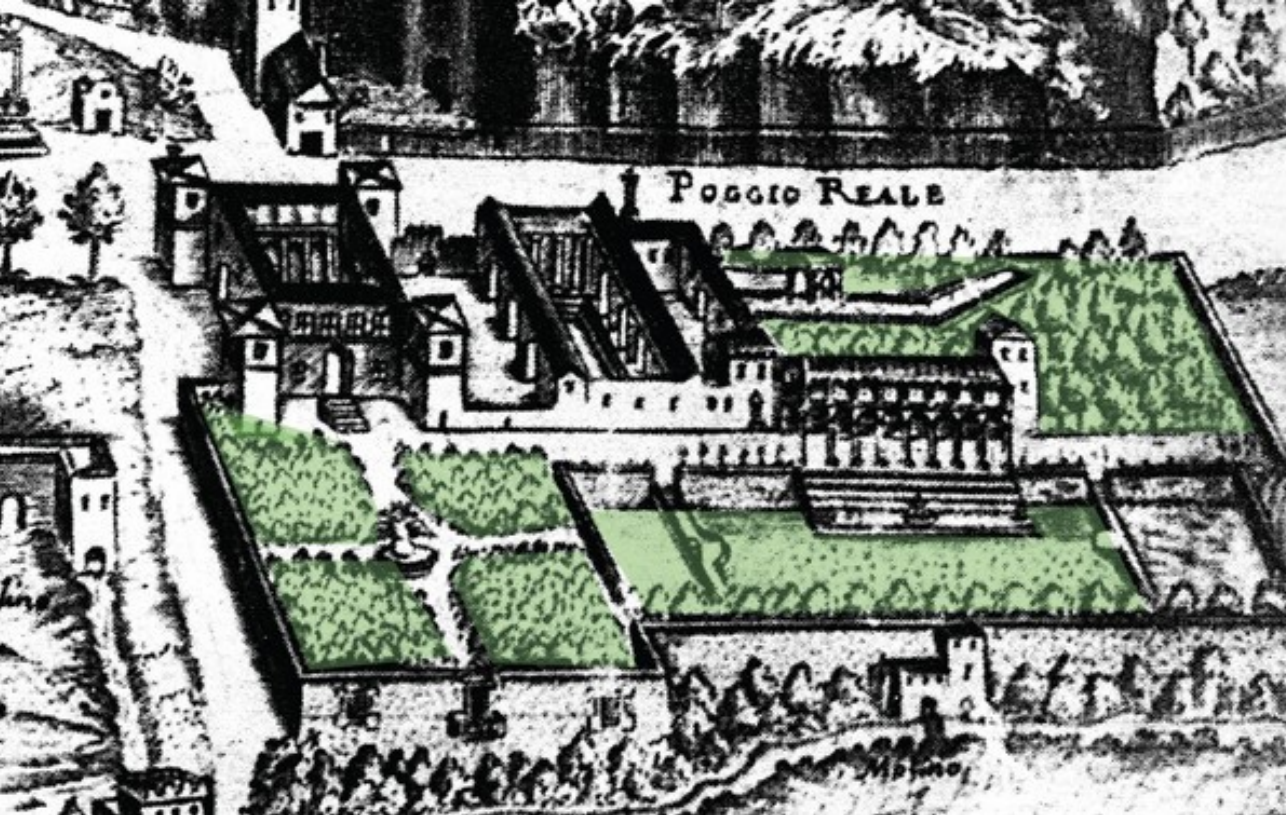

LIBER TERTIVS.

213

Presenti quidem figura tum exteriores, tum interiores quoque aedificij partes demonstrare contendimus. A, partem anteriorem primam proponit; B, interiores ambulationes porticus &c deinde designat interiora conclavia demum ostendit. In subscripta autem designatione contexti aedificij speciem novam exhibuimus: ipsum namque, ob agrorum amoenitates liberis oculis perfruendas contemplantes, ab dio potius constitutum utlemus.

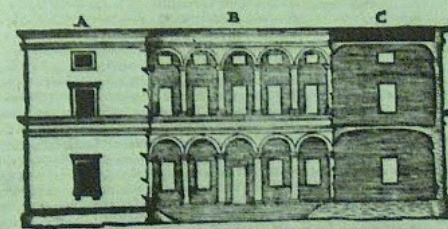

REGALIS PODII NEAPOLITANI ICHNOGRAPHIA.

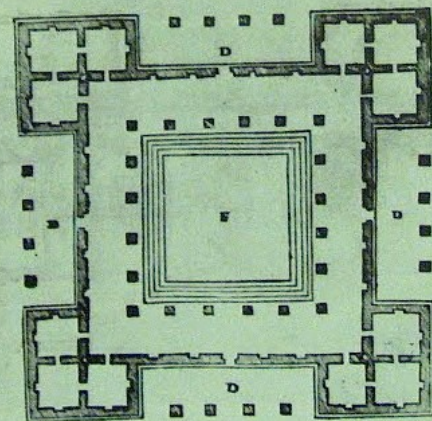

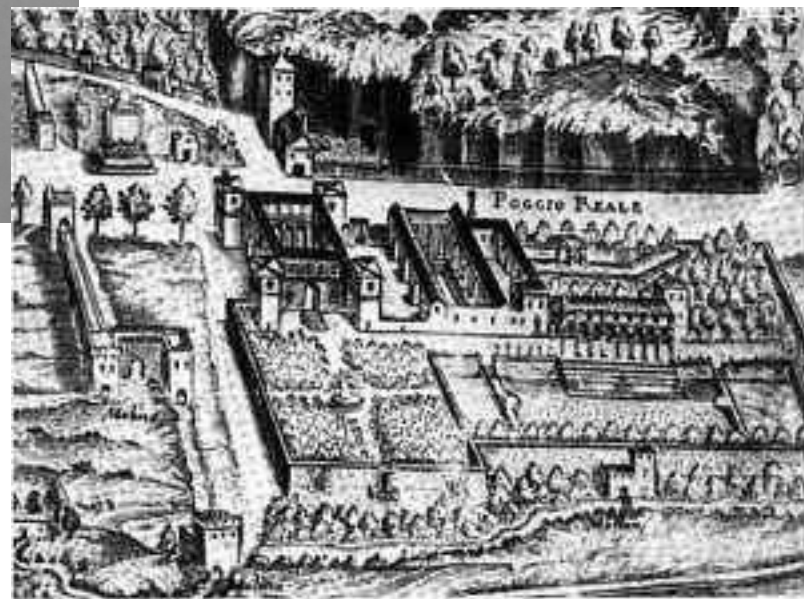
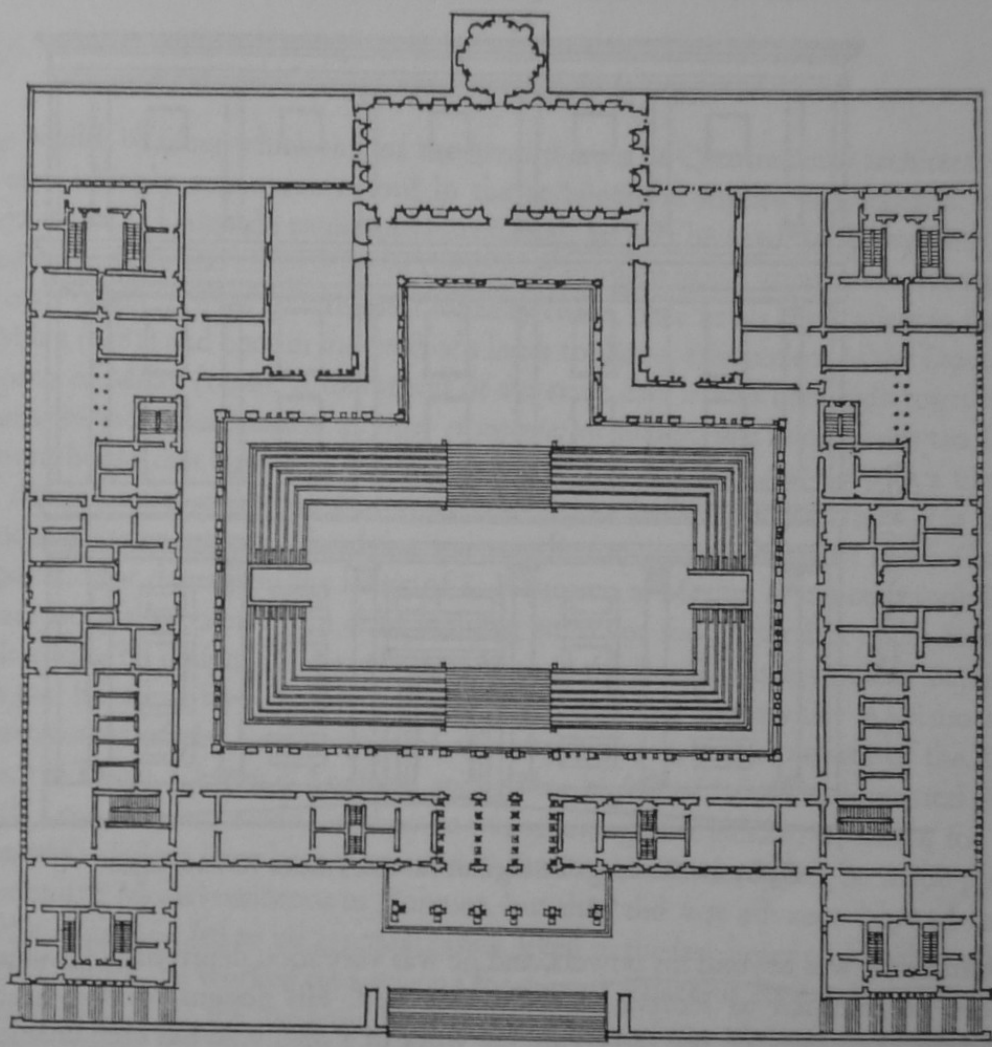

Palazzo Rovere v Savoně, po 1490
(pro Giuliana della Rovere – budoucího papeže Julia II.)

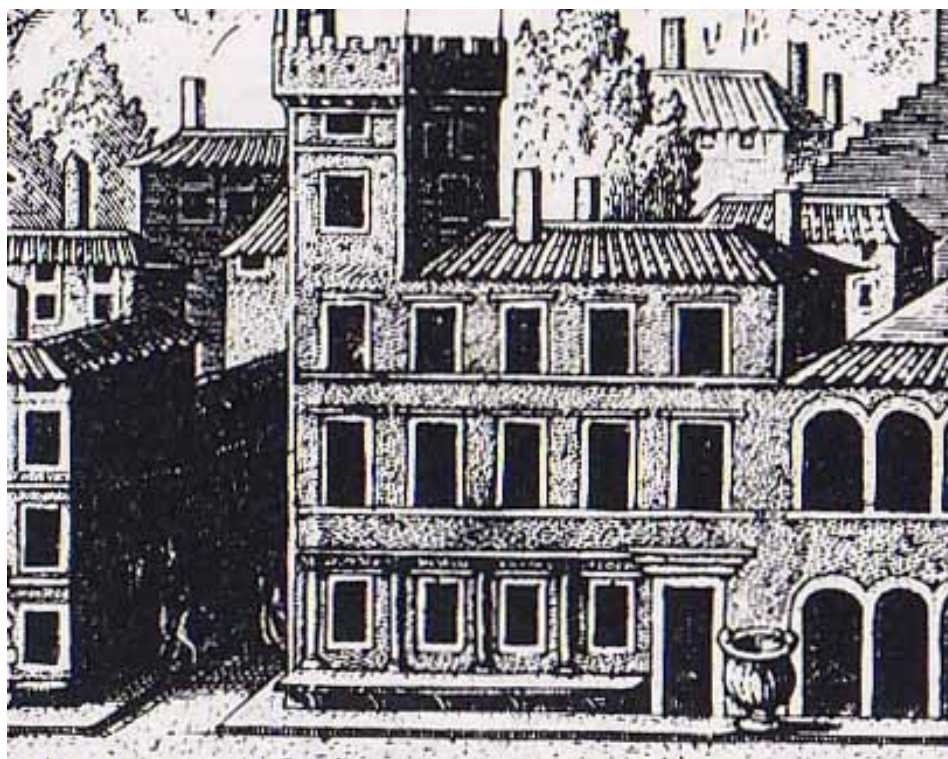



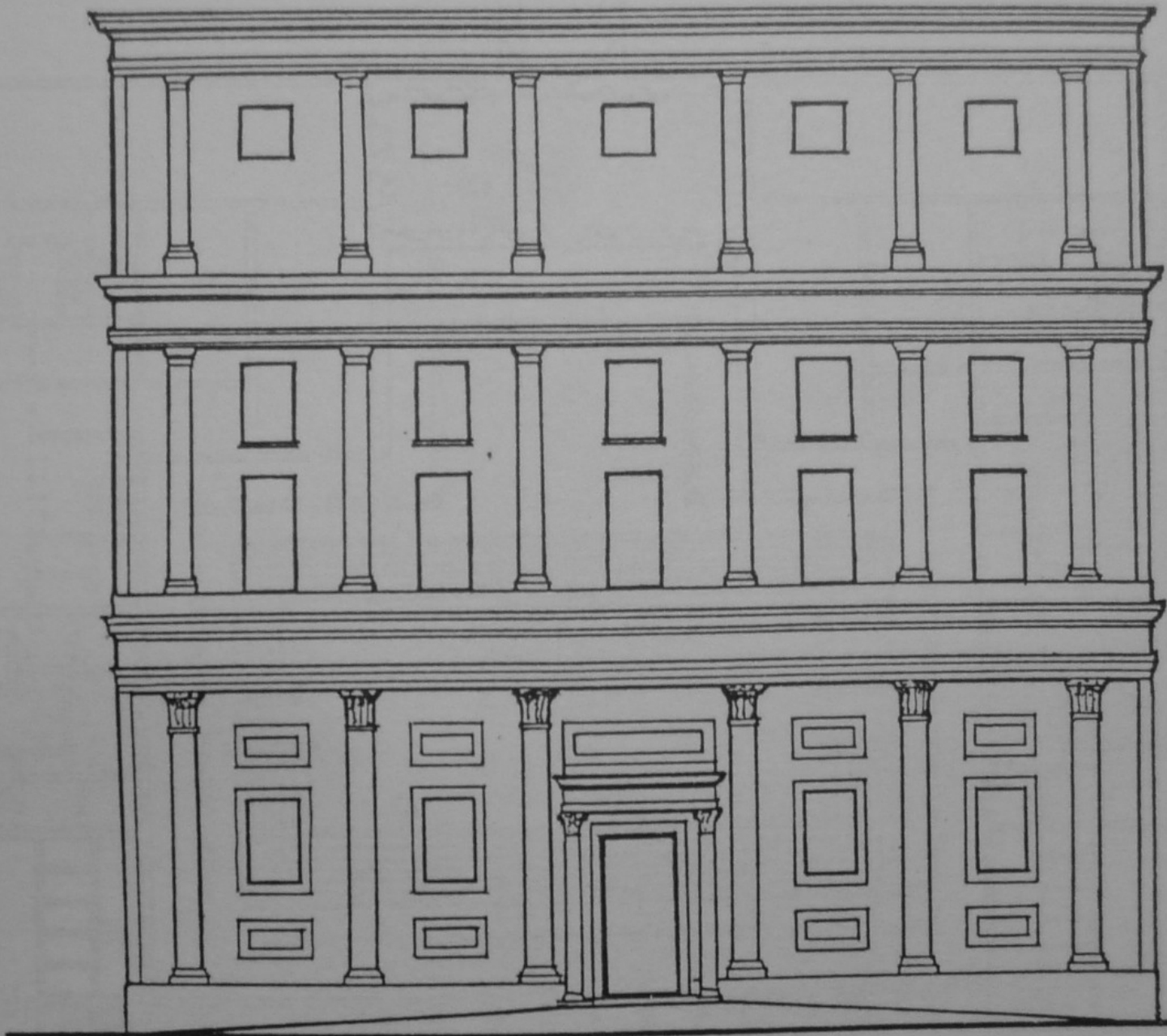

S. Spirito ve Florencii

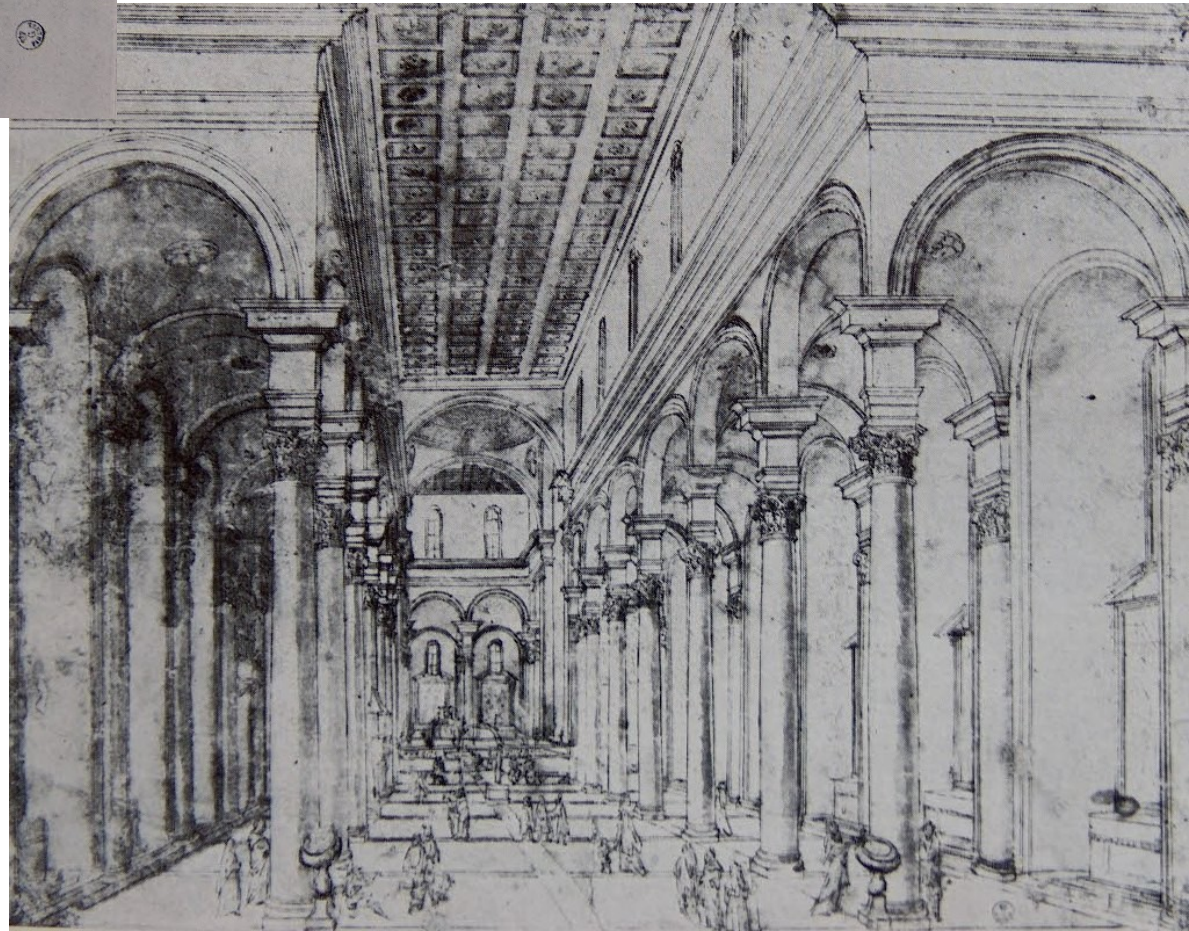
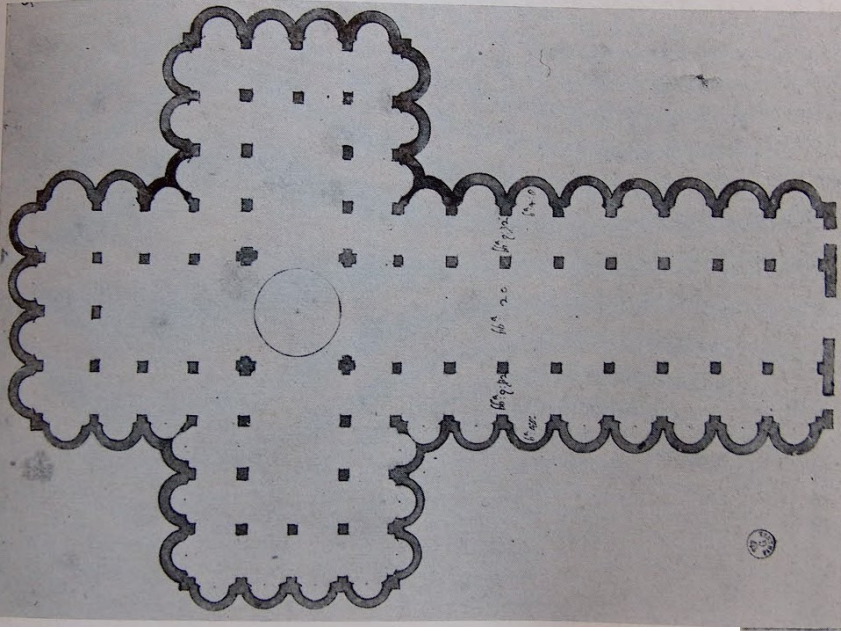

Florence, sacristy in S. Spirito
(jointly with Cronaca, 1492-1494)







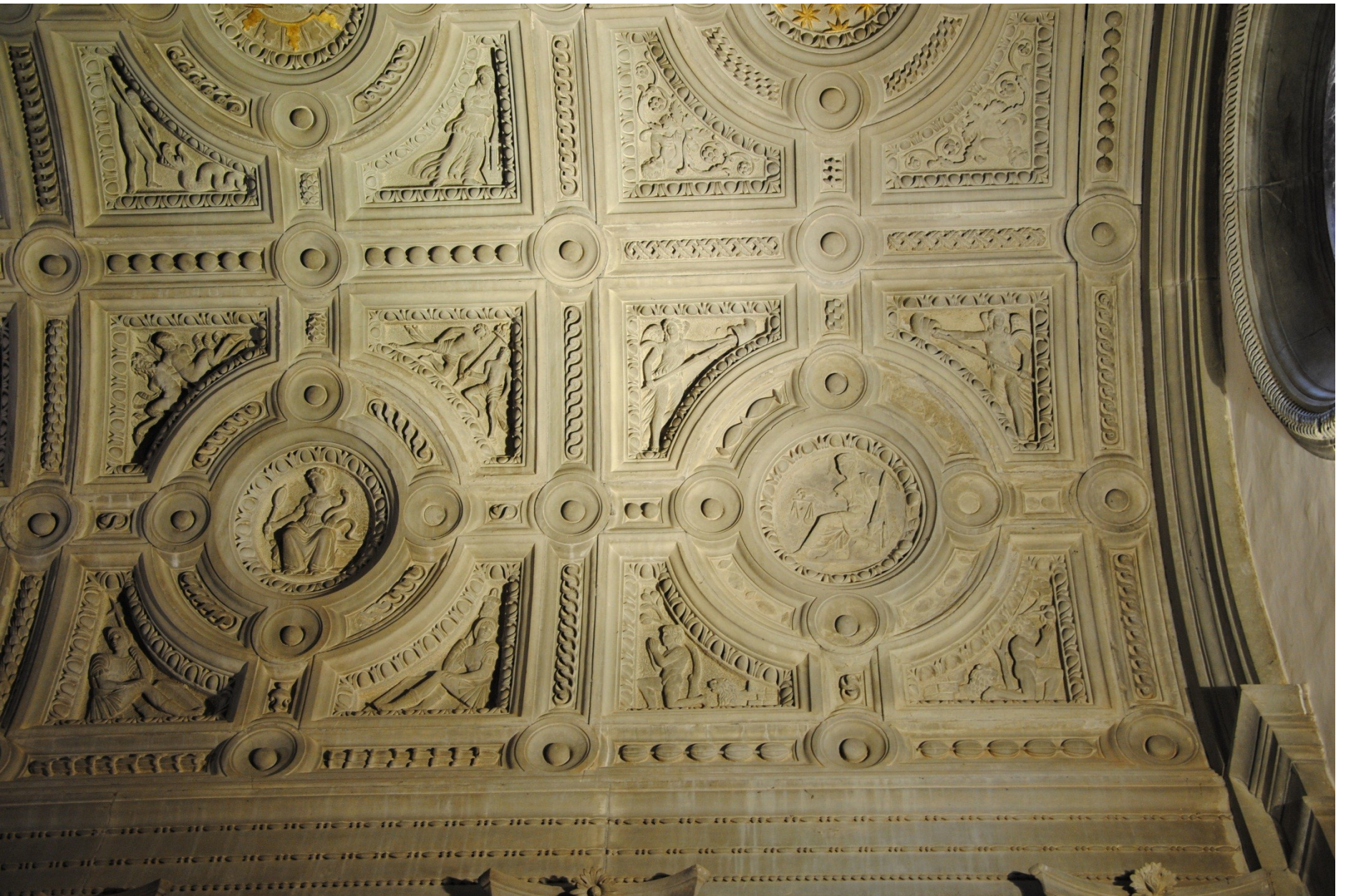



Antonio da Sangallo st. (1455–1534)

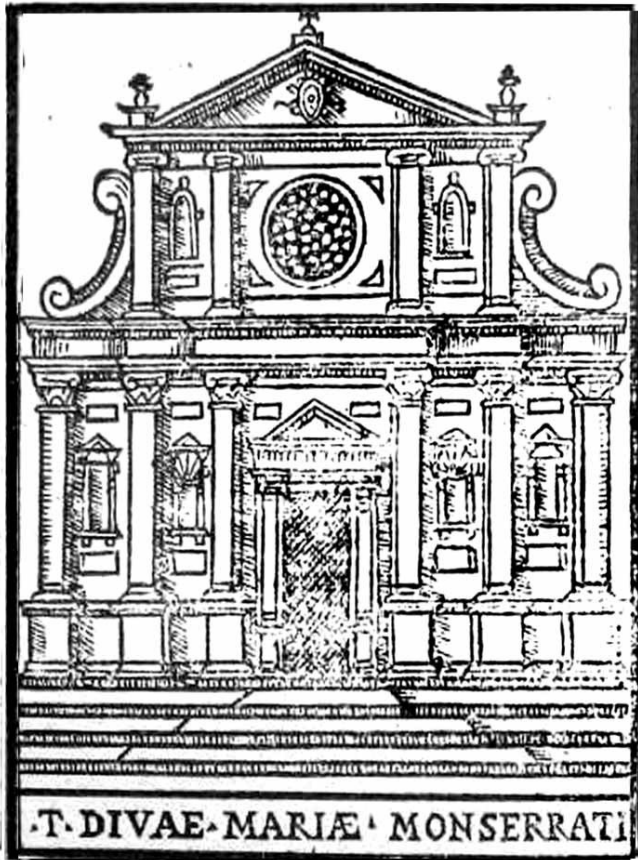

- S. Maria di Monserrato v Římě, před 1500







M · B

V · A · L · D · I · V · I · D · I · S

STENDE · O

· V · I · T · A · I · V · I · C · I · D · I

· G · D · V · I · R · G · O · M · A · R · I · A · S · A · L · V · E · R · E · G · I · N · A · M · A · T · E · R · A · N · I · M · E · S · S · I · M · U · S · P · R · I · M · I · S · S · I · M · U · S ·

S. Biagio, Montepulciano (Antonio da Sangallo st.)



Simone del Pollaiuolo, zvaný Cronaca
(1457–1508)



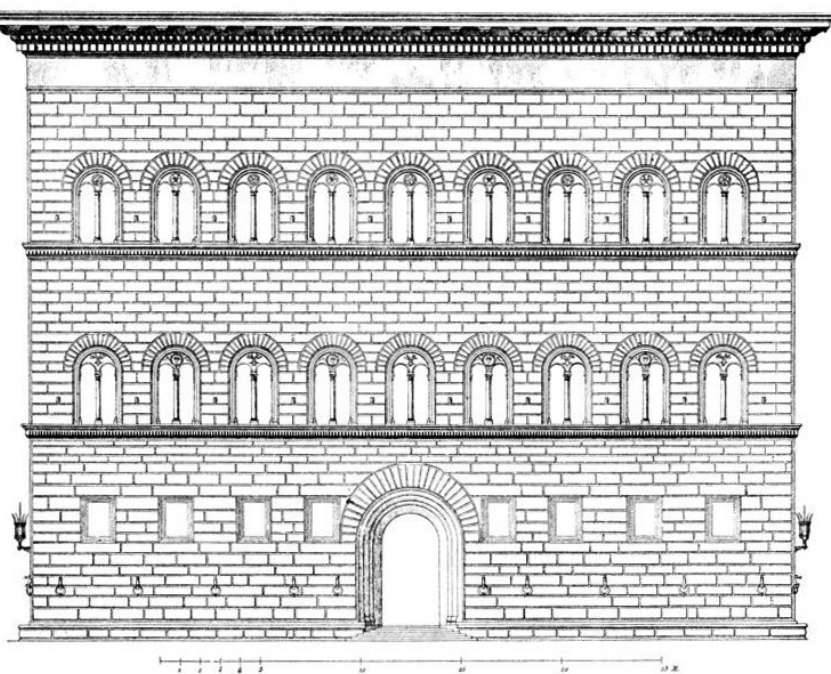

159. Fassade des Palazzo Strozzi in Florenz
Nach Gallabaud.



Florence, Palazzo Gondi, po 1490 (s Giulianem da Sangallo)

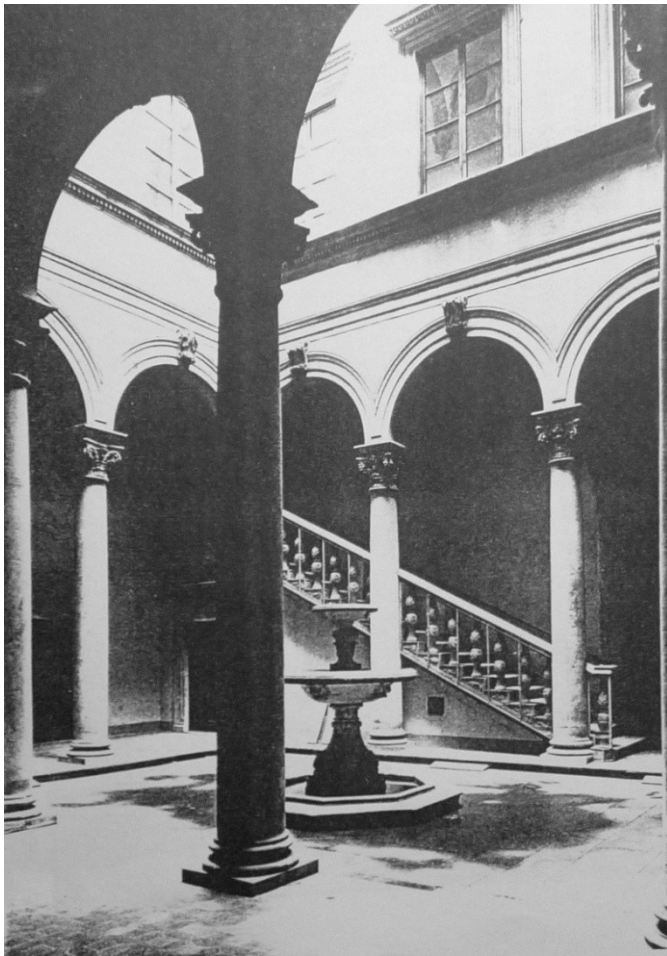



S. Francesco
(S. Salvatore) al Monte
ve Florencii, 1487-1504



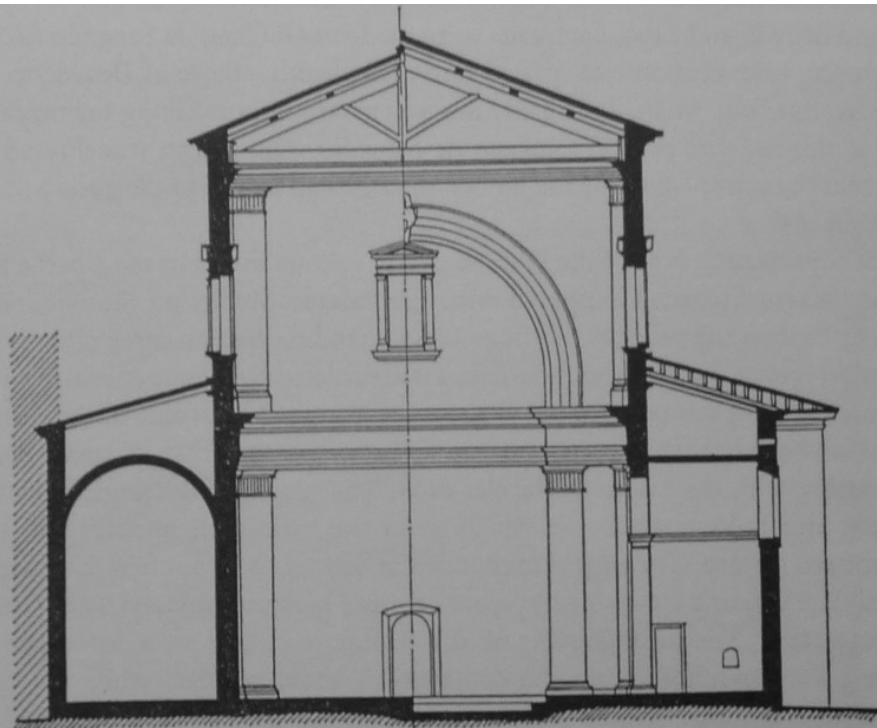

0 10m

