

Ubaid a Uruk v Mezopotámii

UBAID

Extension of Ubaid culture (c. 5900–4300 BC)



0 100 km



- area of Ubaid culture
 - Eridu settlement of the Ubaid period
 - (Basra) towns today
- Today's watercourses and shores are shown.

Persian Gulf

Sídlní struktura

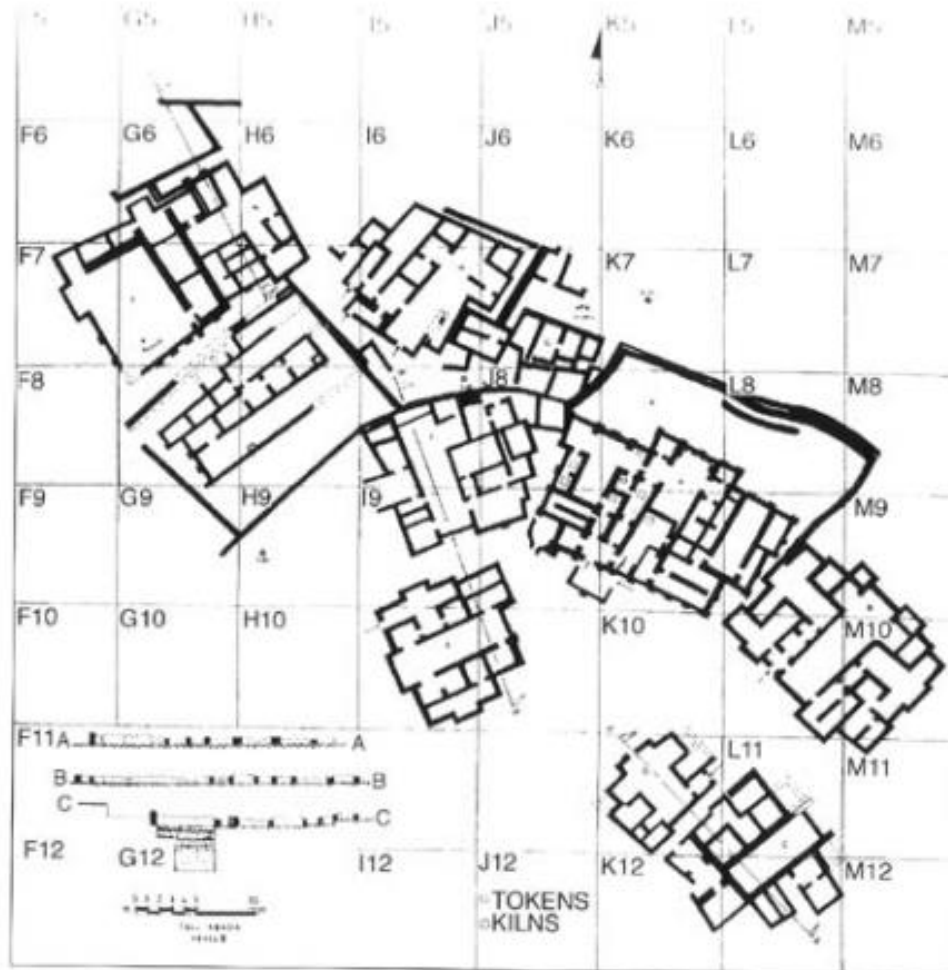
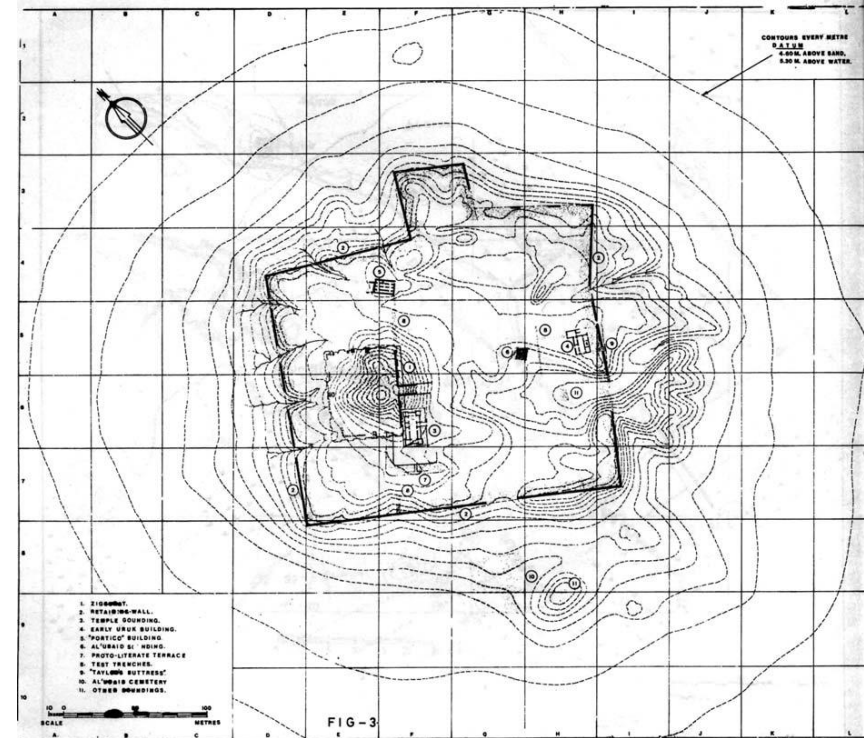
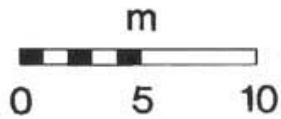
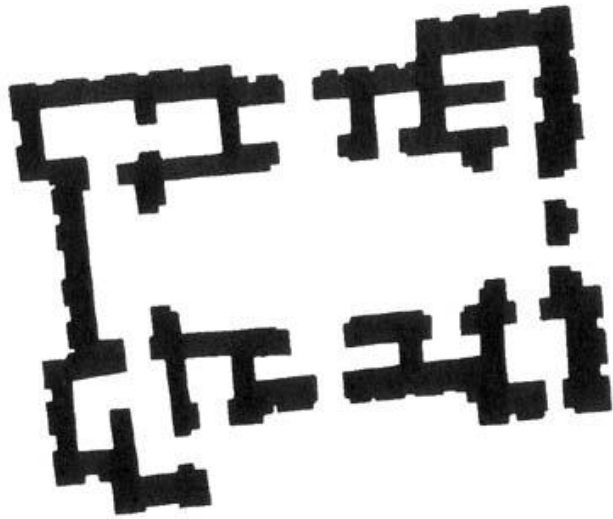

Figure 3.23 Plan of the Level II settlement at Tell Abada showing large houses tightly nucleated (early Ubaid 3)

Source: Jasim 1985, pt 2: fig. 13

ERIDU



3.3 Temple from Eridu (after Safar et al. 1981:fig. 39, Temple VII)

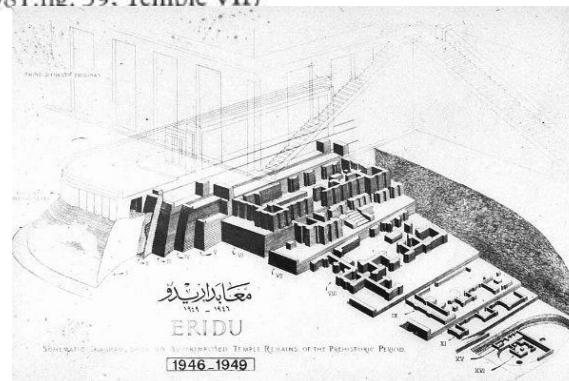

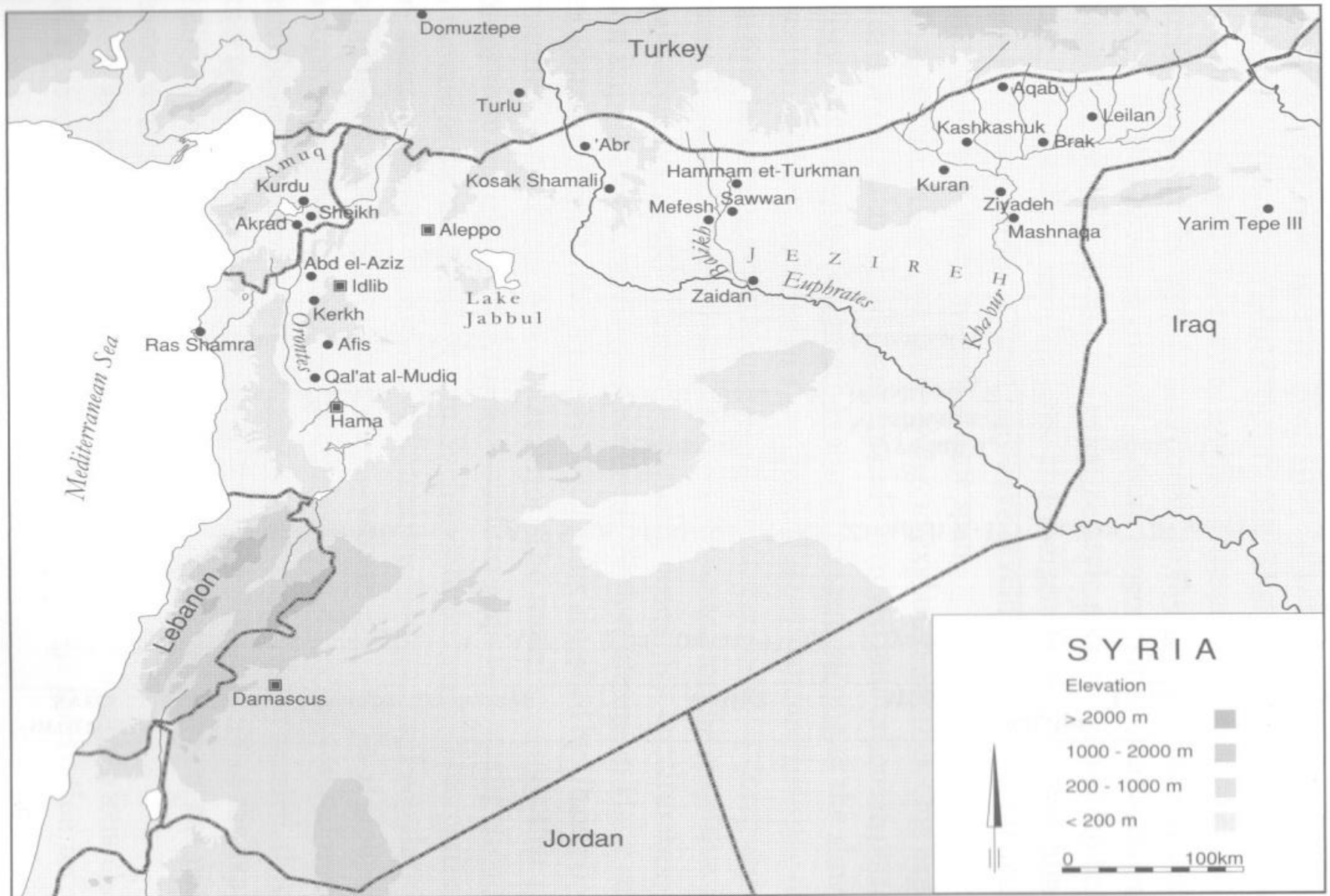
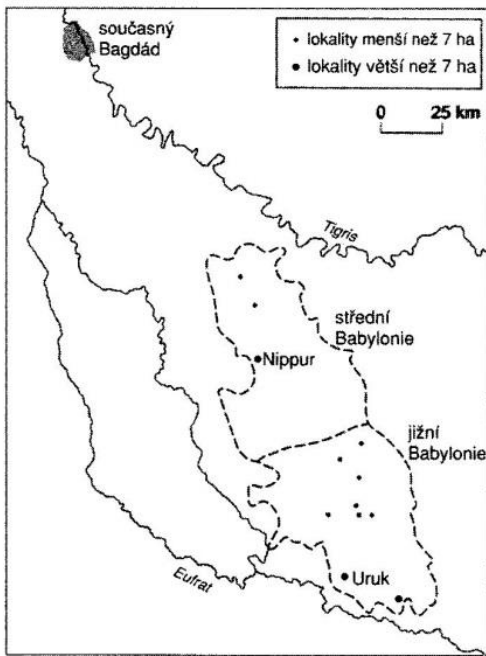
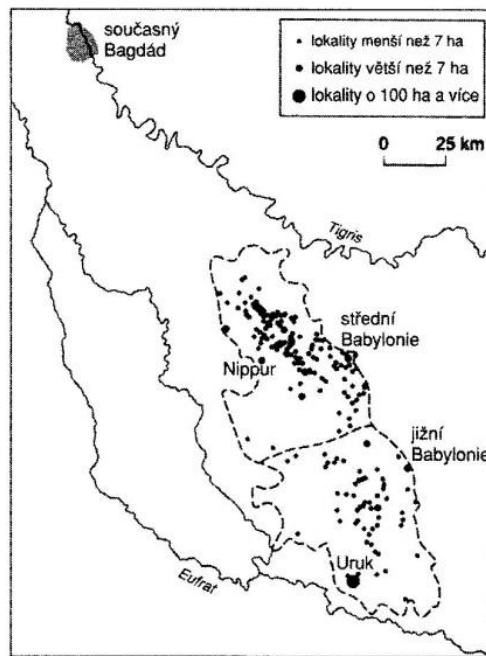

Fig. 5.1 Syria in the late sixth and fifth millennia BC, with the main Ubaid sites mentioned in the text.



(a) obejdské období



(b) rané urucké období

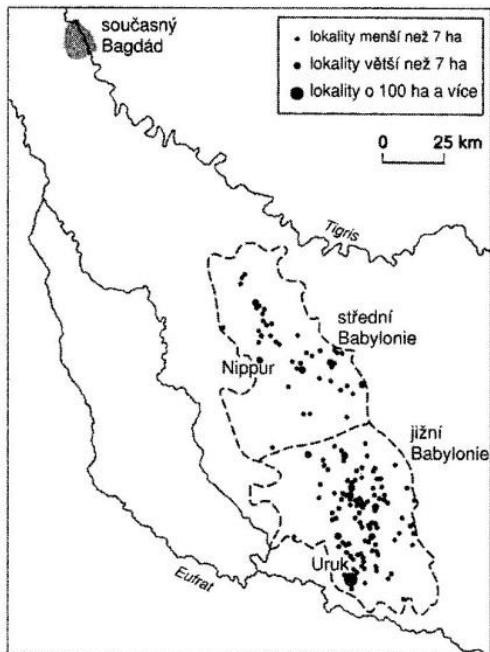

(c) pozdní urucké období

Osídlení J Mezopotámie

Hmotná kultura urucké kultury



URUK, Warka

Pozdní Uruk IV, ca. 3200-3000 BC

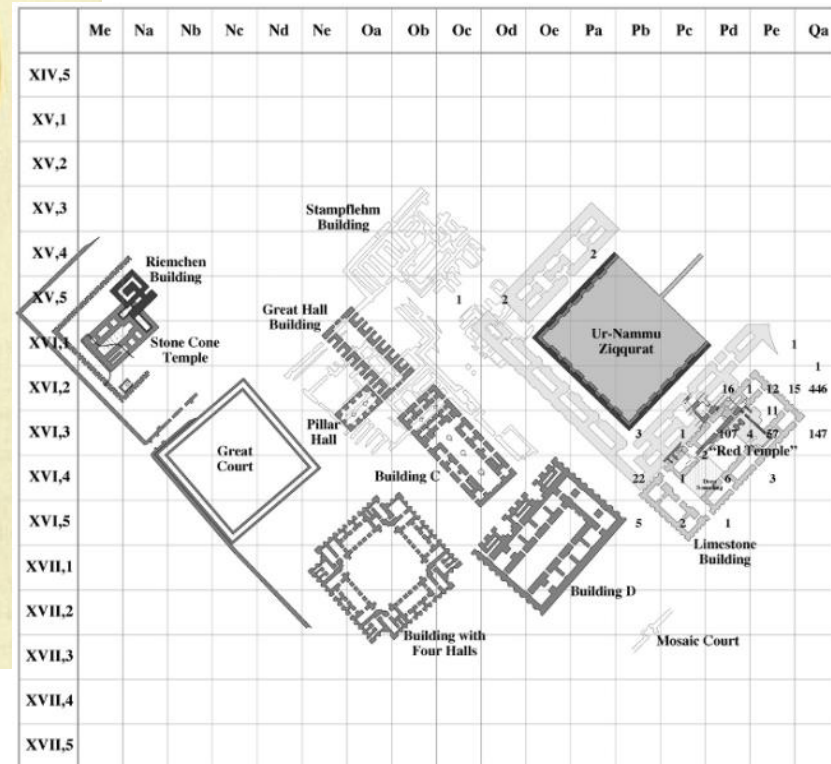
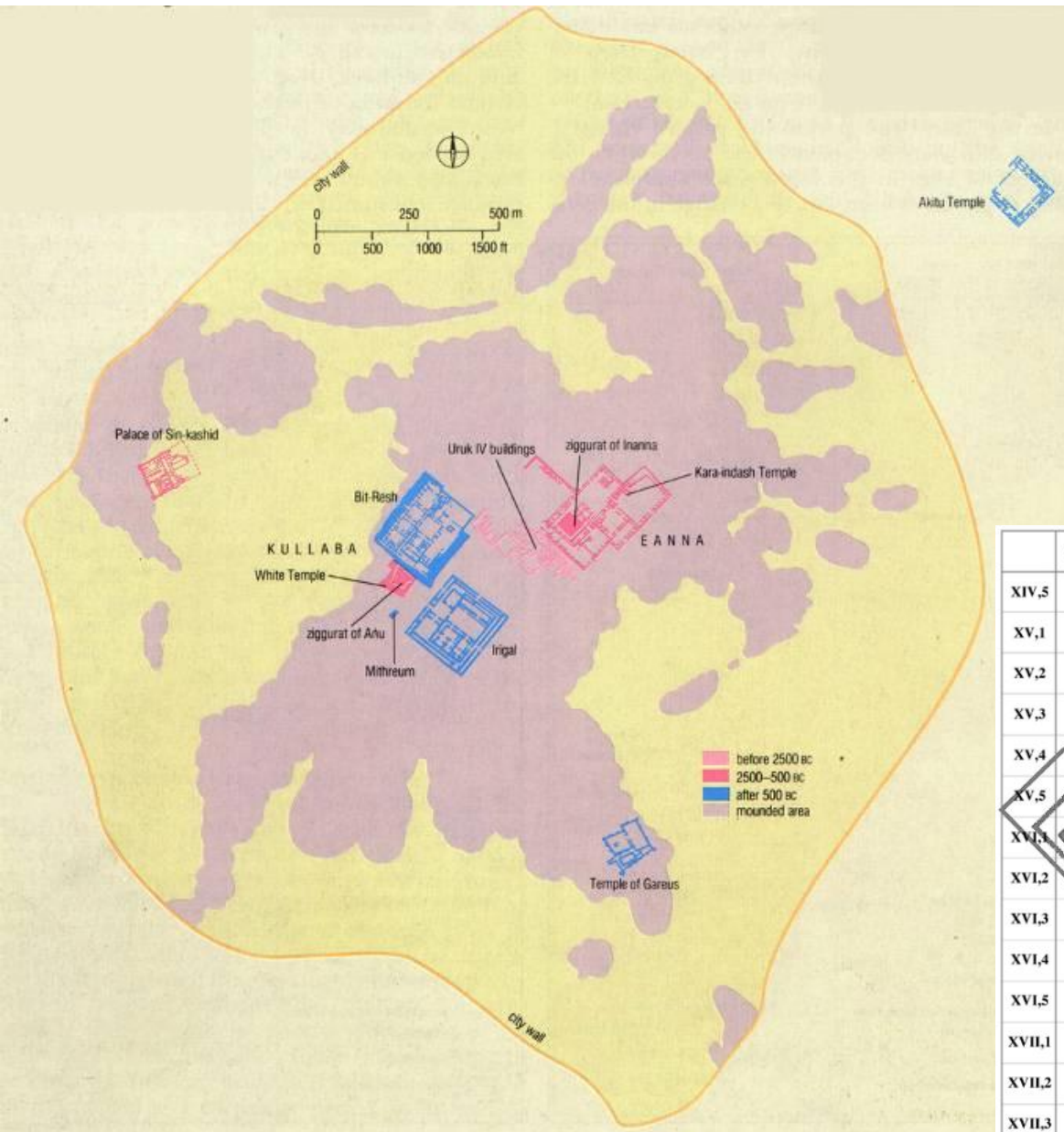

Urucká expanze

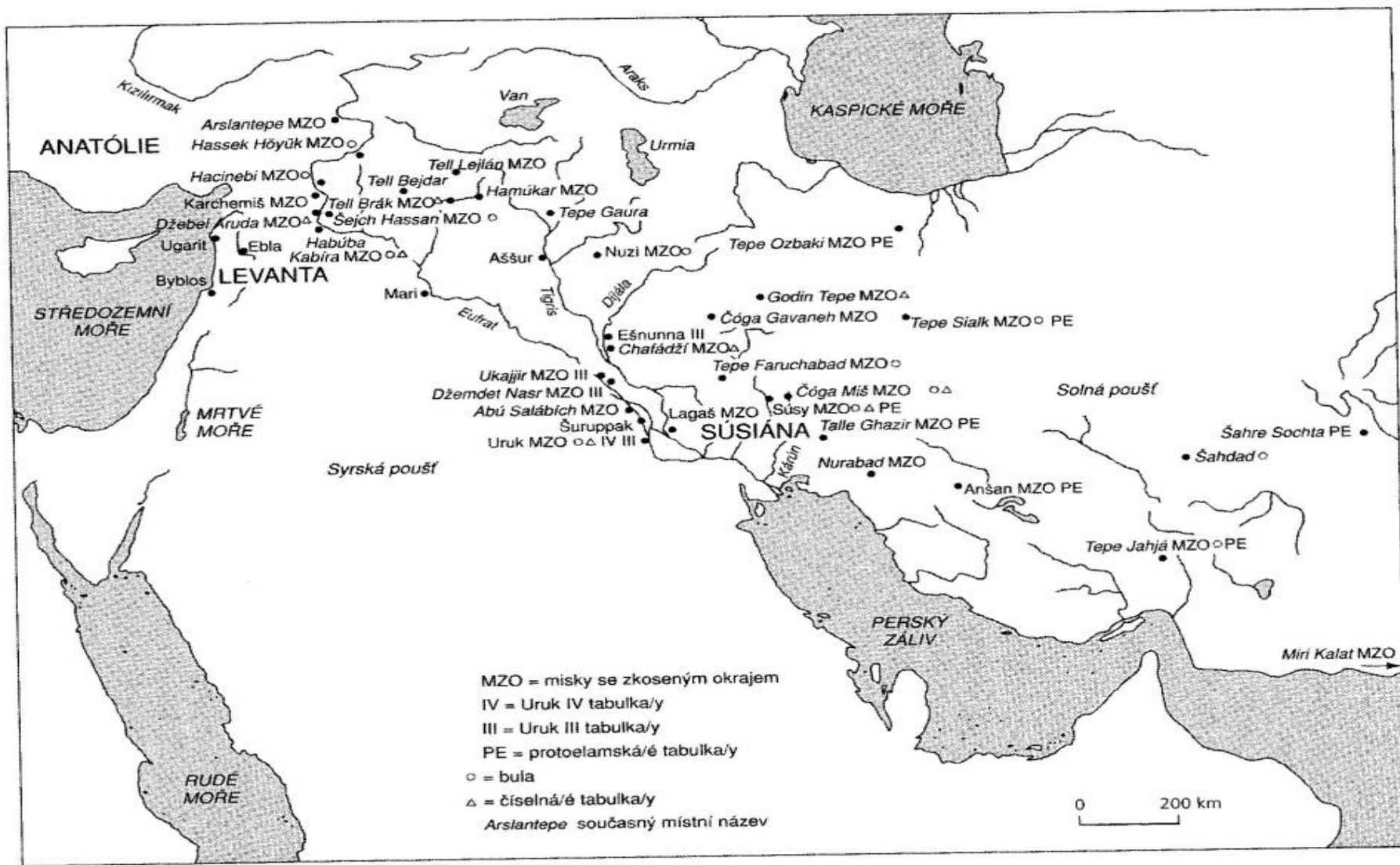

Urucký horizont v Sýrii

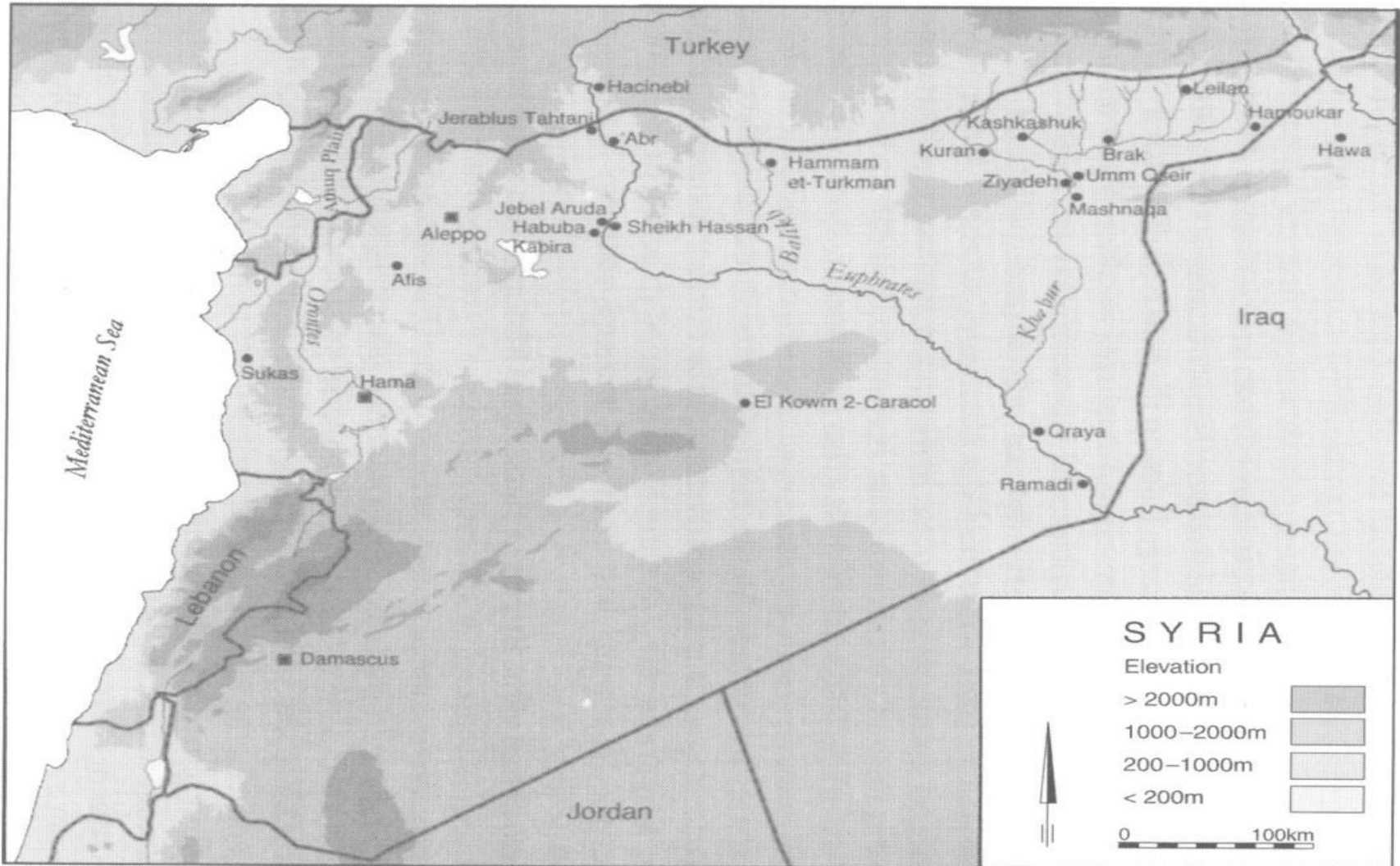
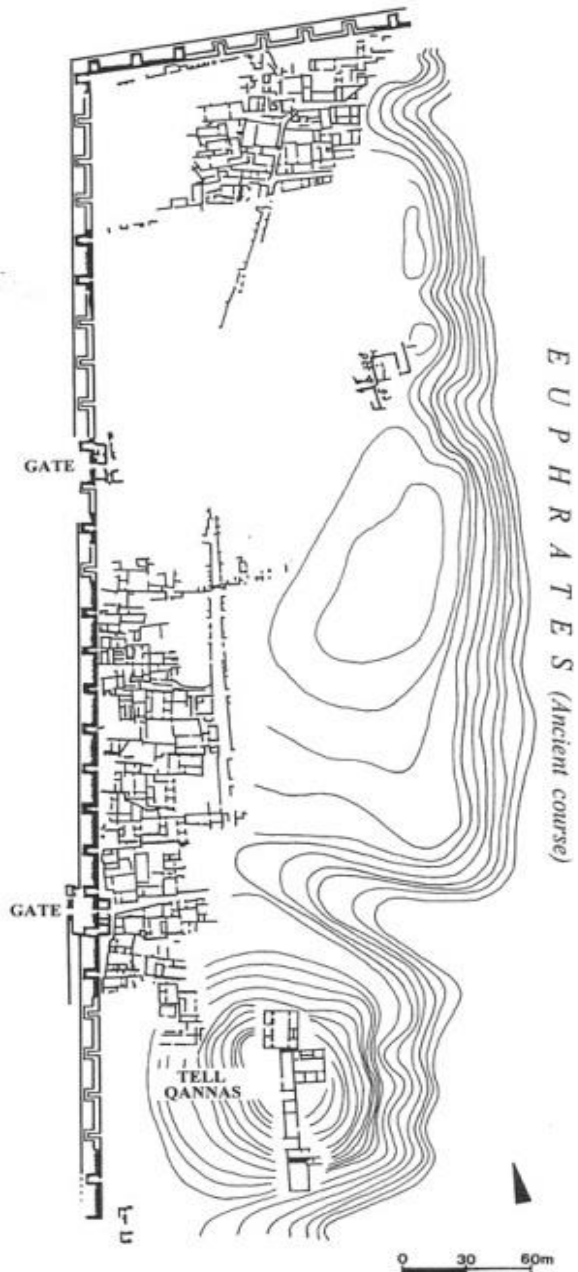

Fig. 6.1 Syria in the fourth millennium BC.

Habuba Kabira

- Střední Eufkrat



TELL BRAK

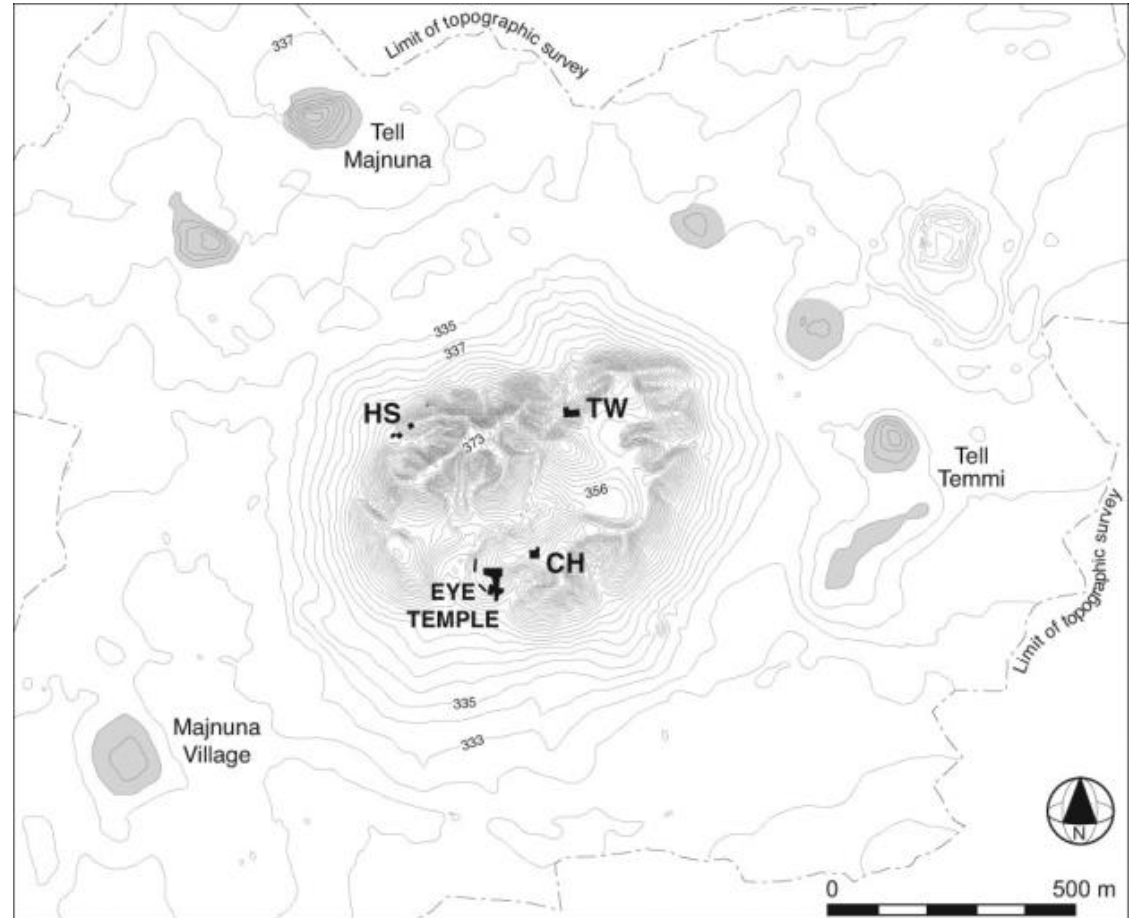
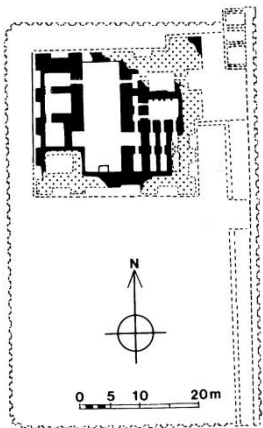
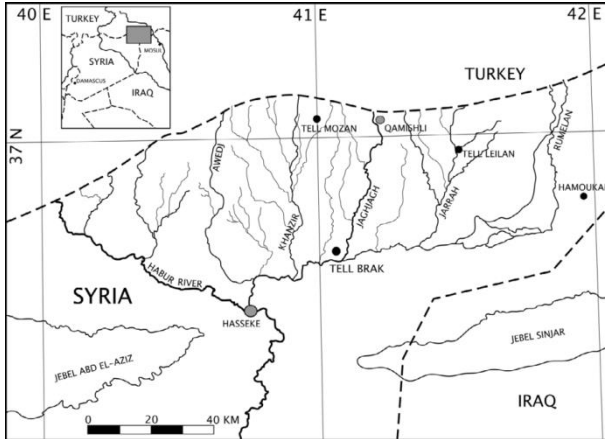

DŽEMDET NASR KULTURA

