



EUROPEAN UNION



MINISTRY OF EDUCATION  
YOUTH AND SPORTS



INVESTMENTS IN EDUCATION DEVELOPMENT

# THE EARLY BRONZE AGE IN THE NEAR EAST

## EB in the Upper Euphrates Region

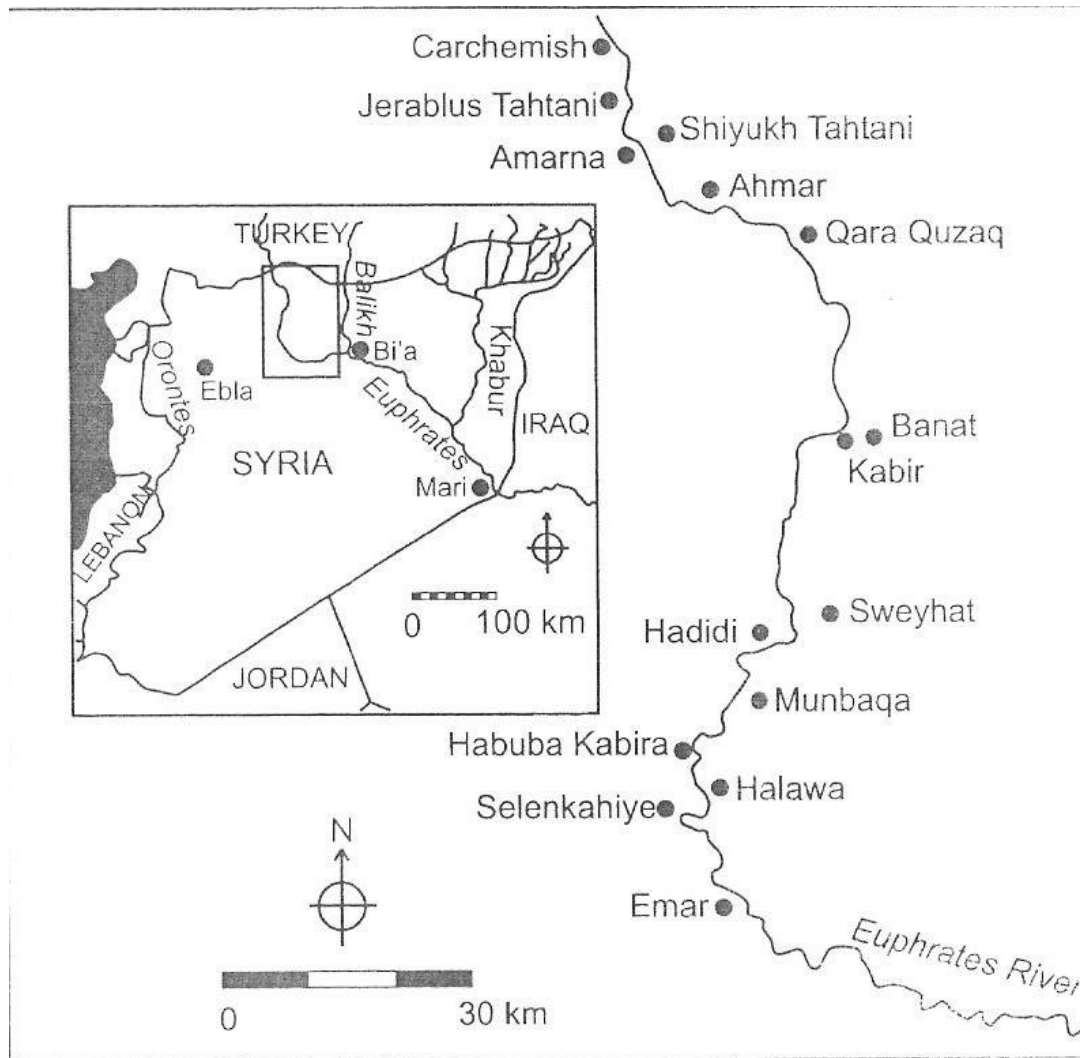

Figure 1.1 Locator map of Syria (left), and map of Euphrates River, with principal EB sites (right).



# Ceramic sequence in the Upper Euphrates region: base for a regional relative chronology

- Phase 1-2: 3200-2600
- Phase 3: 2600-2450
- Phase 4: 2450-2300
- Phase 5: 2300-2100
- Phase 6: 2100-1900 (EB/MB)



# Pottery assemblages phases 1-2

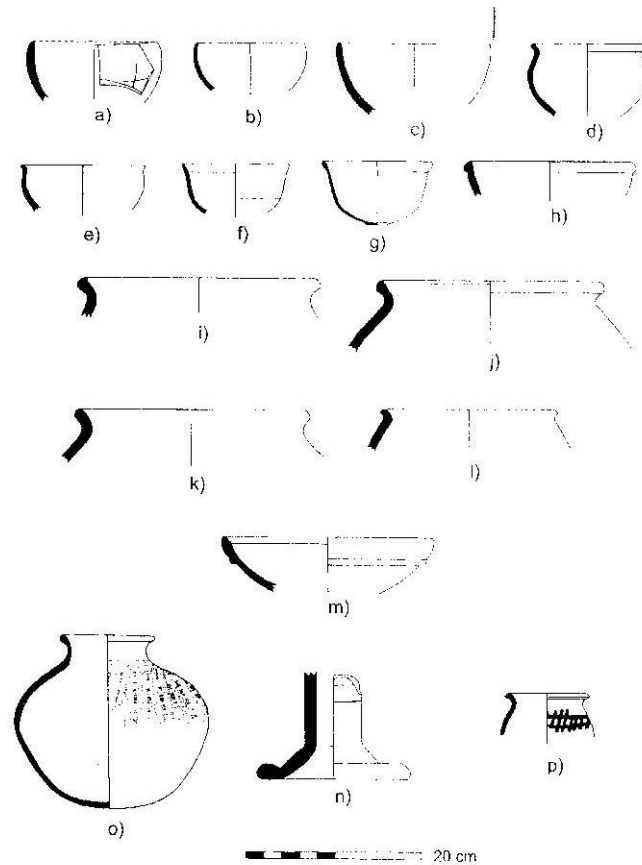

Figure 1.2 Phase 1-2 pottery.

# Pottery assemblage phase 3: Euphrates banded ware

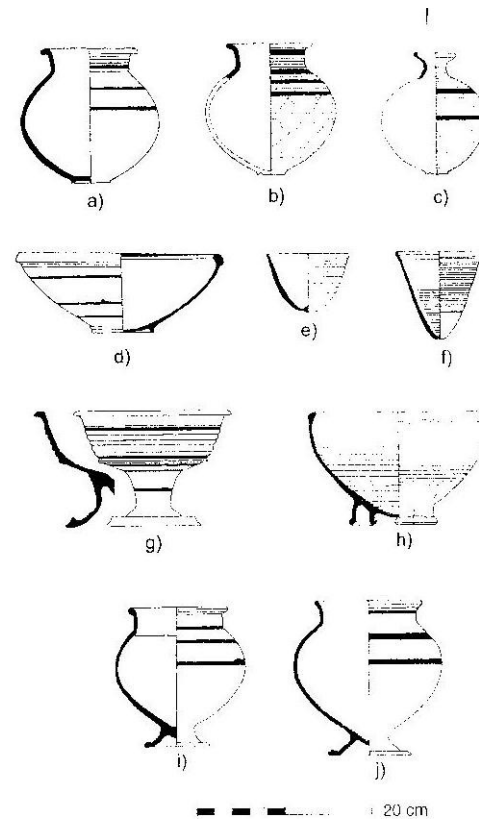

Figure 1.3 Phase 3 pottery: Euphrates line wares.

# Pottery assemblage phase 4

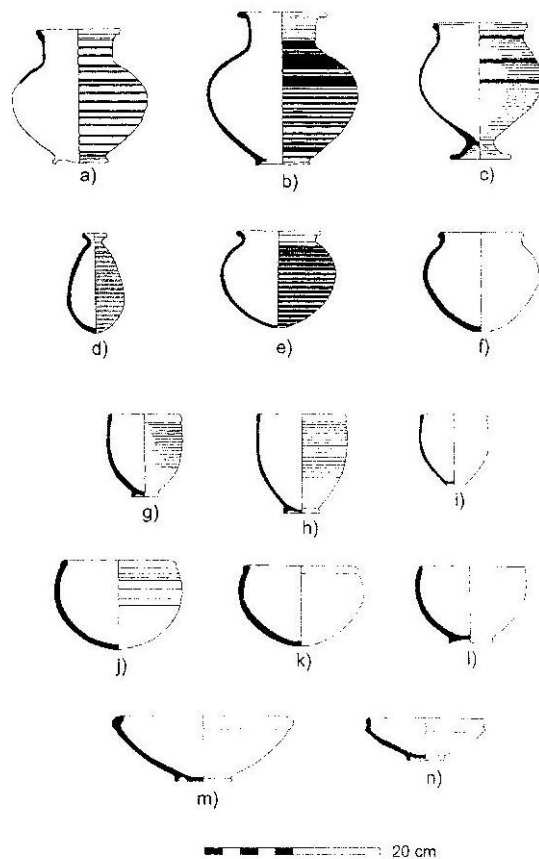

Figure 1.5 Phase 4 pottery: fine and plain simple wares.

# EBA Habuba Kebira fortification system

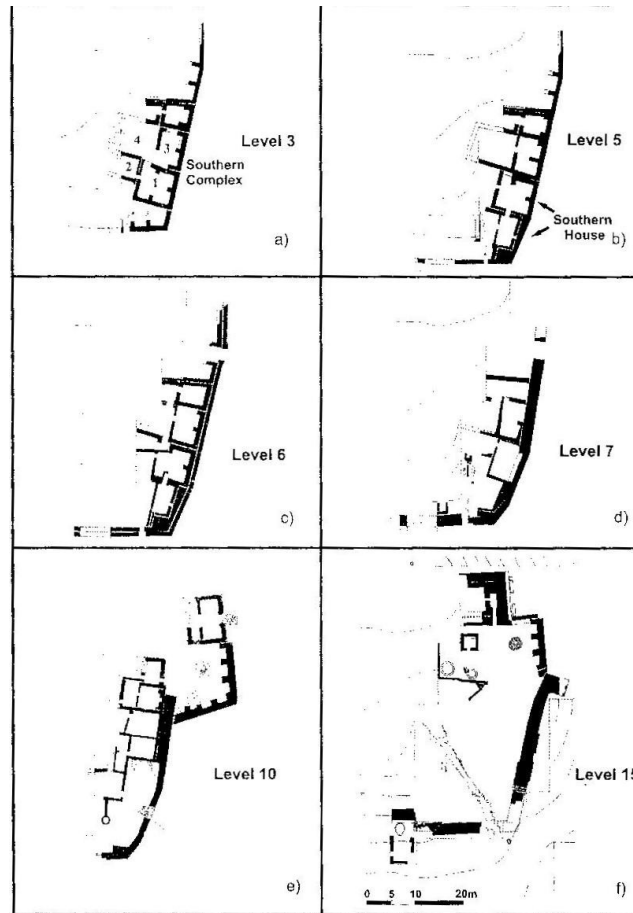

Figure 5.5 Houses at Tell Habuba Kabira.

# Residential quarters in Selenkahiye (left) and Halawa A (right)

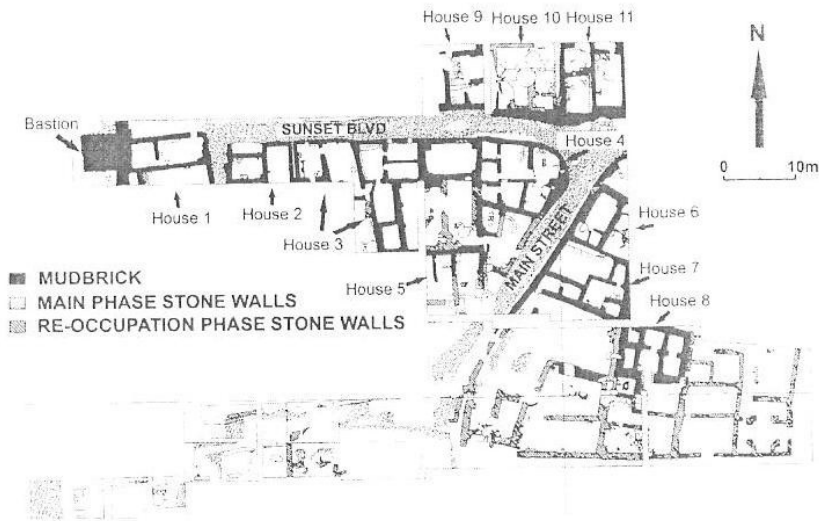

Figure 5.12 Housing in Central Town Area, Selenkahiye.

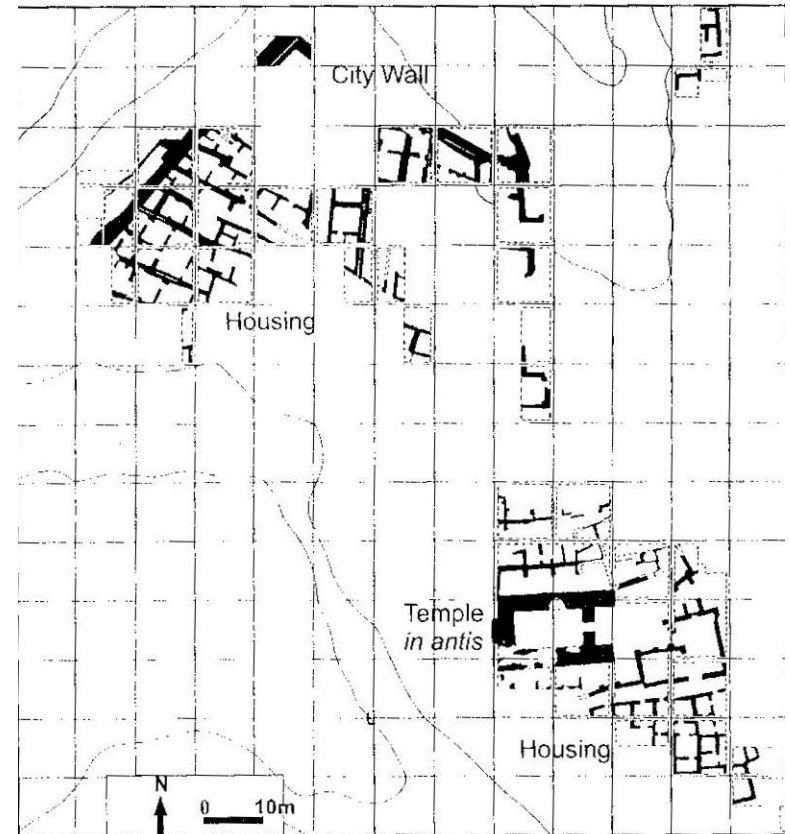

Figure 5.9 EB settlement, level 3, Halawa Tell A.



# Tell Banat – Public Building (2600-2300 BC)

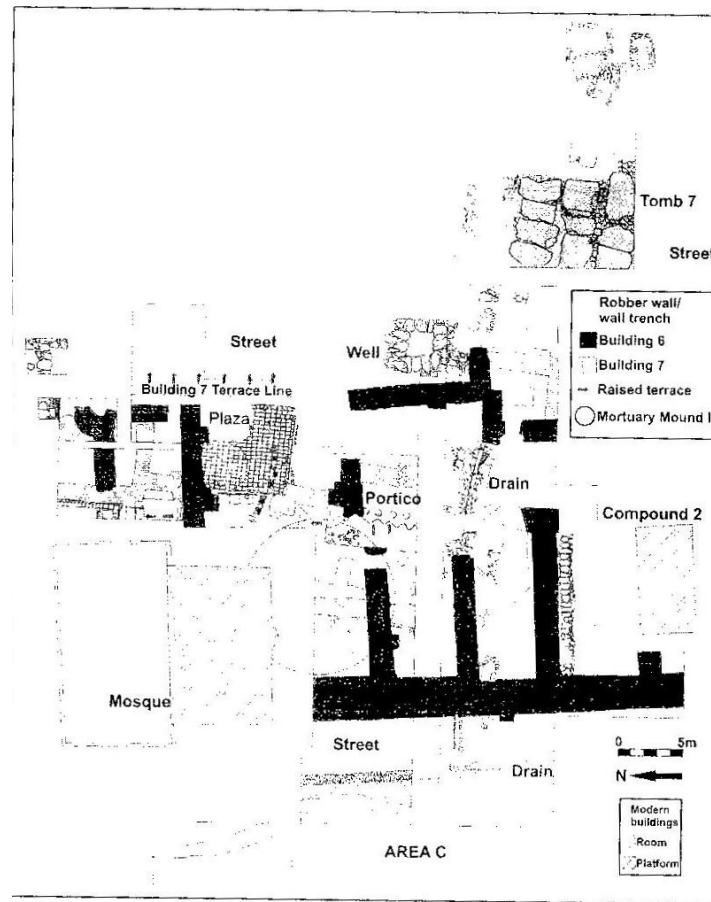

Figure 6.1 Buildings 6 and 7, Tell Banat.

# Selenkahiye – „Southern Mansion” (2400-2100 BC)

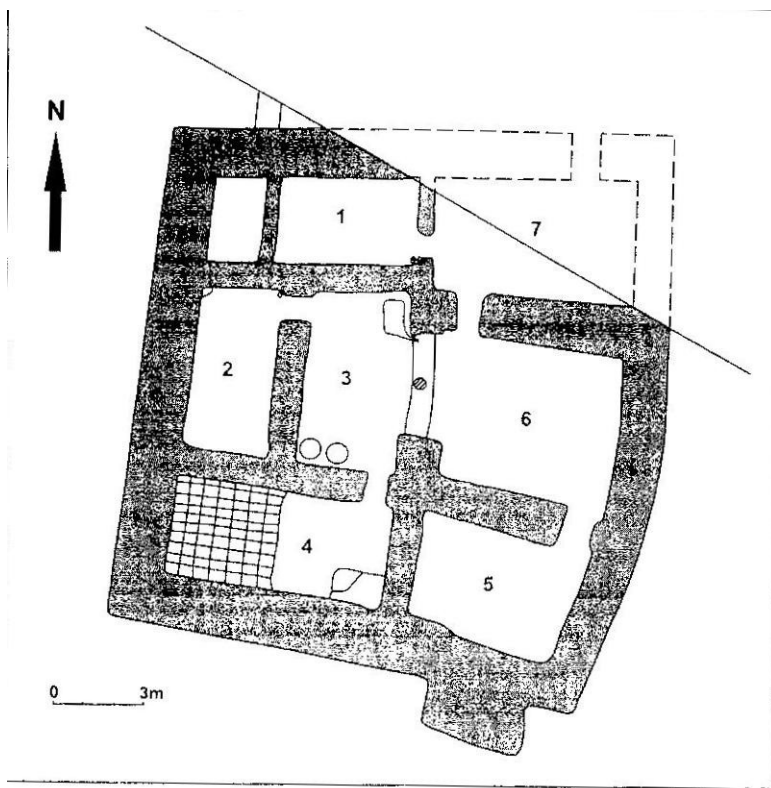

Figure 6.2 Southern Mansion, Selenkahiye (local phase 7).

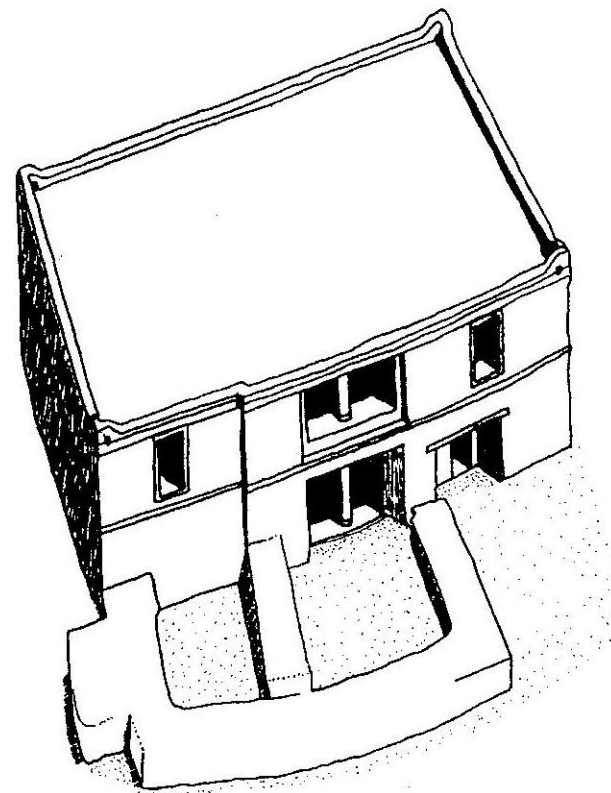

Figure 6.3 Reconstruction of Southern Mansion.

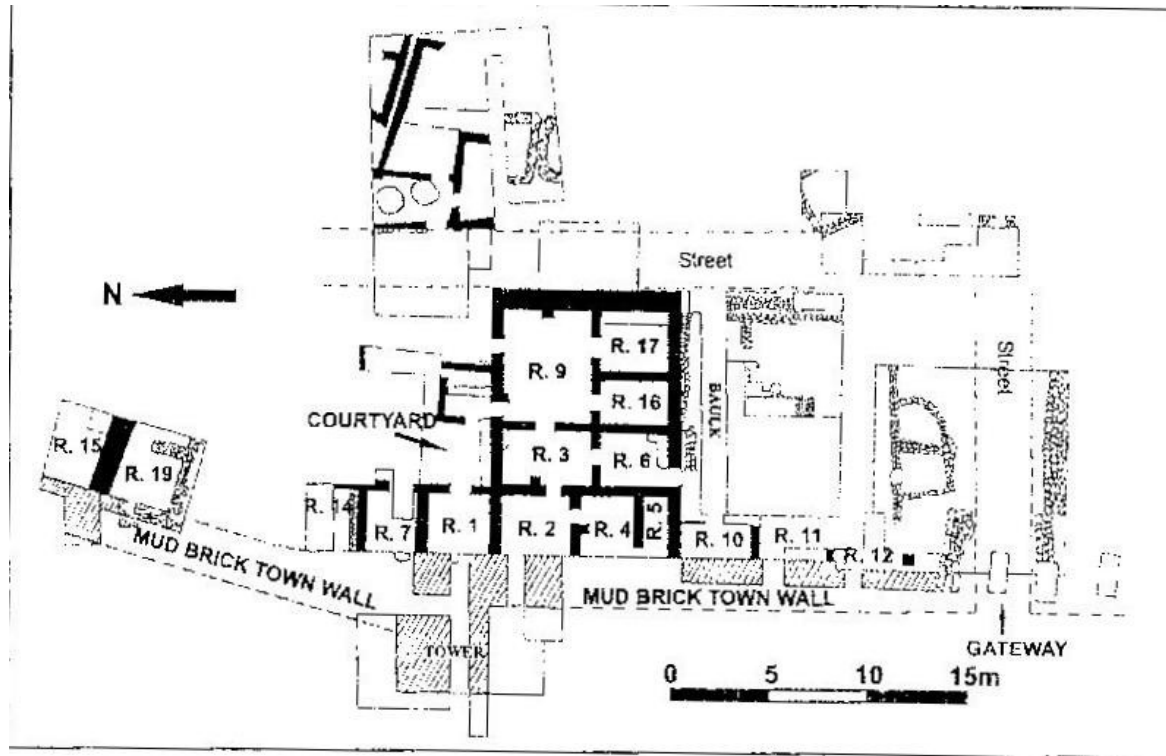

Figure 6.4 Area IV 'Burned Building' complex, Tell es-Sweihat.

# Tell Halawa B (3200-2600 BC) sacral complex?

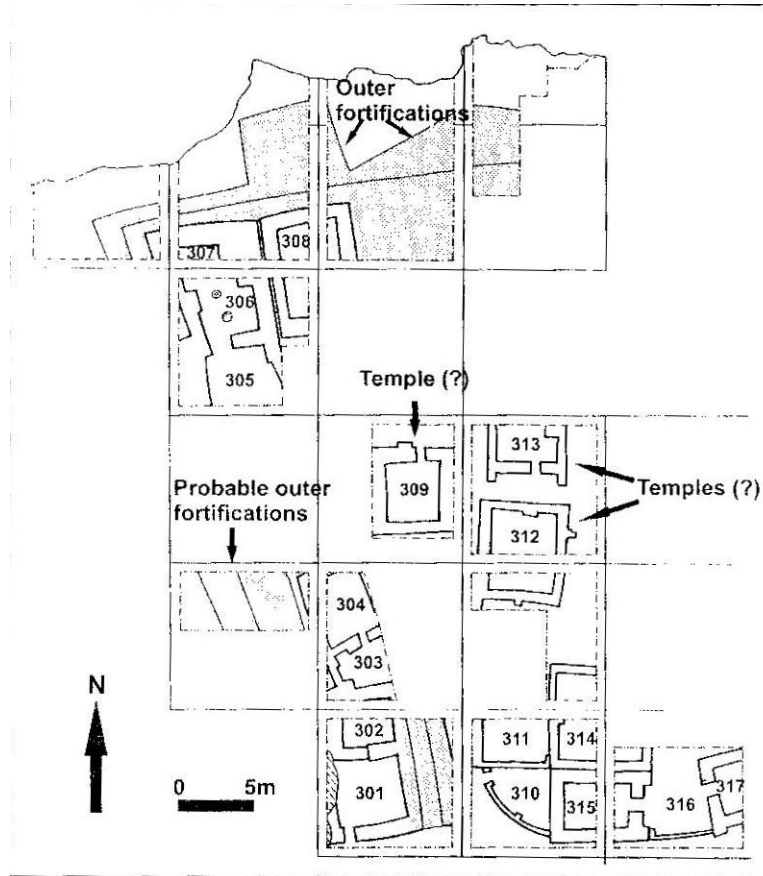
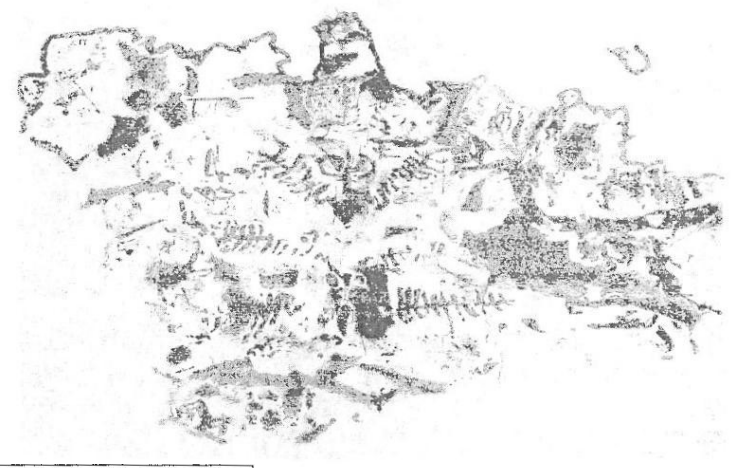

Figure 5.1 Early EB settlement at Halawa Tell B.

# Tell Halawa B wall paintings (3200-2600)



Figure 5.2 Wall painting from Room 312, Halawa Tell B.



in room (101) in house, Halawa Tell B.

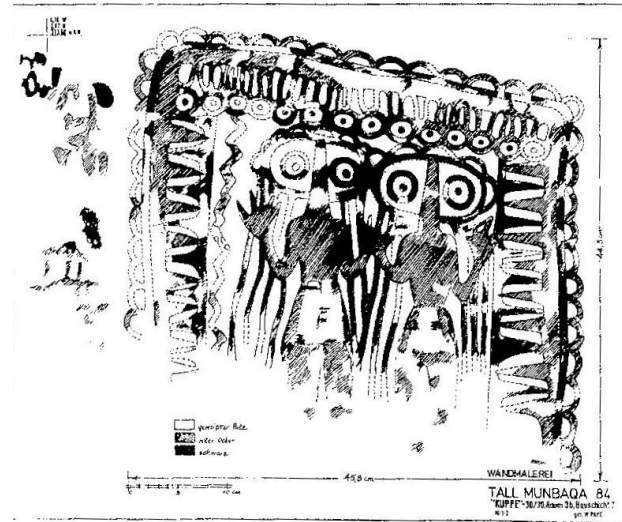

Figure 5.4 Wall painting in Room 3b in structure on 'Kuppe' at Munbaga.

# Halawa B sacral complex

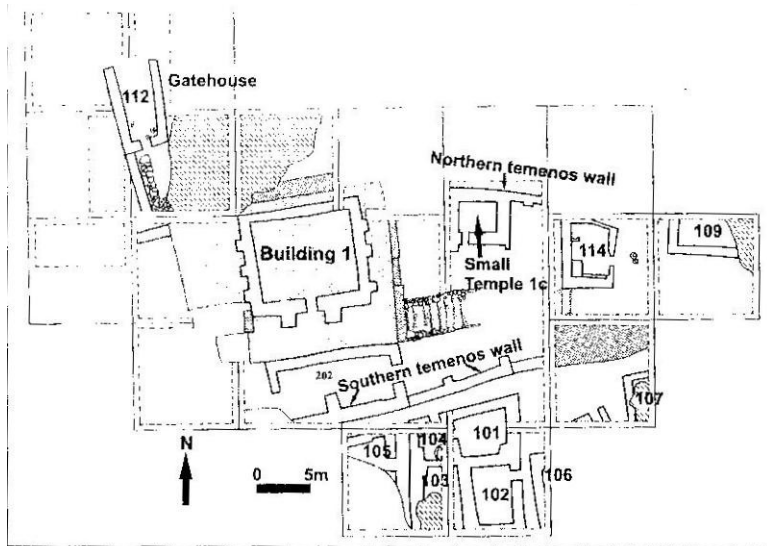

Figure 7.2 Temple complex (Period II, level 1), Halawa Tell B.

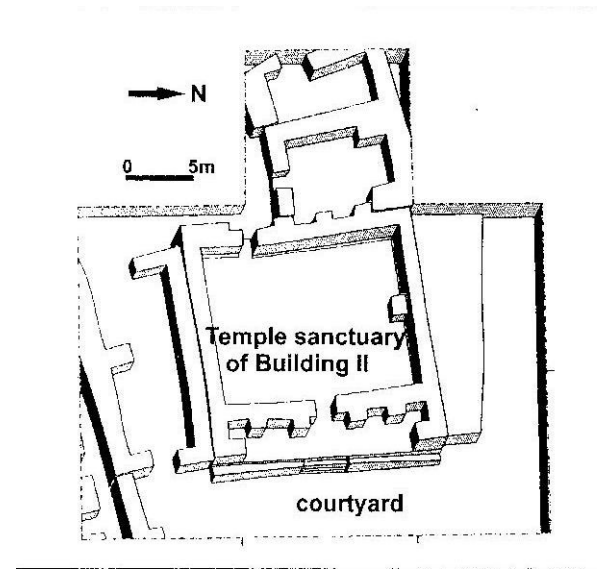

Figure 7.1 Building II of temple complex (Period II, level 2), Halawa Tell B.

# Qara Quzaq – a temple

COMMUNAL PLACES OF WORSHIP

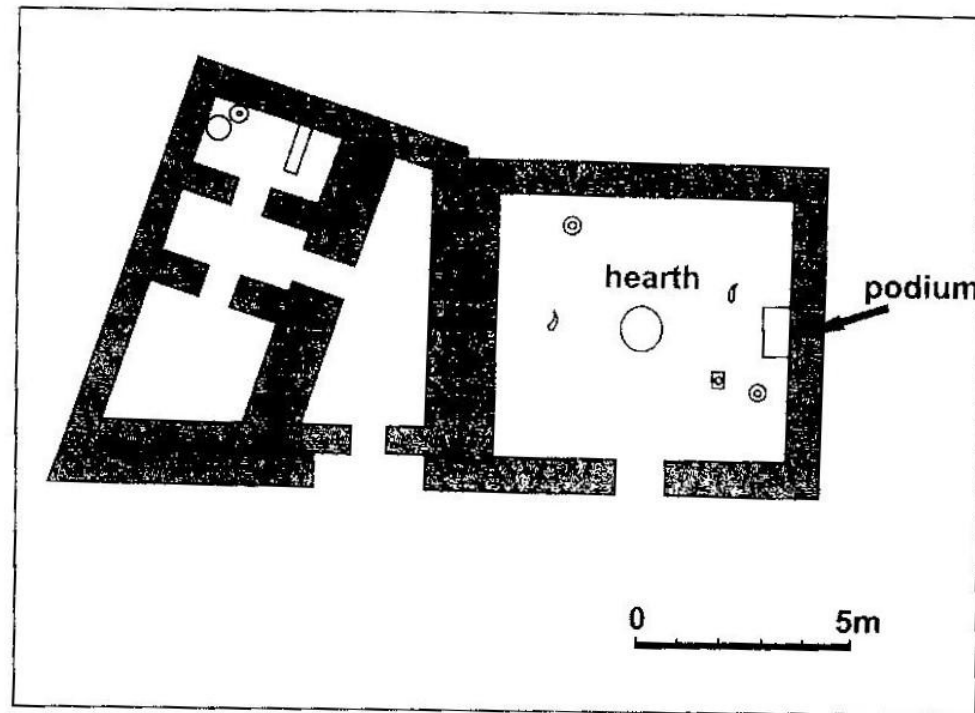

Figure 7.3 Temple L.247, Qara Quzaq (local level V).

# Halawa A – temple in antis (2400-2100 BC)

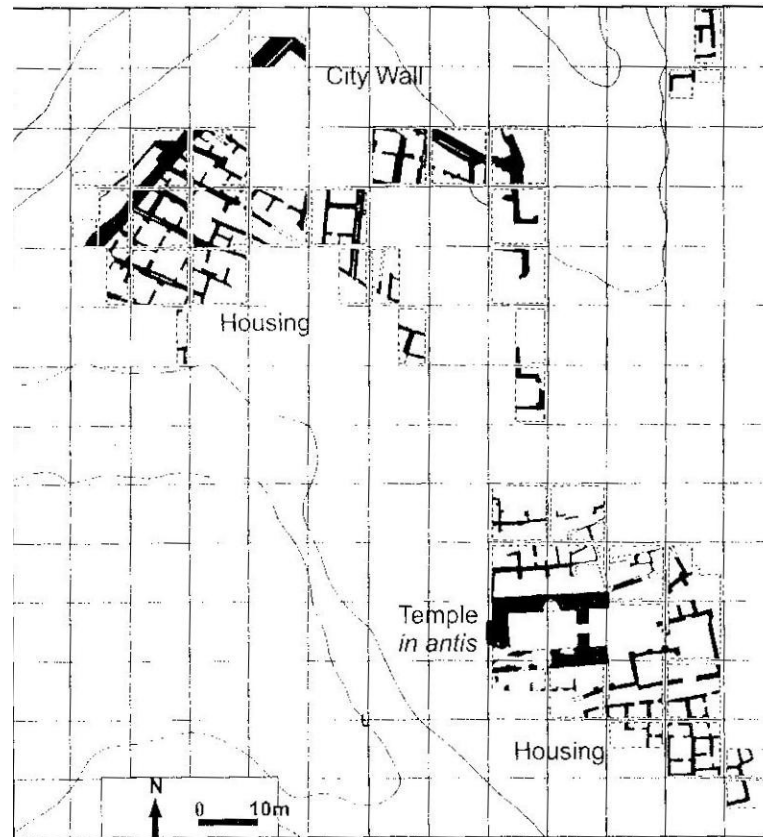

Figure 5.9 EB settlement, level 5, Halawa Tell A.



# Tell Halawa A temple in antis

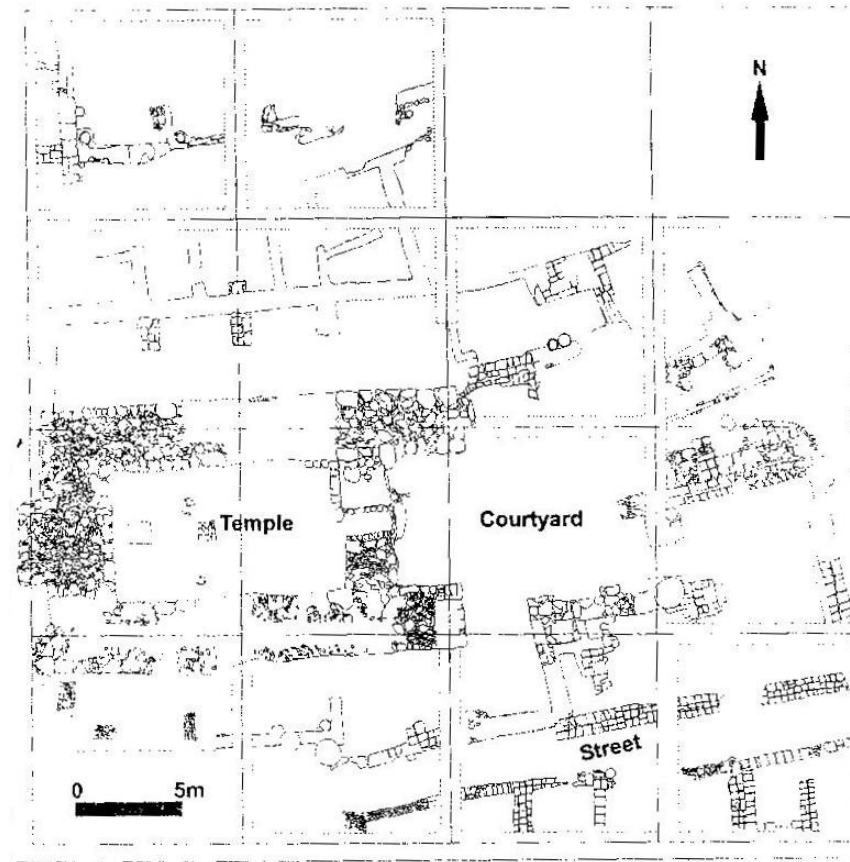

Figure 7.4 Temple in antis, Halawa Tell A.

# Tell Halawa A – a stele found in a temple



Figure 7.5 Stele (I), found in temple in antir, Halawa Tell A.  
european  
social fund in the  
czech republic



EUROPEAN UNION



MINISTRY OF EDUCATION  
YOUTH AND SPORTS



OP Education  
for Competitiveness



INVESTMENTS IN EDUCATION DEVELOPMENT

TELL BANAT – TOMB 7 (top) THE WHITE MONUMENT - funeral mound associated with a cult of the deceased (bottom) (2600-2450)

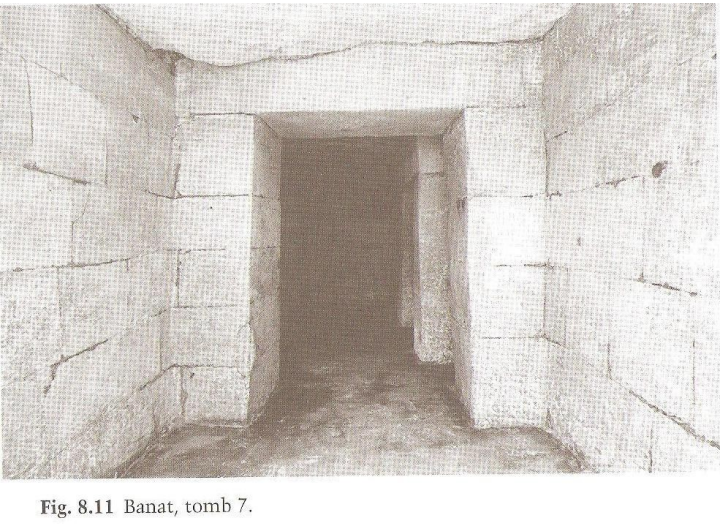
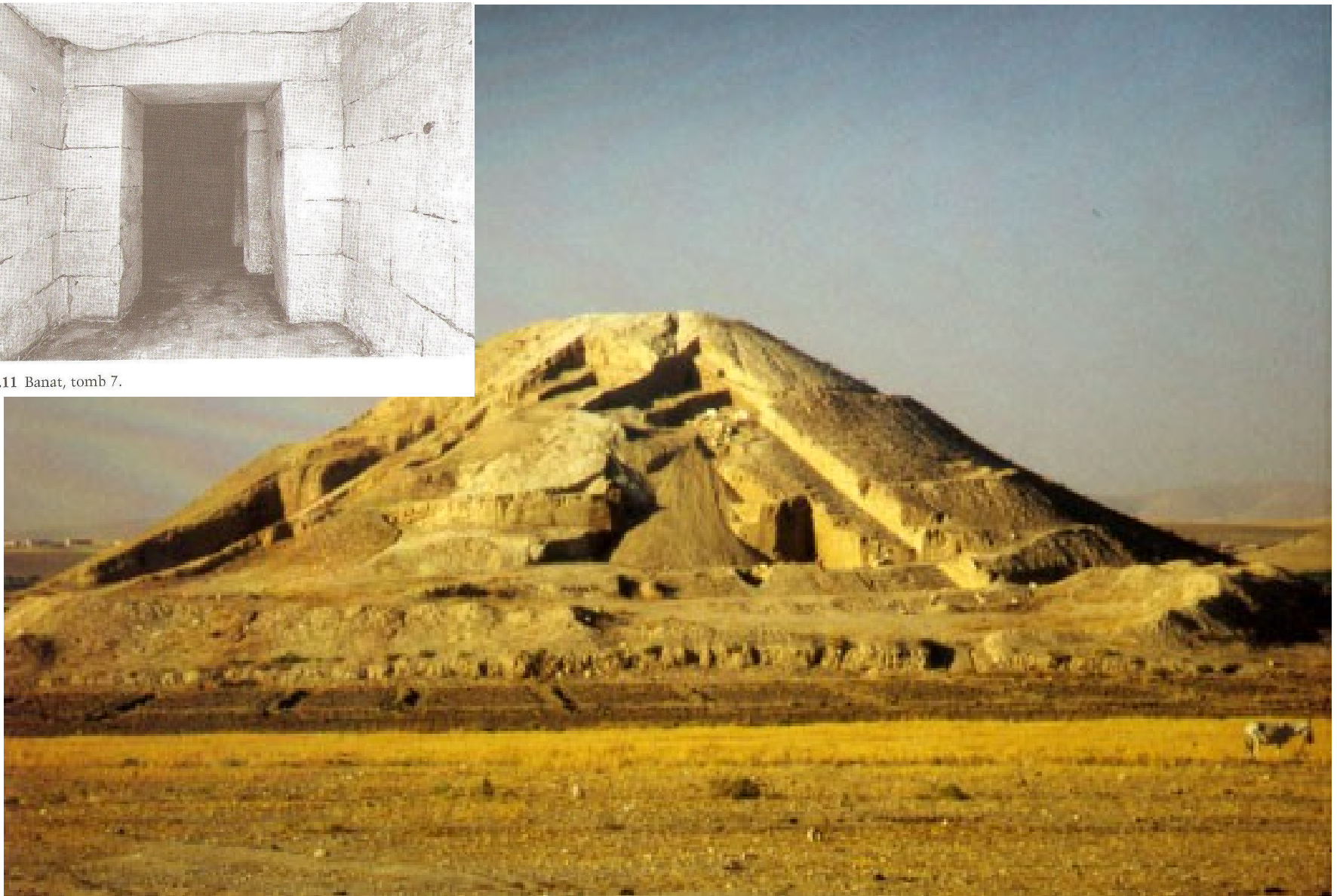

Fig. 8.11 Banat, tomb 7.



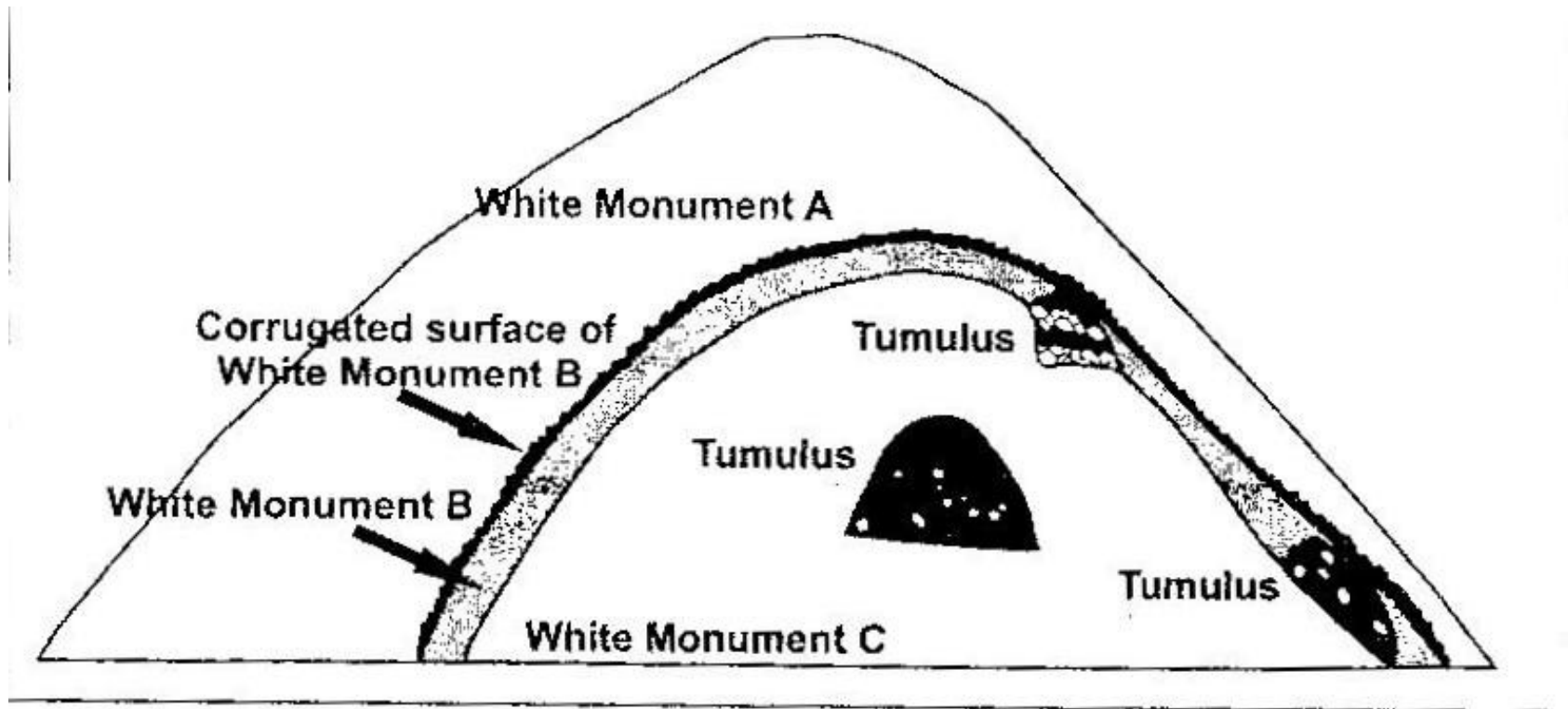

Figure 9.16 Schematic section of the White Monument, Tell Banat North.