

IV. Egyptian Art

Part 1: Kings, Power, and the Divine

DU1701 Periods of Art History I
Adrien Palladino, M.A., Ph.D.
450842@mail.muni.cz



c. 3100 BCE ‘Unification’ of Egypt under King Narmer (or Menes)

c. 2800–2200 BCE Old Kingdom
(Memphis capital)

c. 2200–2052 BCE Intermediate Period

c. 2052–1567 BCE Middle Kingdom
(Thebes capital)

c. 1567–1085 BCE New Kingdom
(Thebes capital, except during the Amarna period)

c. 1085–713 BCE Intermediate Period

c. 712–332 BCE Late Period
(foreign dynasties: Nubian, Lybians, Persian)

c. 332–30 BCE Ptolemaic Period



Alexandria (founded
331 BCE)

Cairo (Al-Qāhira)

Memphis

Faiyum
Shedet / Krokodilopolis / Arsinoë

Amarna

Waset / Thebes
Luxor and Karnak
(Valley of the Kings)

Nekhen / Hierakonpolis

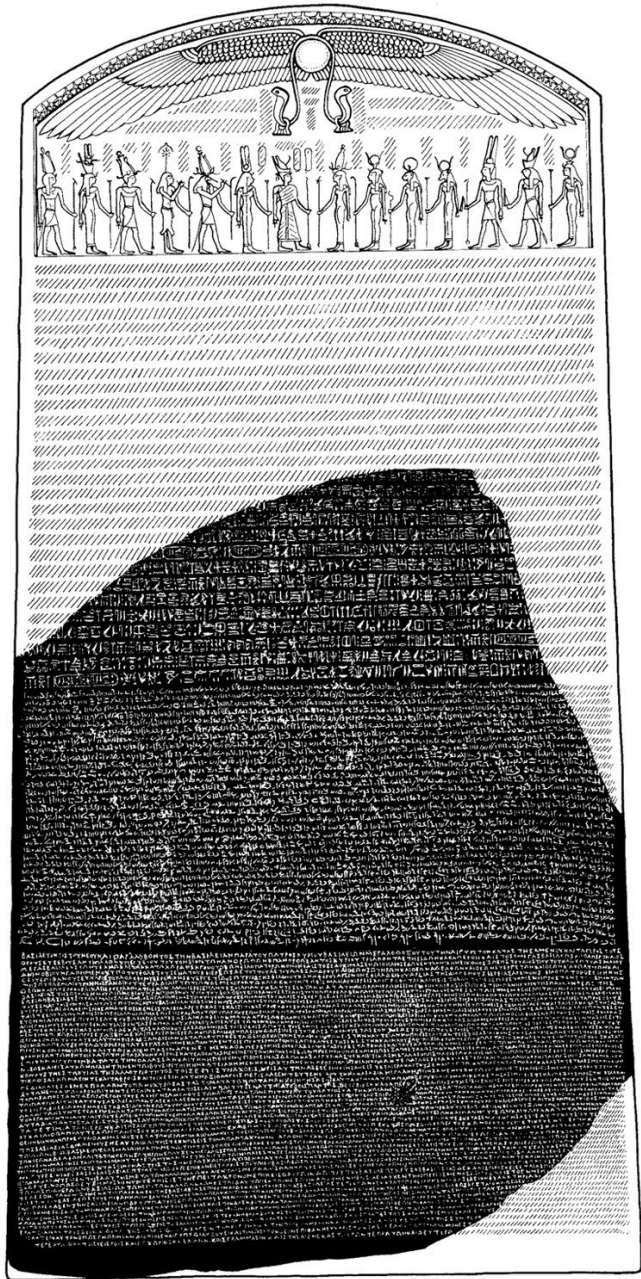
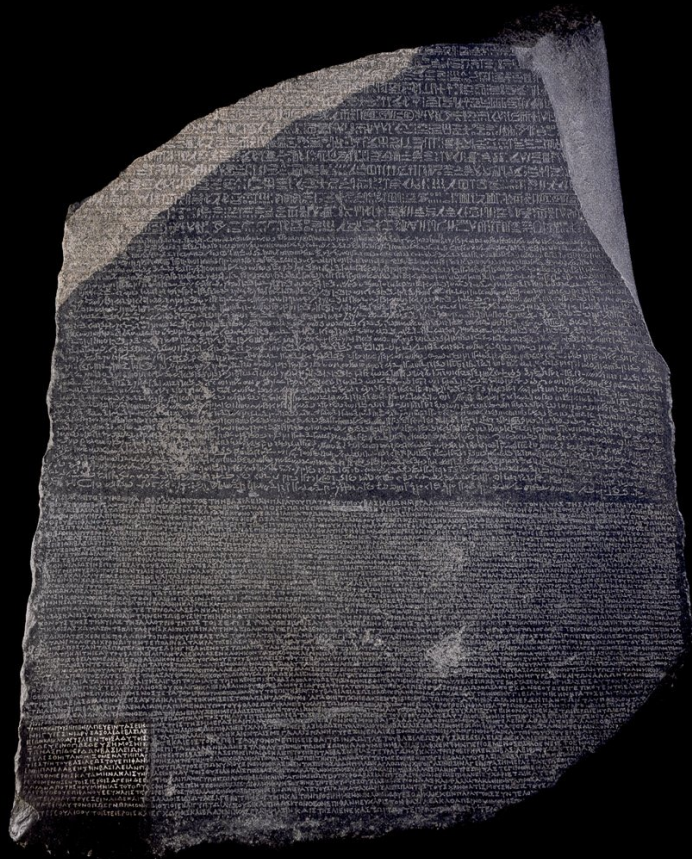

<p style="text-align: right;">Pl. IV.</p> <h2 style="text-align: center;">Tableau des Signes Phonétiques</h2> <p style="text-align: center;">des Ecritures Hiéroglyphique et Démotique des anciens Egyptiens</p>		
Lettrier Phonétique	Signes Démotiques	Signes Hiéroglyphiques
A	u. u.	
B	4. 2.	
Γ	κ. -	
Δ	< . <	
E	ι	
Z		
H	III. III. III. III.	
Θ		
I	α. III.	
K	κ. κ. κ. κ. κ.	
Λ	λ. λ. λ.	
M	μ. μ.	
N	ν. ν. - - -	
Ξ	ξ.	
O	ο. ο. ο. ο.	
Π	π. π. π. π. π.	
P	ρ. ρ. ρ.	
Σ	σ. σ. σ. σ. σ.	
T	τ. τ. τ. τ.	
Υ		
Φ	φ.	
Ψ		
X	χ.	
Ω		
TO. TA.		



Palette of King Narmer, from
Hierakonpolis, predynastic, ca.
3000-2920 BCE, ca. 63,5 cm
Cairo, Egyptian Museum



Palette in form of a fish, ca. 3000 BCE
8,7 x 18,5 x 1,5 cm
Kunsthistorisches Museum



Palette, Nagada III period, ca. 3150 BCE
British Museum – Ashmolean Museum

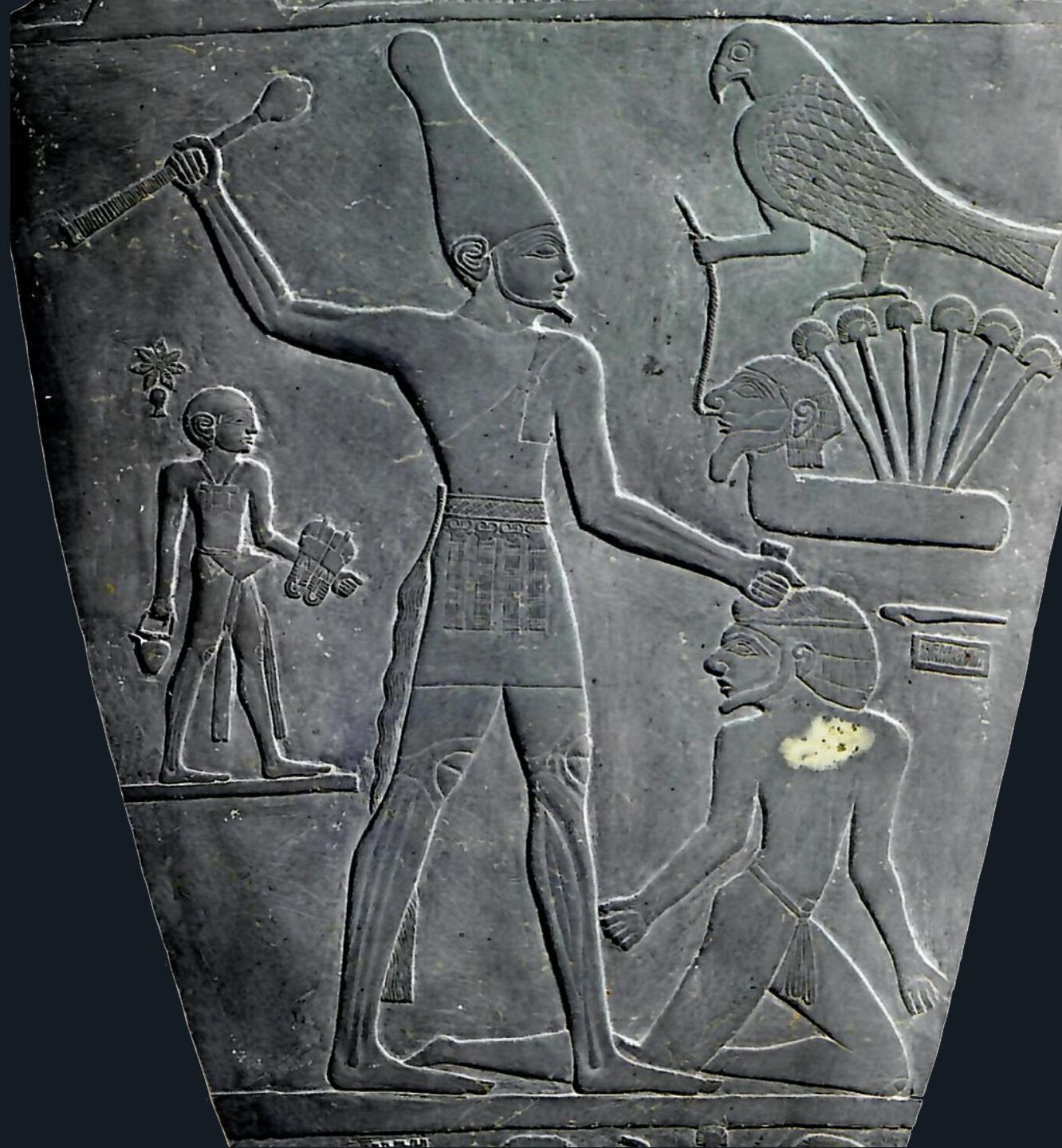

32169





Jasper cylinder seal with monstrous lions (serpopards) and eagles with lion heads, Uruk period, ca. 4100-3000 BCE
Paris, Musée du Louvre



(Left) the crown of Lower Egypt and (right) the crown of Upper Egypt, worn by King Sesostriis III, relief on door lintels at Madāmūd, ca. 1878–1843 BCE
Cairo, Egyptian Museum



Pharaoh Ptolemy VIII between the goddesses Wadjet (symbolizing lower Egypt) and Nekhbet (symbolizing upper Egypt) relief from the Temple of Edfu, Egypt, 2nd century BCE



Roman Emperor Trajan (ruled 98–117 BCE)
 offering to Hathor
 Roman Mammisi, Dendera Temple complex





Statue of King Haremheb with Horus ca. 1343–1315 BCE
153 x 73 x 77 cm place of origin unknown
Wien, Kunsthistorisches Museum



Osiris on a Throne, 7.8 x 6.9 x 15 cm
ca. 664-595 BCE
Baltimore, Walters Art Museum



Priest Holding the Figure of
Osiris, ca. 665-650 BCE
57 x 14 x 26 cm, from Karnak
Baltimore, Walters Art
Museum



Seated Scribe, ca. 2620–2500 B.C.E., Old Kingdom,
painted limestone, inlay for the eyes, found in Saqqara
Paris, Musée du Louvre



Scribe and Official, ca. 670-650
B.C.E. Limestone, pigment
(Egyptian blue, indigo), (18.4 ×
3.8 × 26.7 cm
Brooklyn Museum, Charles
Edwin Wilbour Fund, 49.18.



Scribe, Old Kingdom,
2400 BCE, 38,5 x 27,3 x
16,5 cm, pink granite
Wien, Kunsthistorisches
Museum

Haremhab royal scribe, New Kingdom, ca. 1336–1323 BCE, from Memphis
(?), granodiorite, H: 113 cm / New York, Metropolitan Museum



Pyramid of Djoser, Saqqara, ca. 2667–2648 BCE

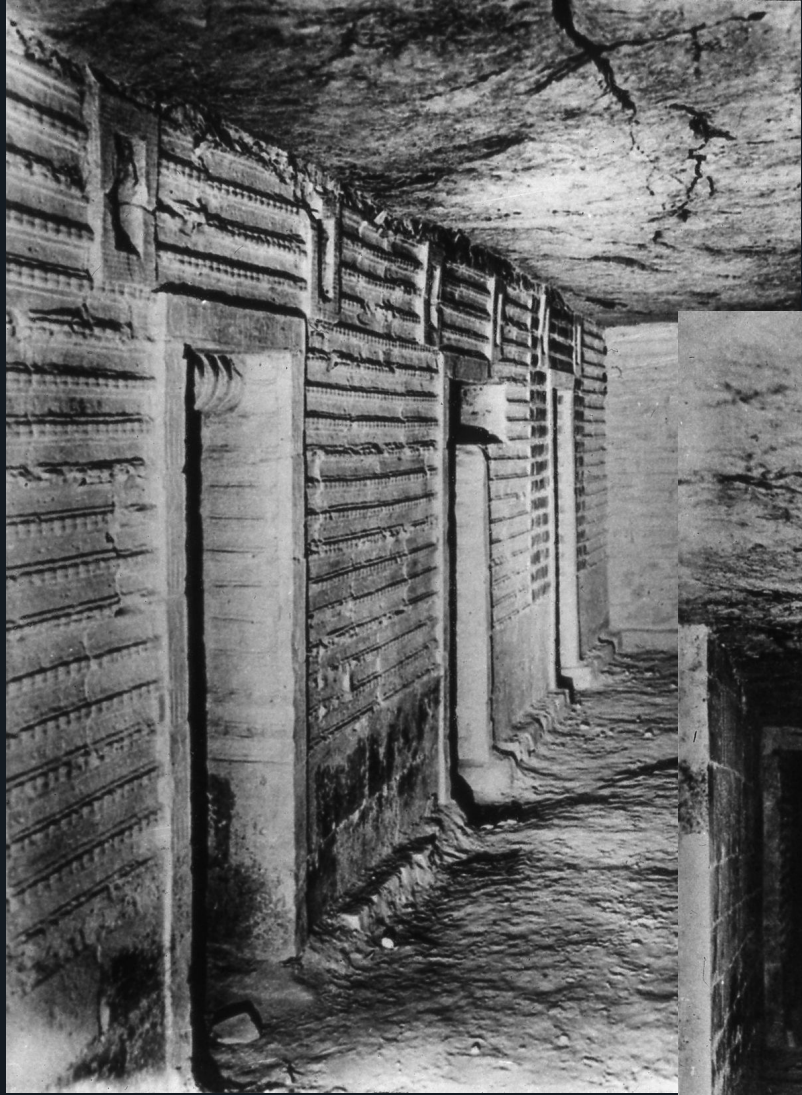

Wall tiles from the funerary apartments of
king Djoser, ca. 2630–2611 BCE

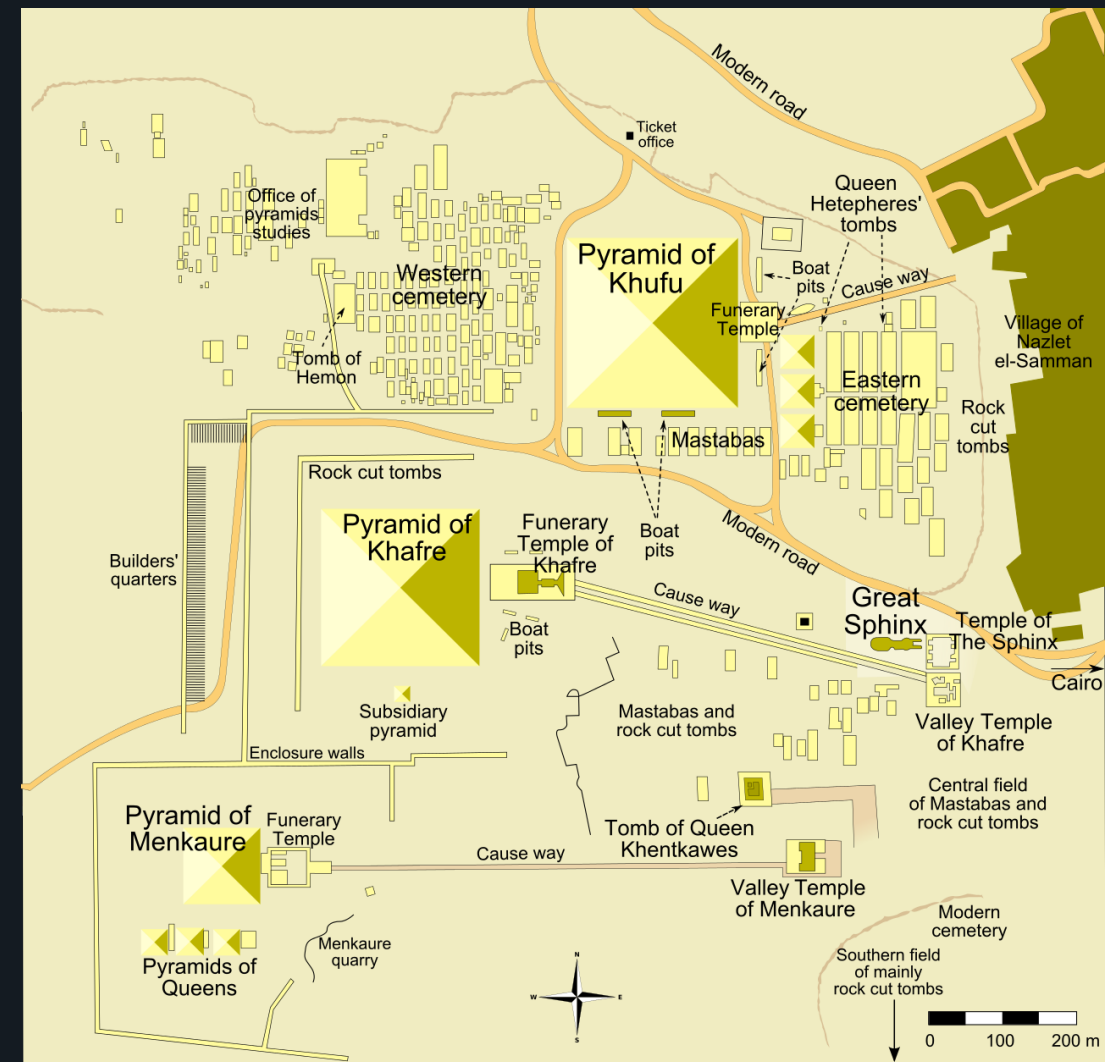
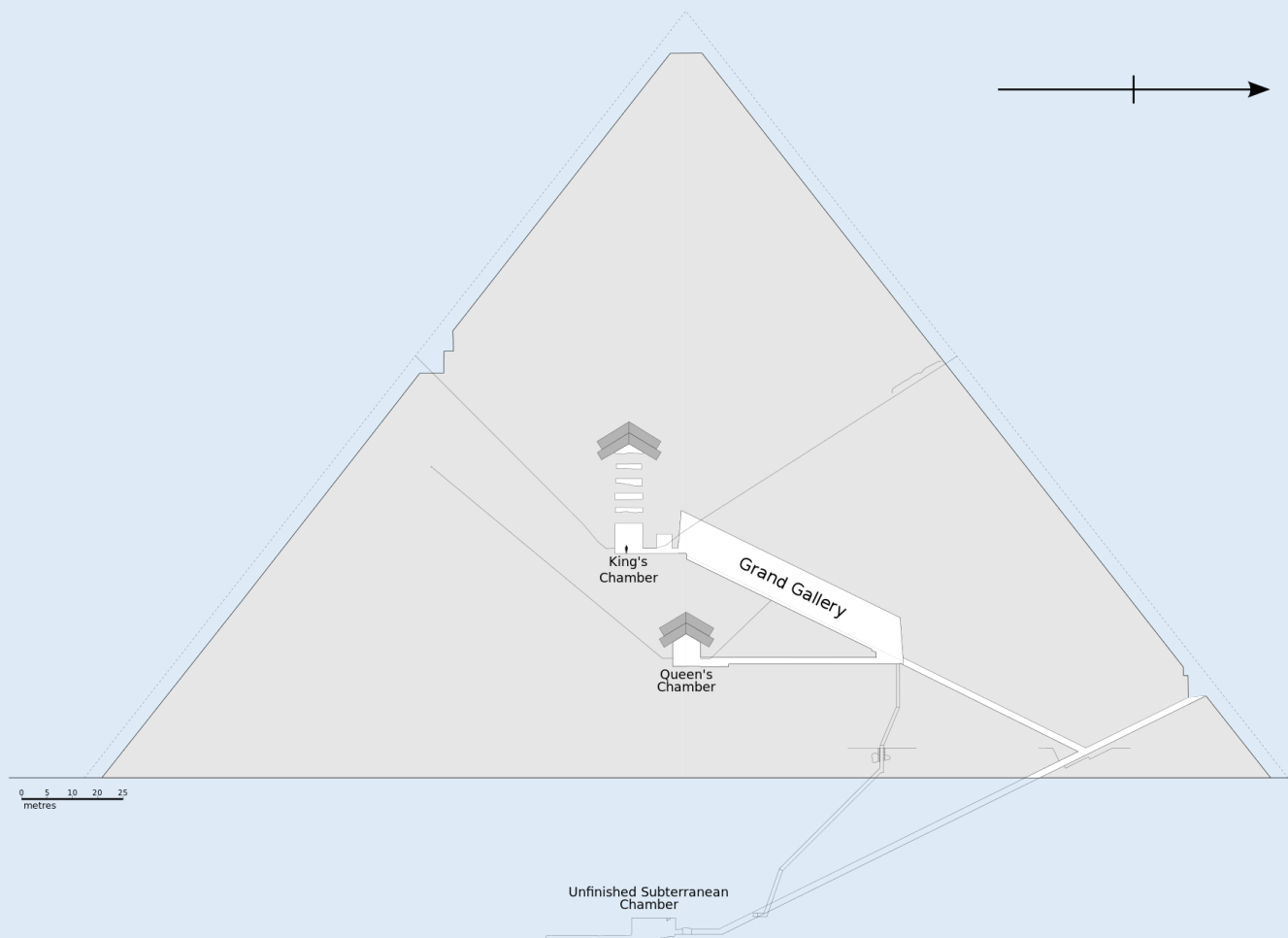

Great Pyramid of Giza, Pharaoh
Khufu, ca. 2580–2560 BC

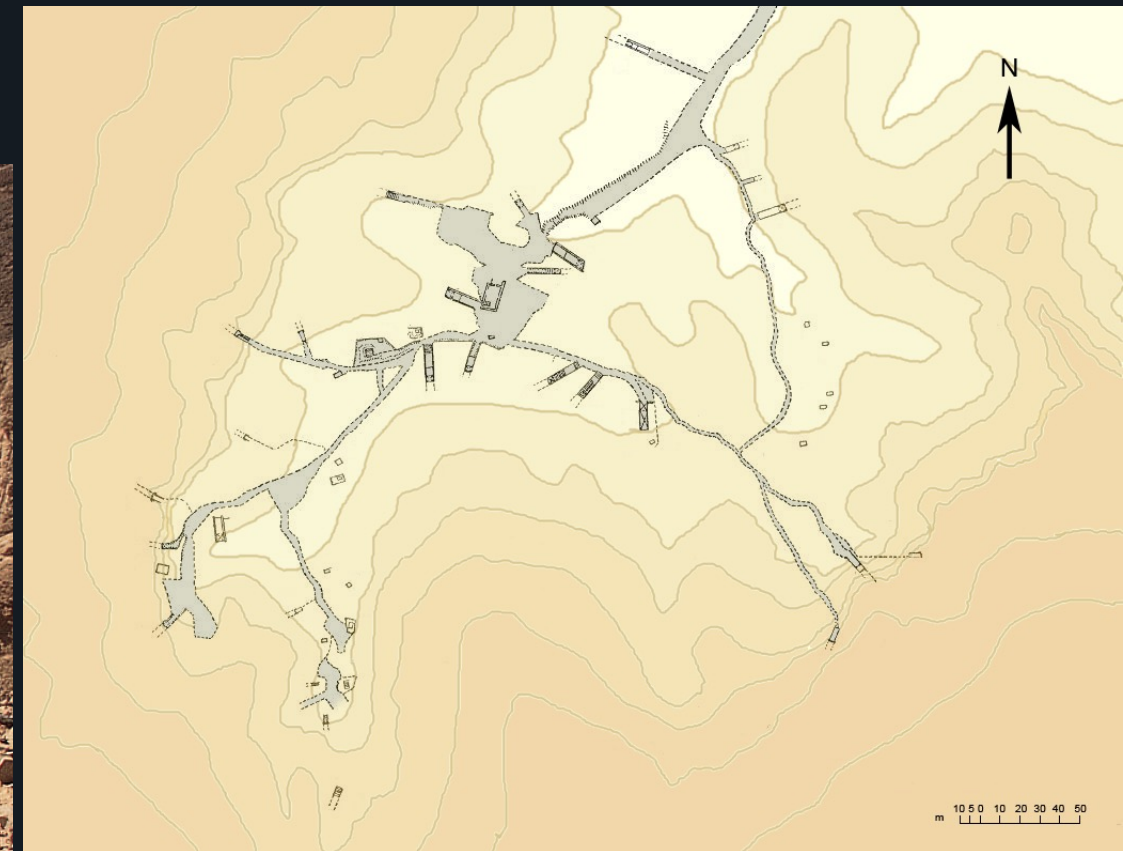

Valley of the Kings, in use from
ca. 16th to 11th century BCE



'Book of the Dead', Papyrus of Ani
ca. 1,250 BCE, from Upper Egypt (Thebes)
London, British Museum

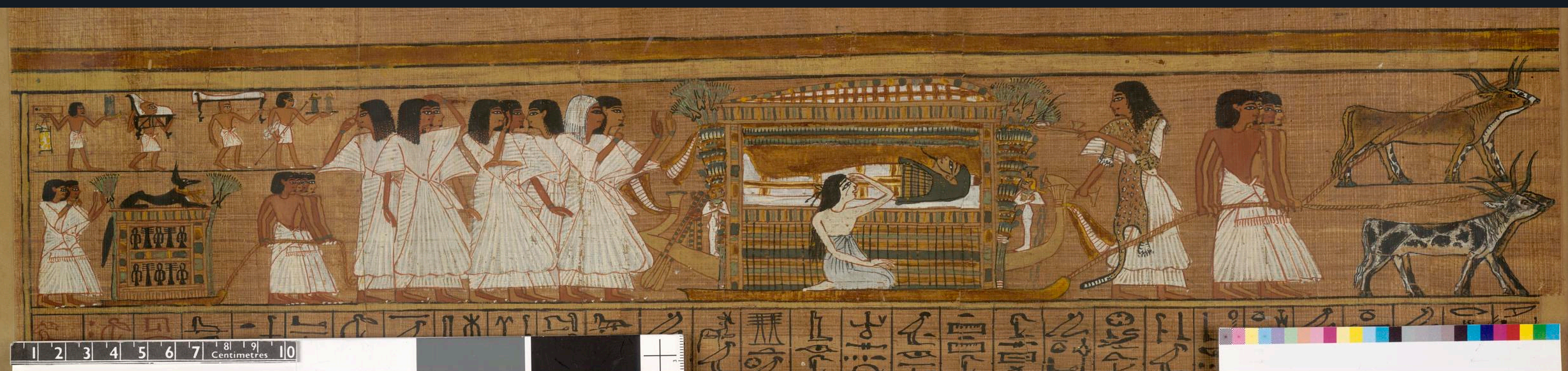

[illegible]



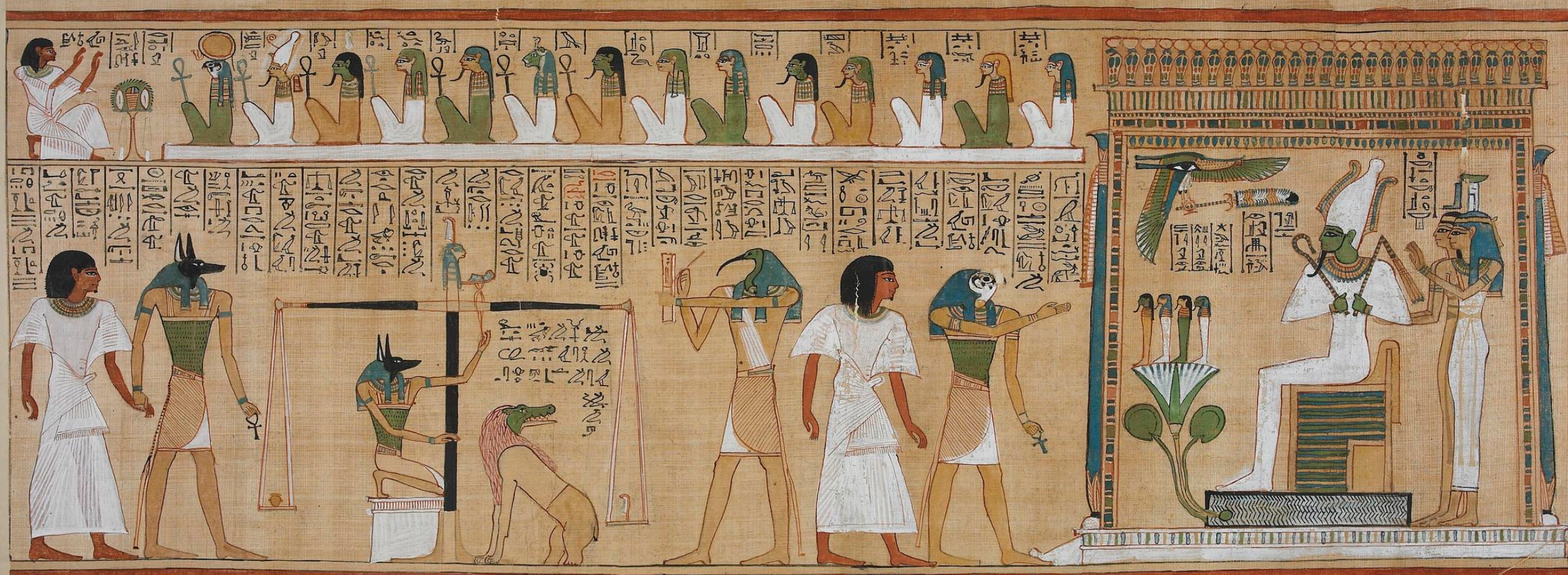

Book of the Dead of Hunefer, royal scribe, ca. 1,310 BCE,
 45.7 x 83.4 cm, Thebes, Egypt
 London, British Museum



Death mask of Pharaoh Tutankhamun, ca. 1,323 BCE,
discovered in 1925 by Howard Carter in the Valley of Kings
Cairo, Egyptian Museum

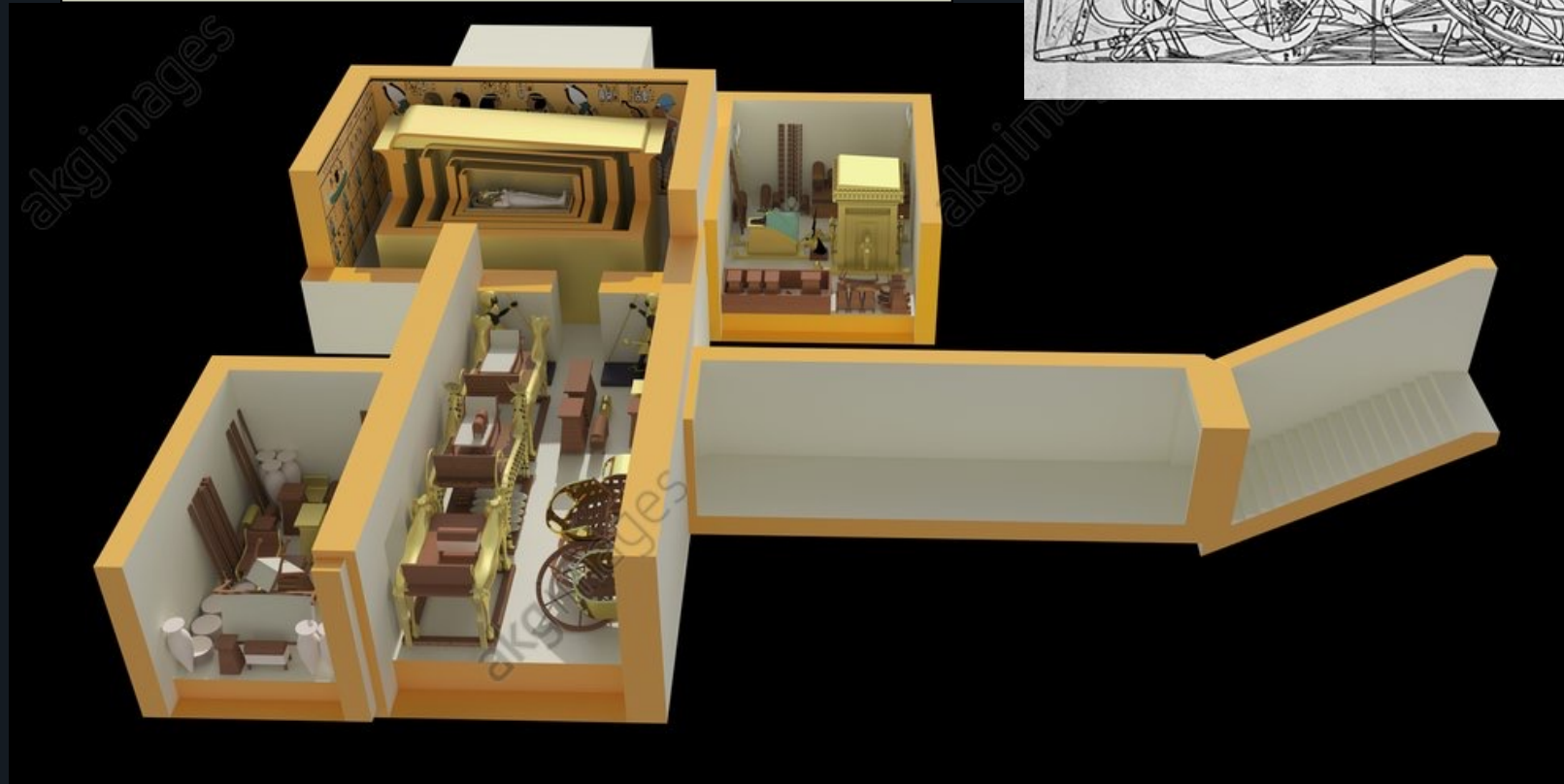
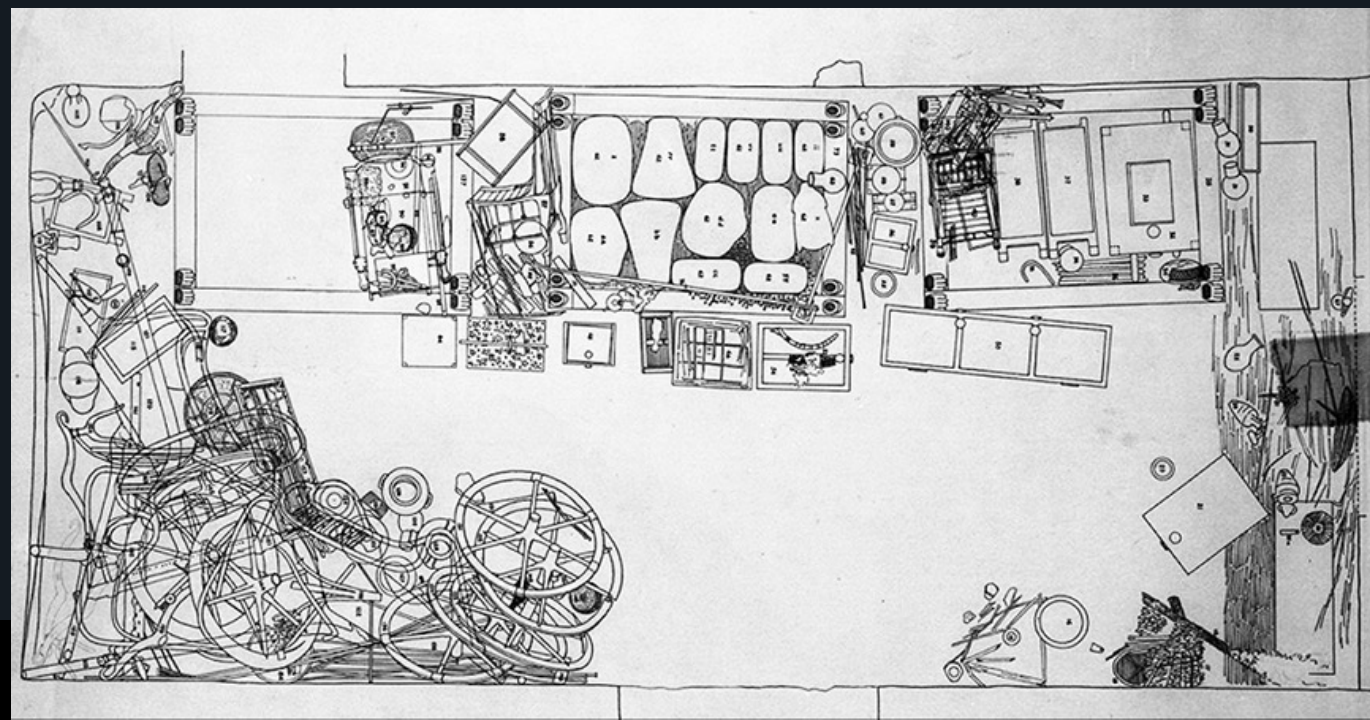
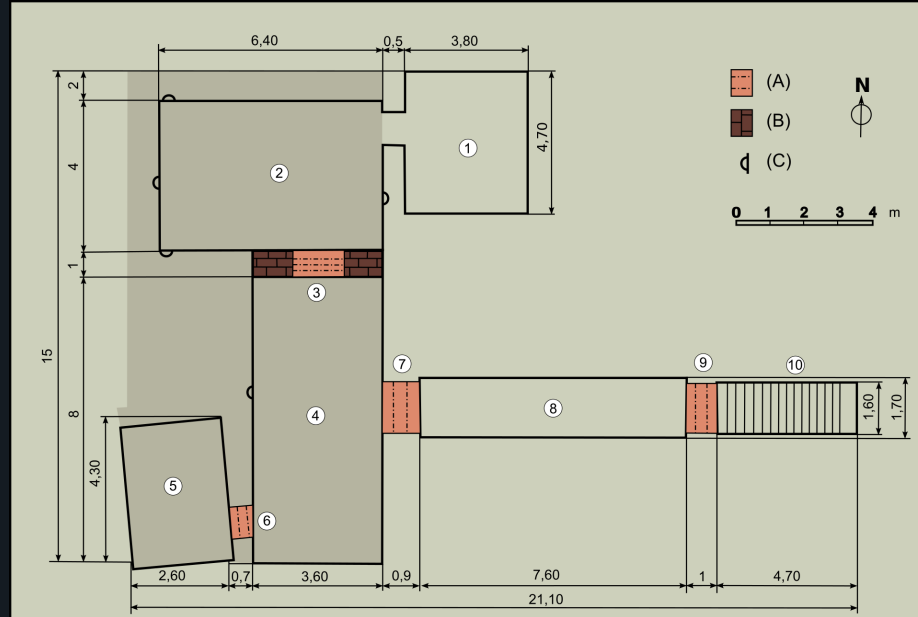

Tomb of Pharaoh Tutankhamun, 3D reconstruction, ca. 1346–1337 BCE

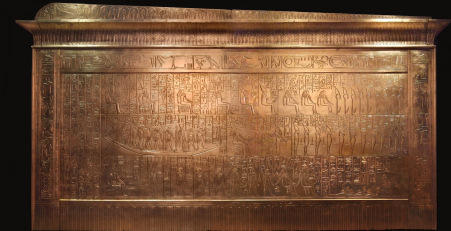

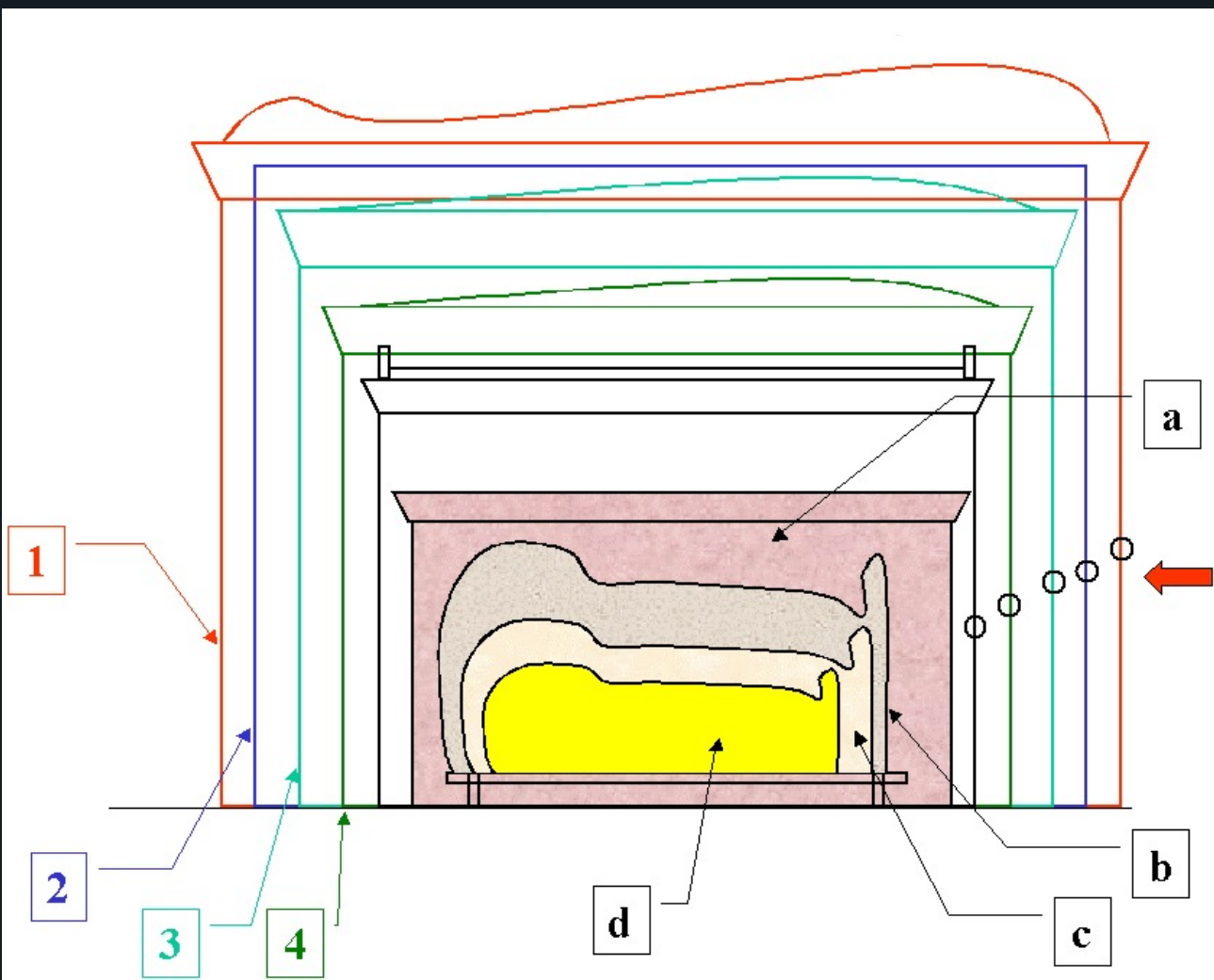





- Fragment of a King's Face (Akhenaten or Thutmose IV?), New Kingdom, from Thebes, ca. 1353–1336 BCE, 13,8 x 11,3 x 4,4 cm
- Fragment of a Queen's Face (Nefertiti or Kiya), New Kingdom, ca. 1353–1336 BCE, yellow jasper, 13 x 12 x 12,5 cm

New York, Metropolitan Museum





Bust of Nefertiti, limestone,
plaster & paint, ca. 1352–
1336 BCE, from Amarna
Berlin, Ägyptisches Museum





House altar representing
Akhenaten, Nefertiti and
their three daughters
under the Aton,
ca.1351–1334 BCE
Berlin, Staatliche
Museen



Head of a princess, from Thutmose workshop,
brown quartzite, ca. 1345 BCE
Berlin, Ägyptisches Museum



Detail with Akhenaten's daughters, Tell el-Amarna, painted plaster
40 x 165 cm, ca. 1345–1335 BCE
Oxford, Ashmolean Museum