

II.1 Ancient Mesopotamia

The Cradle of Civilization



River Valley Civilizations



Danube R.

Black Sea

Mediterranean Sea

NILE
(ANCIENT EGYPT)

Nile R.

Tigris R.

TIGRIS-EUPHRATES
(ANCIENT MESOPOTAMIA AND BABYLONIA)

Persian Gulf

Indus R.

INDUS-GANGES
(HARAPPAN AND VEDIC CIVILIZATIONS)

Arabian Sea

Sutlej R.

Ganges R.

Bay of Bengal

Brabmaputra R.

Yellow R.

Yangtze R.

YELLOW RIVER
(SHANG)

West R.

South China Sea

East China Sea

PACIFIC OCEAN

Lake Baikal

Lake Balkhasb

1200 MILES

1200 KILOMETERS





	SUMERIAN (Vertical)	SUMERIAN (Rotated)	EARLY BABYLONIAN	LATE BABYLONIAN	ASSYRIAN
star	✳	✳	✳	𐎗	𐎗
sun	◊	◊	◊	𐎗	𐎗
month	◊ ◊	◊ ◊	◊ ◊	𐎗 𐎗	𐎗 𐎗
man	𐎗	𐎗	𐎗	𐎗	𐎗
king	𐎗	𐎗	𐎗	𐎗	𐎗
son	𐎗	𐎗	𐎗	𐎗	𐎗
head	𐎗	𐎗	𐎗	𐎗	𐎗
lord	𐎗	𐎗	𐎗	𐎗	𐎗
his	𐎗	𐎗	𐎗	𐎗	𐎗
reed	𐎗	𐎗	𐎗	𐎗	𐎗
power	𐎗	𐎗	𐎗	𐎗	𐎗
mouth	𐎗	𐎗	𐎗	𐎗	𐎗
ox	𐎗	𐎗	𐎗	𐎗	𐎗
bird	𐎗	𐎗	𐎗	𐎗	𐎗
destiny	𐎗	𐎗	𐎗	𐎗	𐎗
fish	𐎗	𐎗	𐎗	𐎗	𐎗
gardener	𐎗	𐎗	𐎗	𐎗	𐎗
habitation	𐎗	𐎗	𐎗	𐎗	𐎗
Nineveh	𐎗	𐎗	𐎗	𐎗	𐎗
night	𐎗	𐎗	𐎗	𐎗	𐎗









2







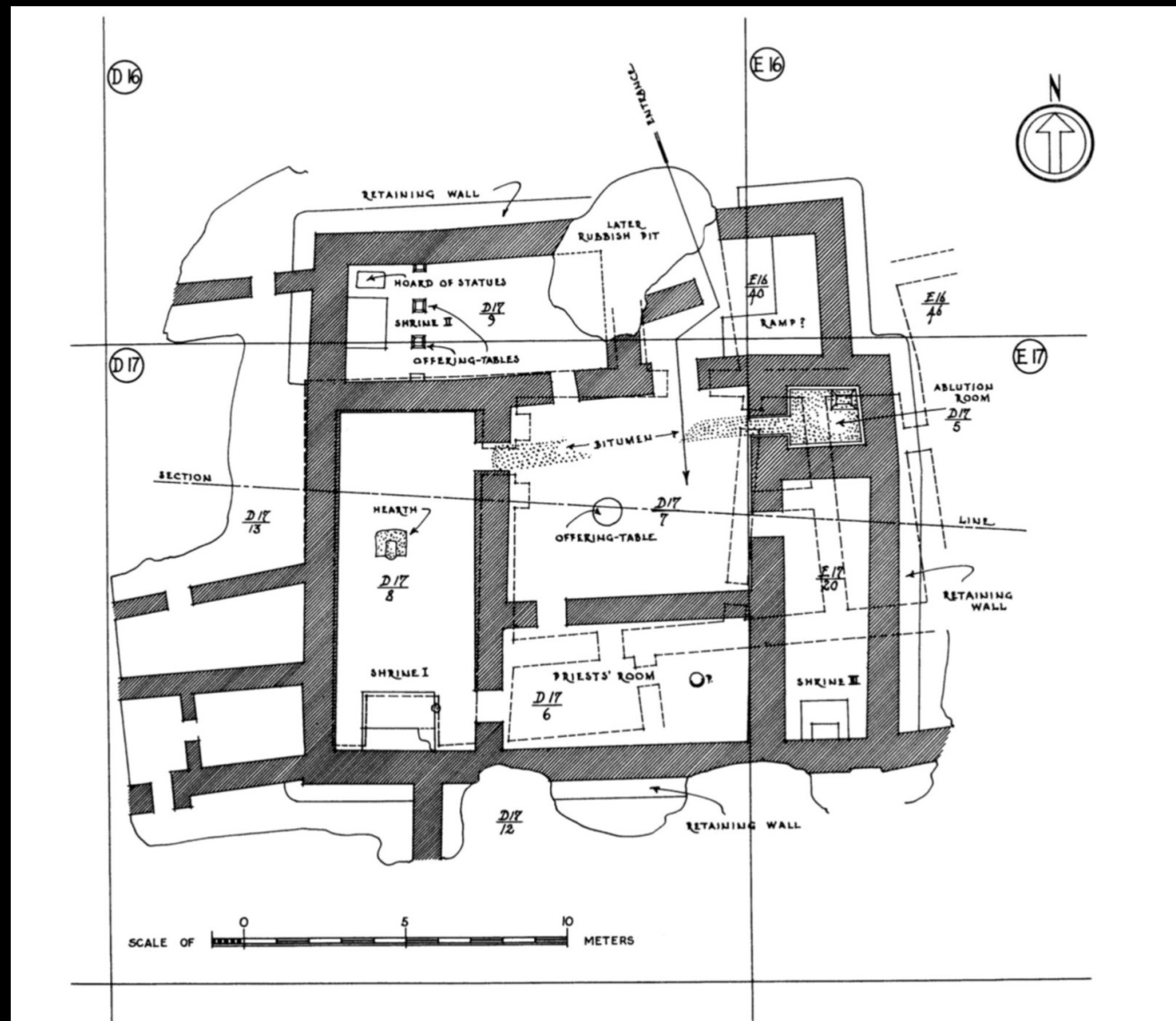

Fig. 5. Plan of the Square Temple at Tell Asmar, with the predecessor to the Square Temple indicated in broken lines (Delou-gaz and Lloyd 1942, pl. 22; courtesy the Oriental Institute of the University of Chicago).









“To Amurru, his god, for the life of Hammurabi, king of Babylon, and for his own life, Lu-Nanna, [(title)], son of Sîn-le’i, fashioned a copper statuette (in the attitude) of a suppliant, the face gold-plated, and dedicated it to him to (represent) his servant.”





Prospectus Turris Babylonica ex Praescripto R. Adm. Patris Athanasij Kircheri Soc. Jesu.
TURRIS BABEL.



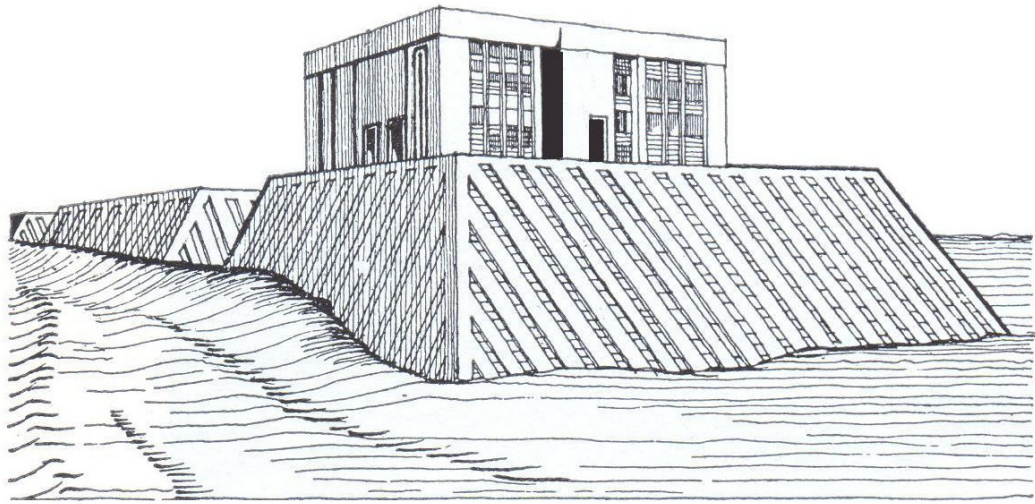

THE WHITE TEMPLE & ZIGGURAT,
AT WARKA ARCHAIC PERIOD B.C. 3500-3000

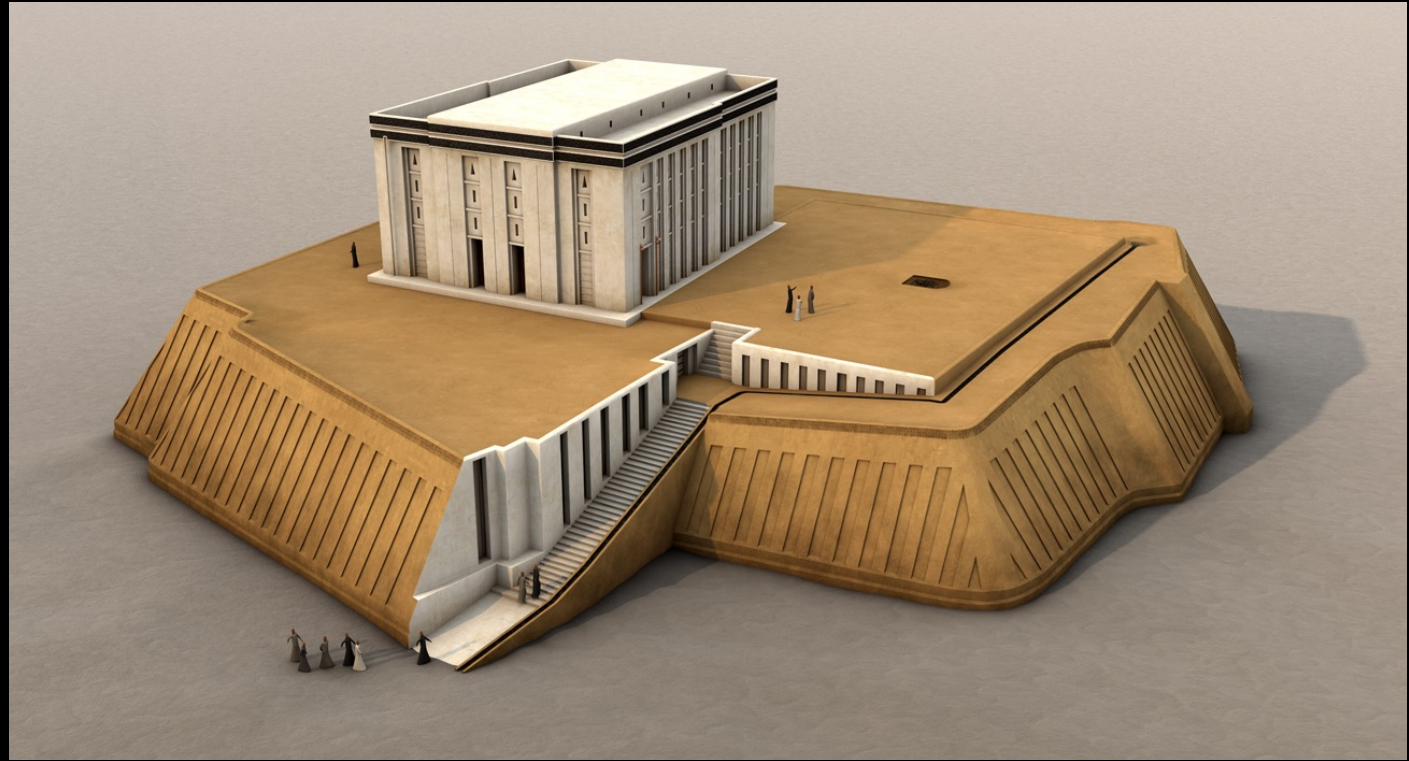







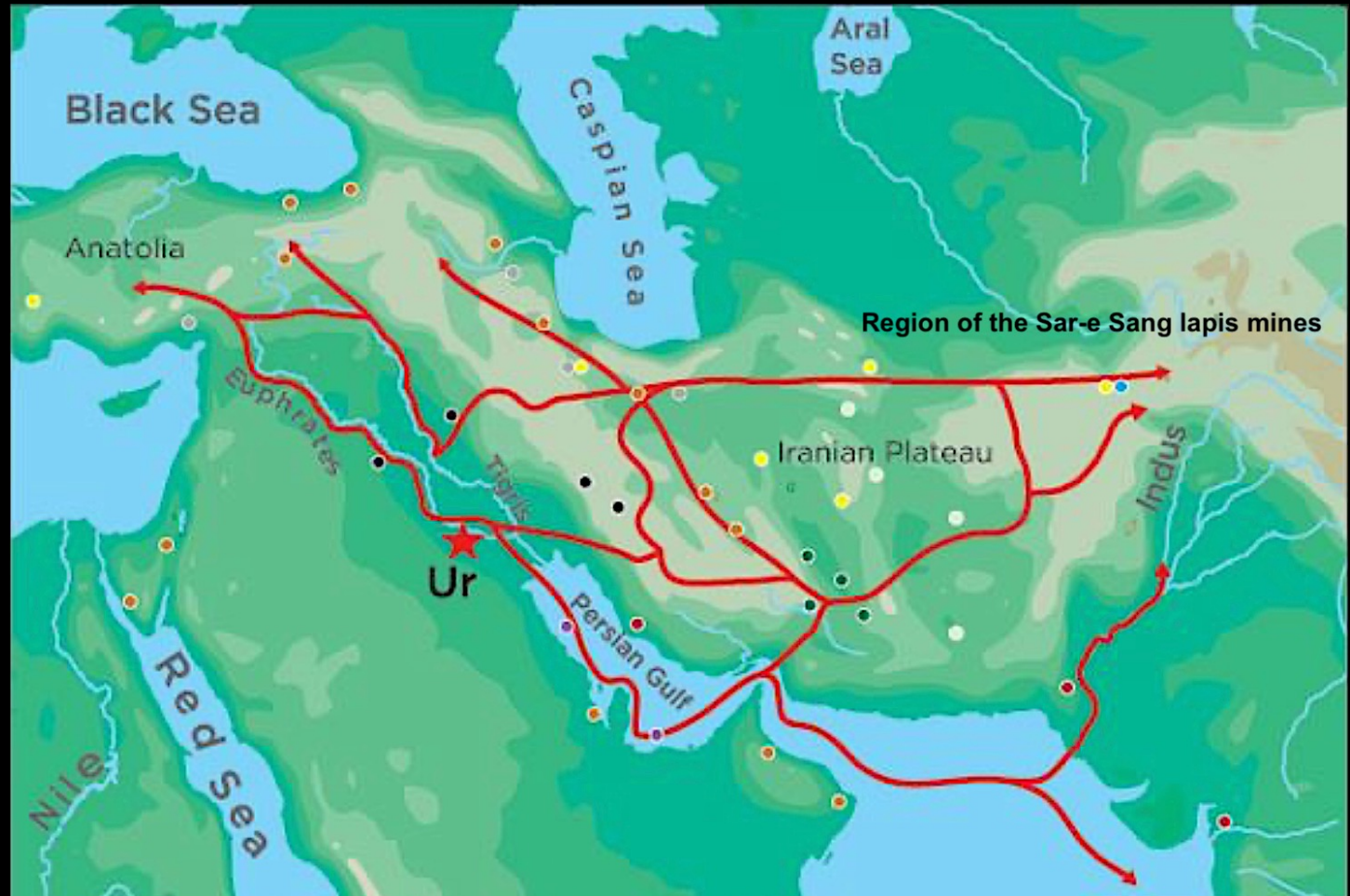
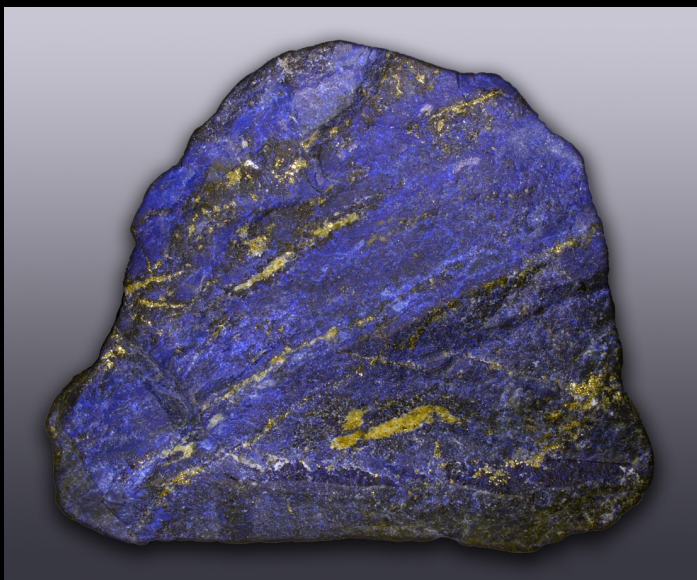



“dul, Ebih-il, nu-banda, Ištar Nita, sarig”

“This statue, Ebih-il, the overseer, to Ishtar (?), he dedicated.”































